

INTERVENTO DI RESTAURO DELLE MURA DI CINTA E DEI CORPI DI FABBRICA INTEREDI CON RICOSTRUZIONE DEI CAMMINAMENTI DI RONDA, CON DESTINAZIONE A PERCORSO DI DOCUMENTAZIONE STORICO CULTURALE DELL'ARCHITETTURA MEDIEVALE



COMUNE DI GRADARA (PU)

COMMITTENTE: AMMINISTRAZIONE COMUNALE

Progettazione Studio Tecnico
dott. Arch. ROMANO PELLEI
Sforzacosta - Macerata - via B. Tano 48
tel./fax. 0733201207 - email: ropellei@tin.it

Calcoli strutturali:
Dott. Ing. Diego Damen
63815 Monte San Pietrangeli

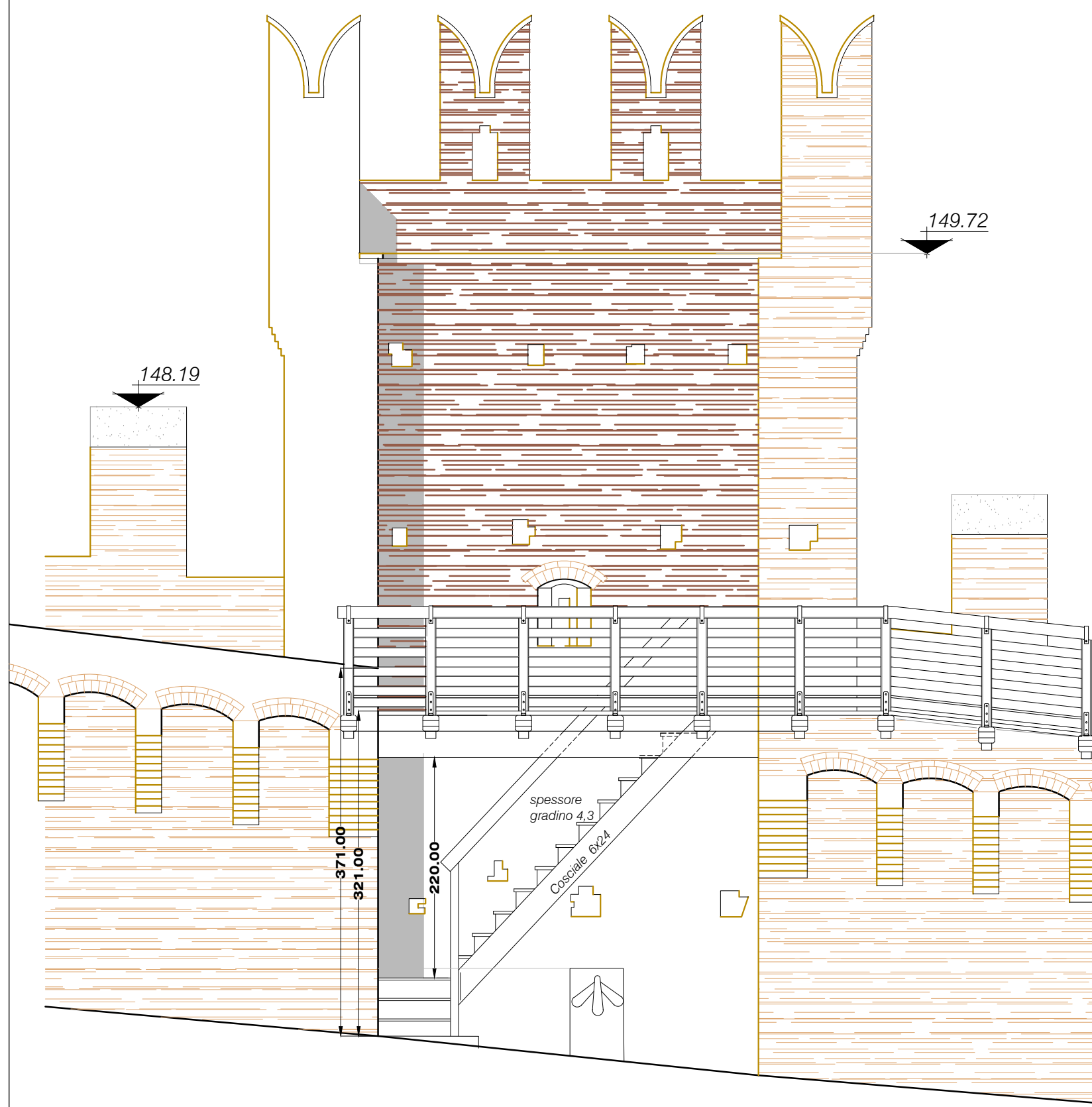
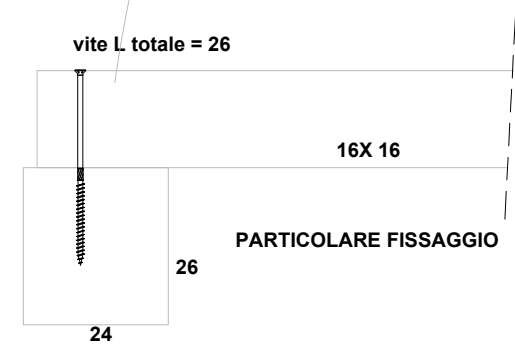
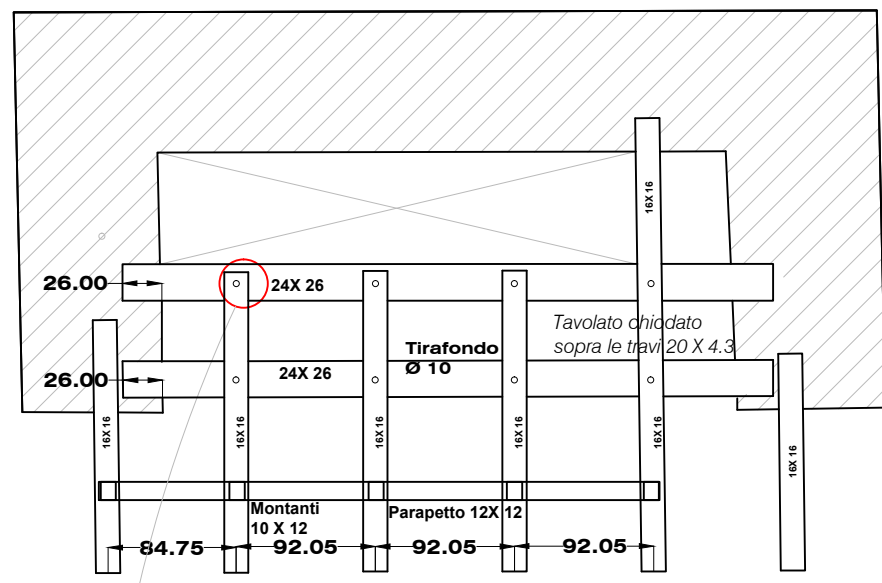
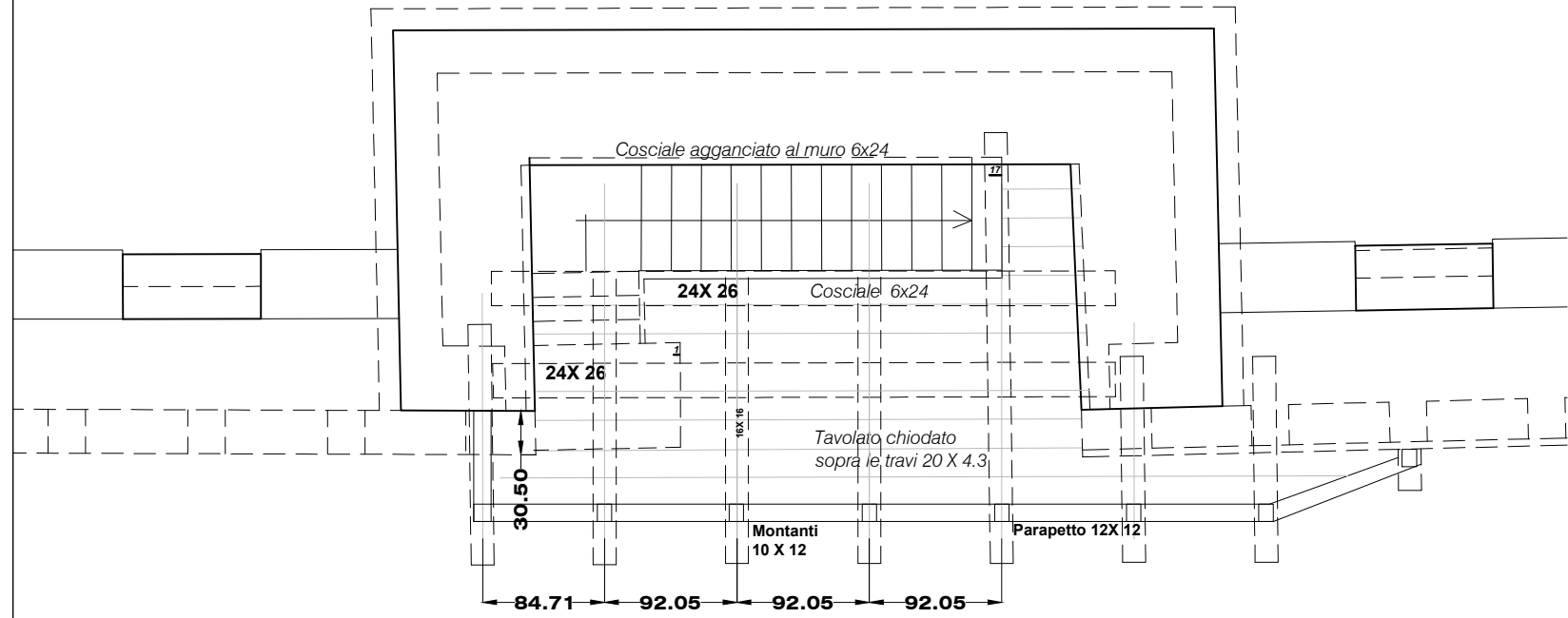

TORRE DI ACCESSO AI CAMMINAMENTI CON TORNELLO

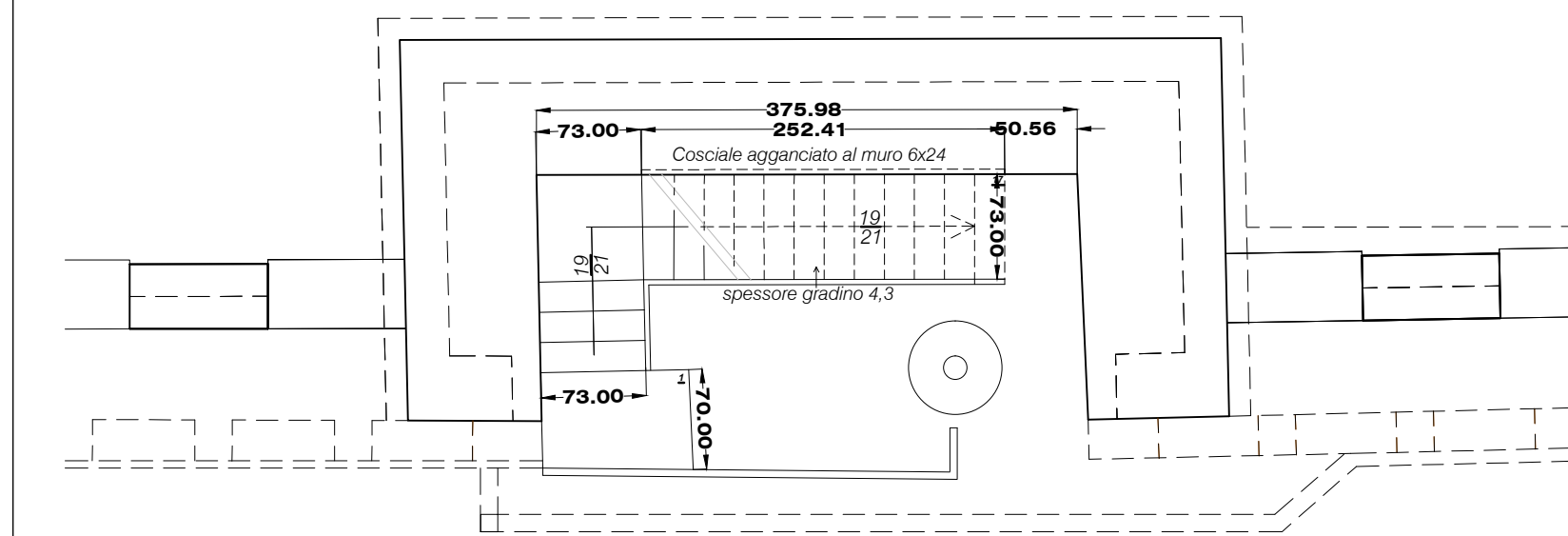

TORRE 5 EST

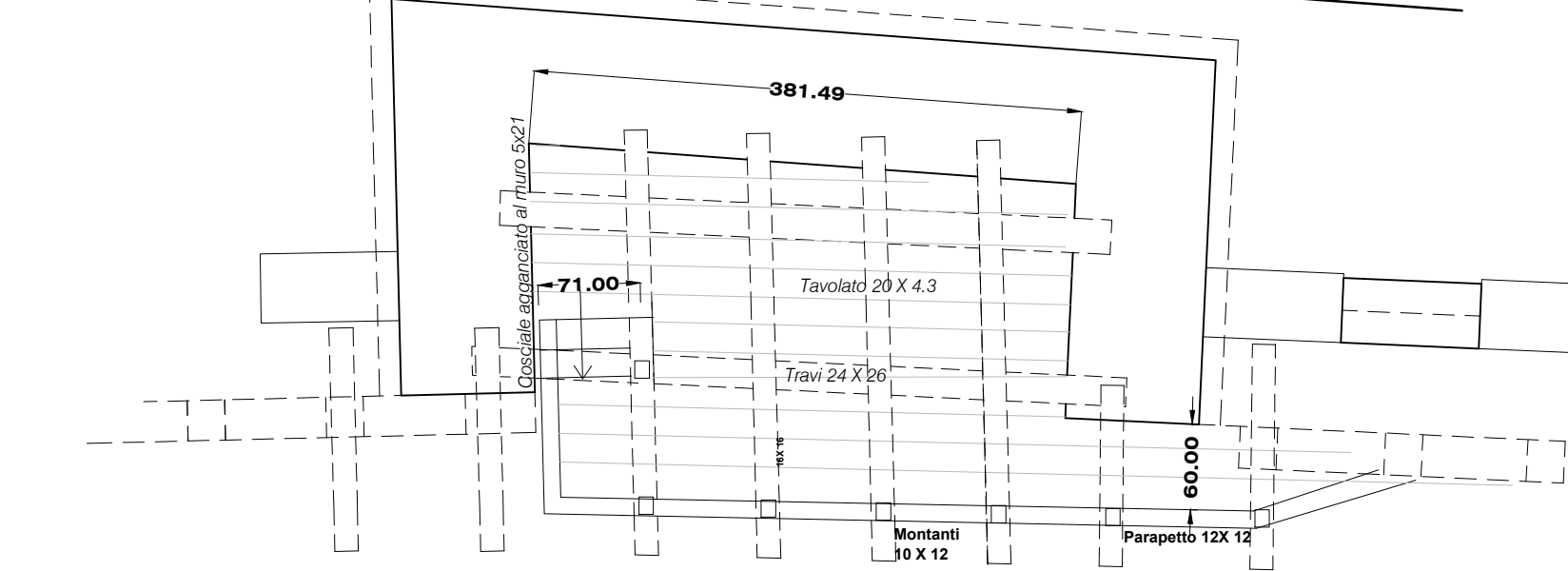
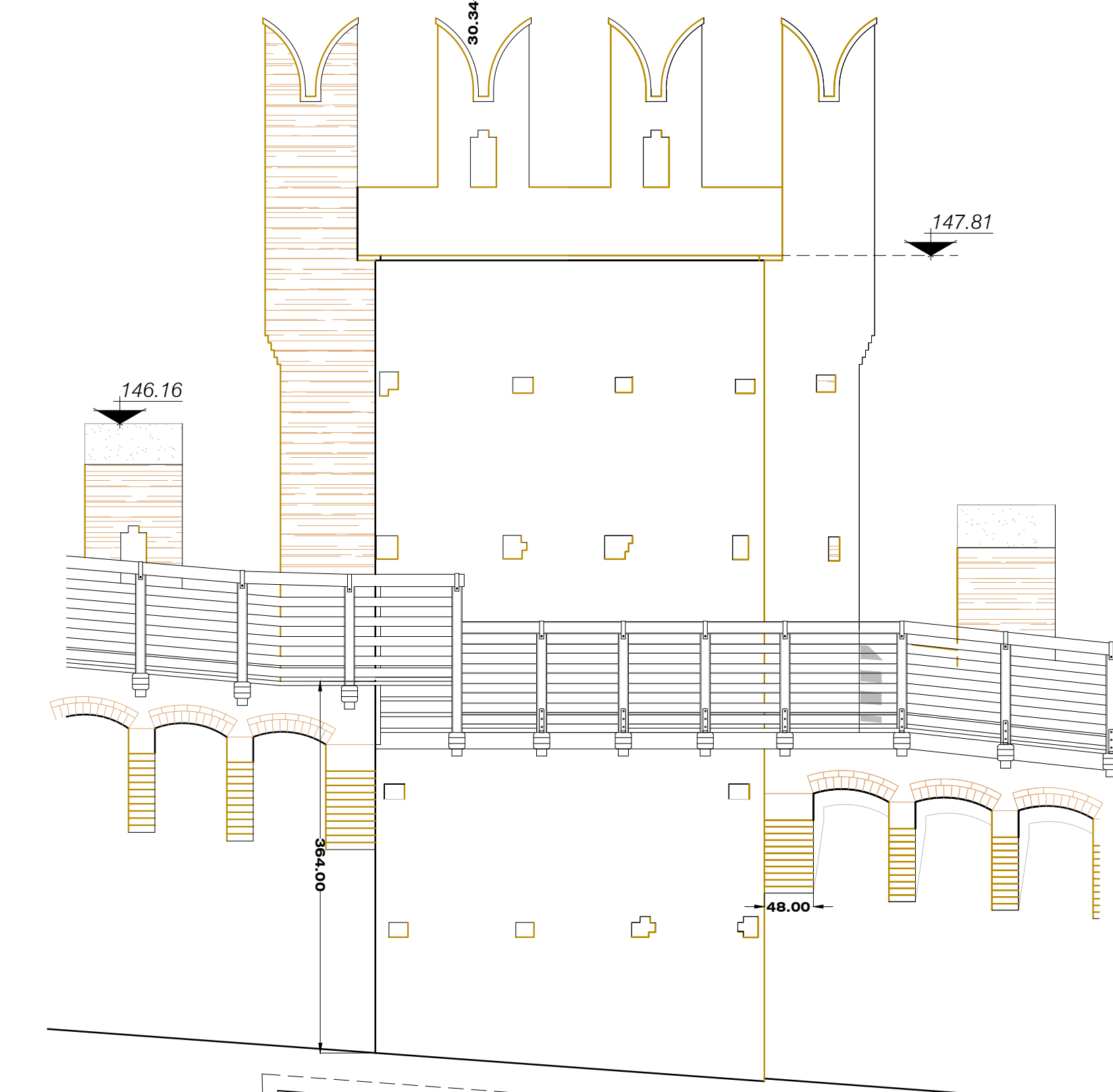
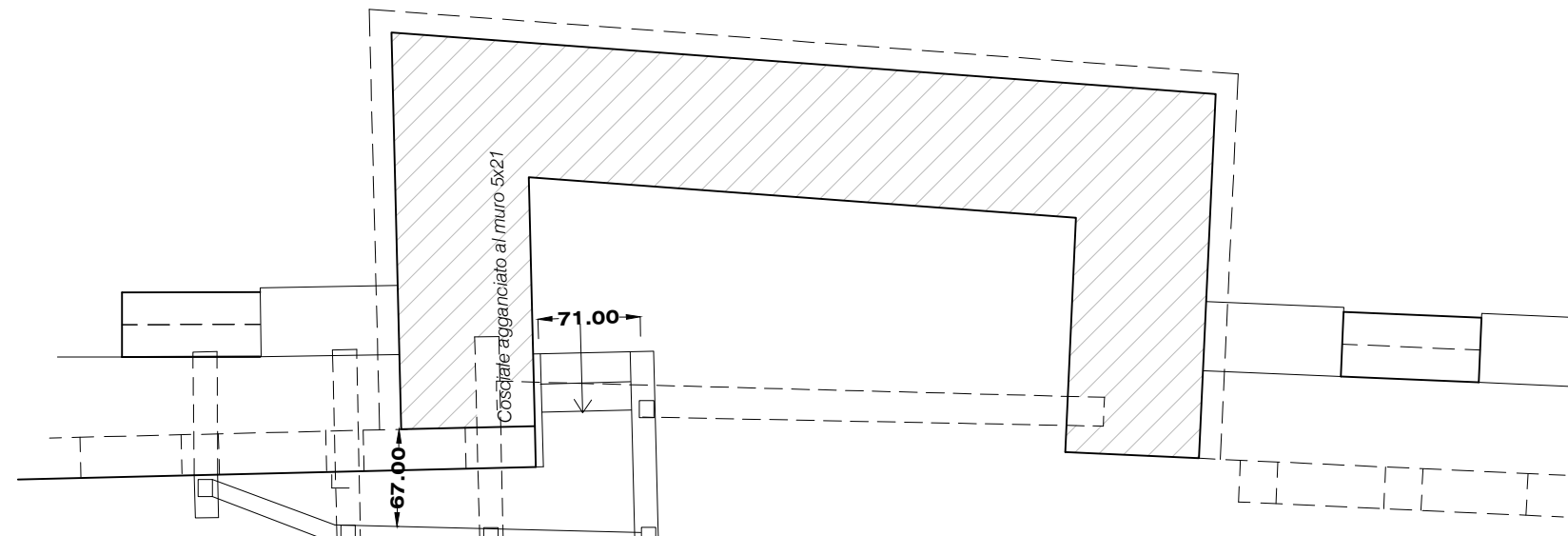

CINTA MURARIA EST OPERE STRUTTURALI SOLAI E SCALE IN LEGNO CON ACCESSO AI CAMMINAMENTI

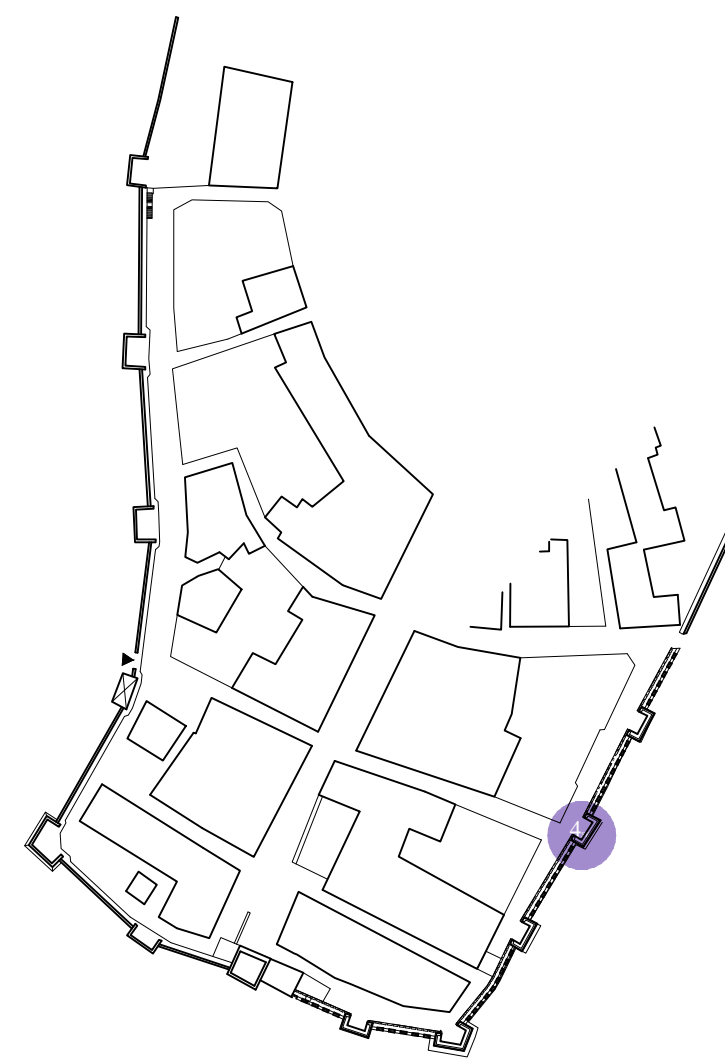
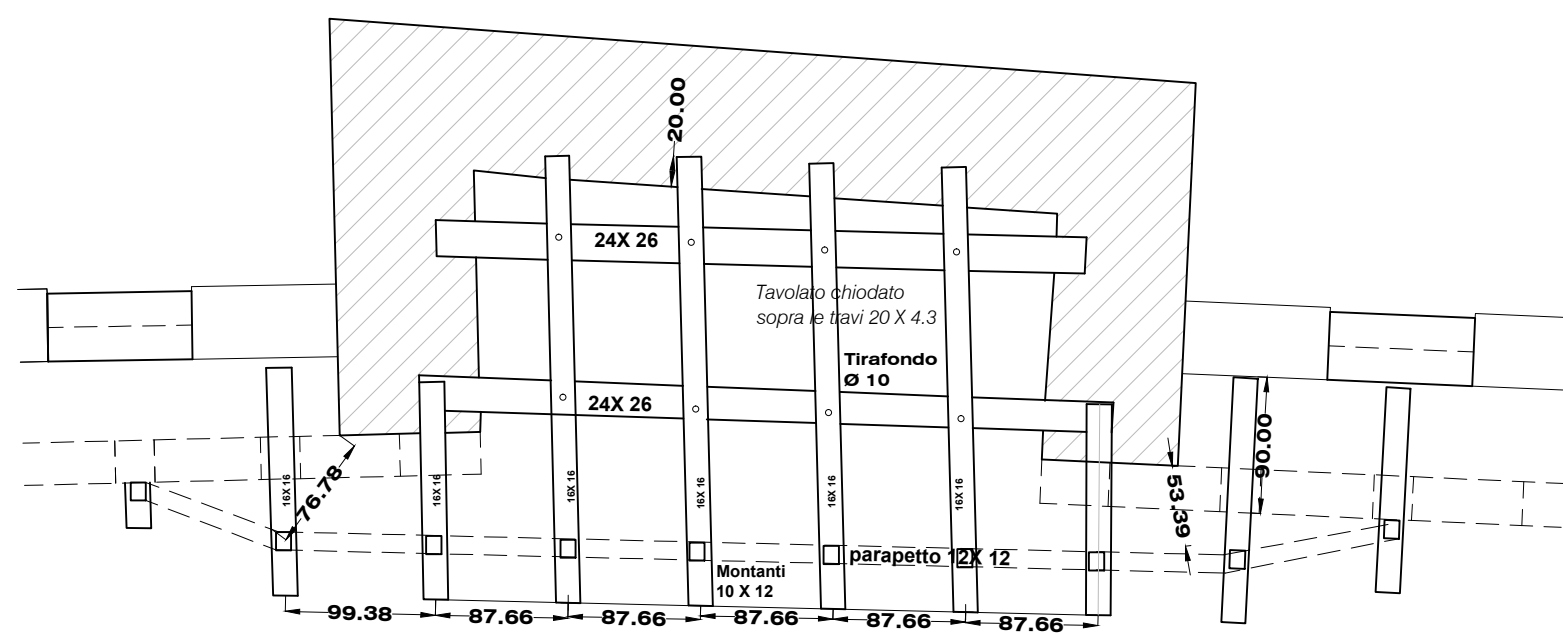

TORRE 4 EST

