

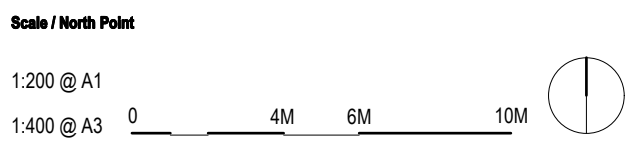

General Note
Do not scale from drawing. Use marked dimensions.
To be read in conjunction with all other Consultant's drawings.
The Architect to be immediately notified of any discrepancies.
Copyright on this drawing retained by the Architect.

NOTE:
- Refer to Landscape Architects and Civil Engineers' details for external levels
- All existing dimensions and levels to be checked on site
- Refer to UCM drawing AB-A-G200-P-00a for Ancillary Building
Detailed floor plan for internal and external wall types; internal and external floor types; section lines and detail references.

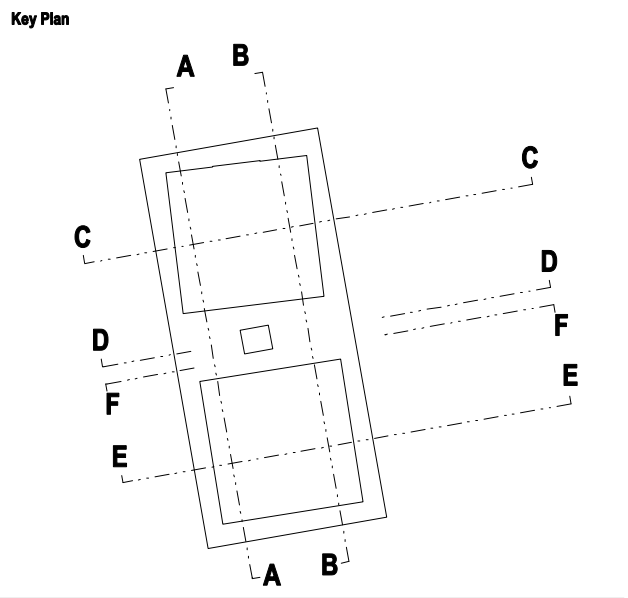

Rev	Date	Own	Chk	App	Revision or reason for issue
-	10.12.13	EN	AD	AD	Press Information Release

**DENTON
CORKER
MARSHALL**

Architect
Denton Corker Marshall LLP
Exmouth House 3-11 Pine Street London EC1R 0JH
Telephone +44 (0)20 7833 2020 Facsimile +44 (0)20 7833 9320
Email mail@dentoncorkermarshall.co.uk

Project Title
**STONEHENGE ENVIRONMENTAL
IMPROVEMENTS PROJECT**

Client
English Heritage
1 Waterhouse Square 138-142 Holborn London EC1N 2ST
Telephone +44 (0)20 7973 3000 Facsimile +44(0)20 7973 3001

Drawing Title
**VISITOR CENTRE
GROUND FLOOR PLAN**

Project Number
6398
Drawing Status
PRESS

Drawing Number
VC-A-G200-P-00
Revision
-