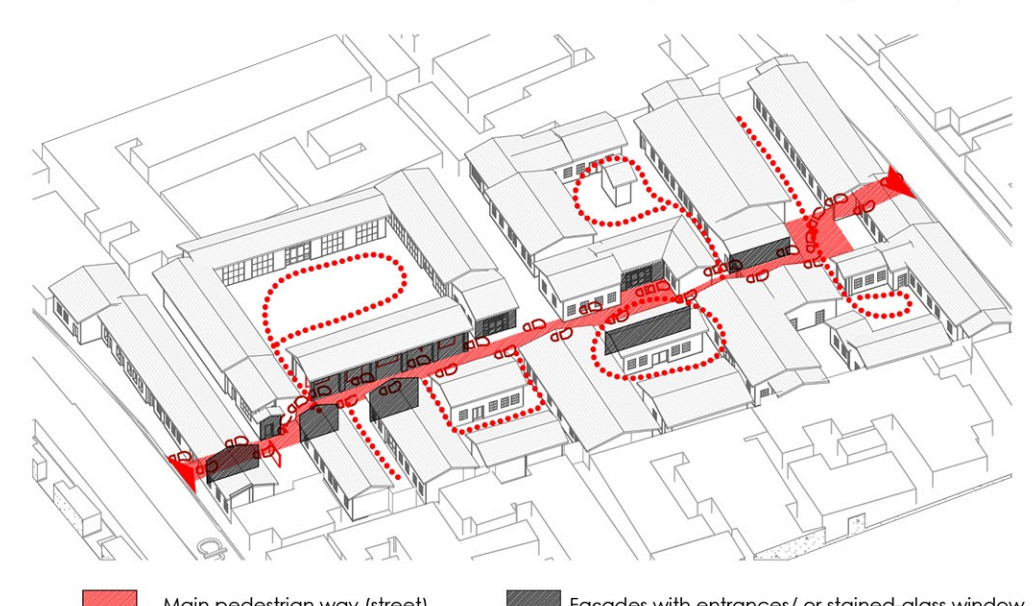

Diagram of functional scheme

Diagram of courtyards' system

Diagram of courtyards' system

General diagram of external area
Diagram of green area



ART_INCUBATOR

The general idea that this art-space will be a sort of "educational&entertaining district", where every citizen and tourist find their understanding of the historical and cultural identity.

Proposed "art-incubator" becomes a mental intangible door to our past and a place of collective memory. All of these features will help in the development of the China self-identity.

Proposal view on main courtyard of performance area





Proposal view on courtyard of residence area



Proposal view on interior of dance hall



Proposal view on interior of workshop area



Proposal view on block with internal space