

Object	Titán Plaza, Bogotá
Clients	Cusezar, Bogotá and Ospinas, Bogotá
Architect	Tamayo + Montilla Arquitectos, Bogotá
General contractor for membrane and foil	Castro Rojas
Structural Designer for membrane and foil roof	formTL, www.form-TL.de
Photos	Castro Rojas
Drawings	formTL



Colorful sky inside the new shopping center
Photos: TITAN-InteriorIlluminado.JPG; TITAN-InteriorIlluminadoAzul.JPG



By day the roof of the main dome affords views of the outside
Photos: TITAN-Interior-deDia2.JPG; TITAN-Interior-deDia.JPG

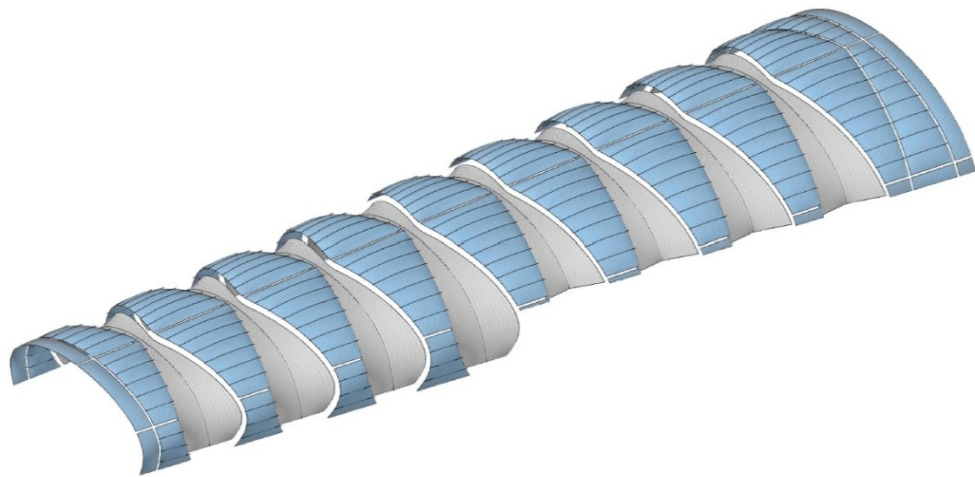

Attractive structure comprising rows of ETFE cushions and mechanically tensioned membrane – the main roof of the Titan Plaza
Drawing: 01_maindome.jpg



Photo: TITAN-P1020630.JPG

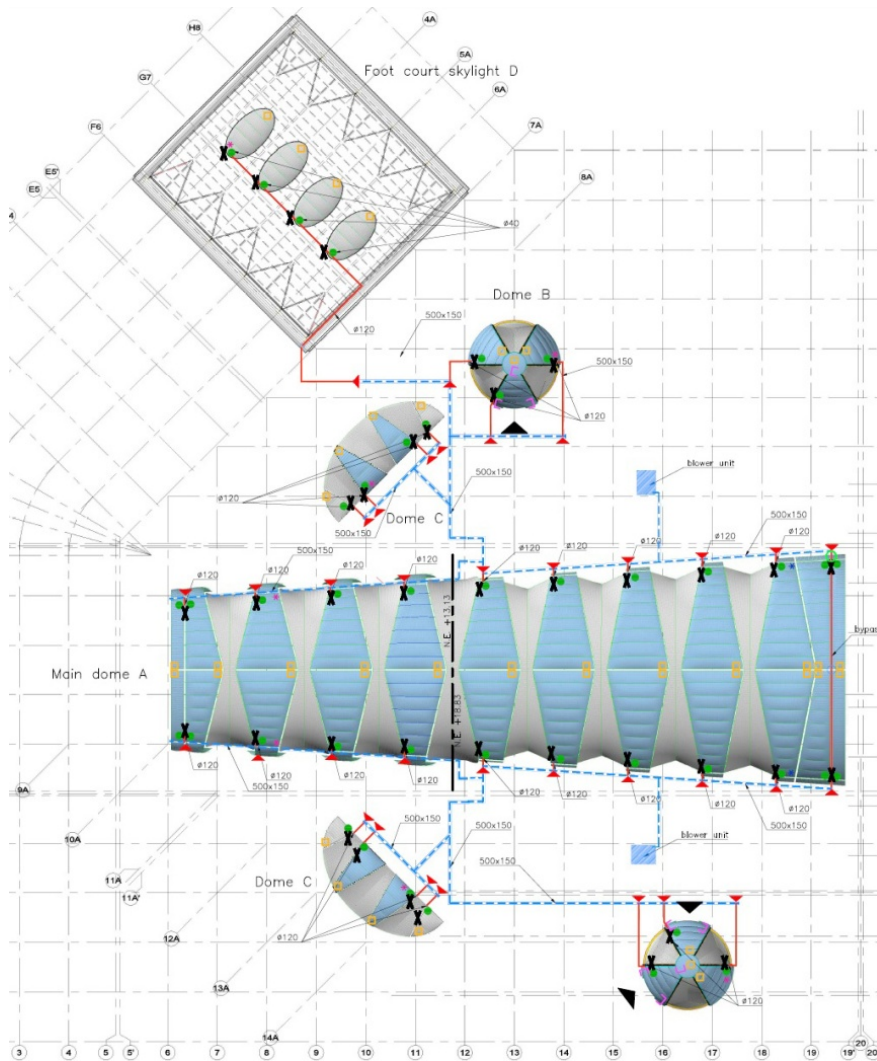

Layout plan of shopping center including air supply
 Drawing: 05_luftversorgung.jpg

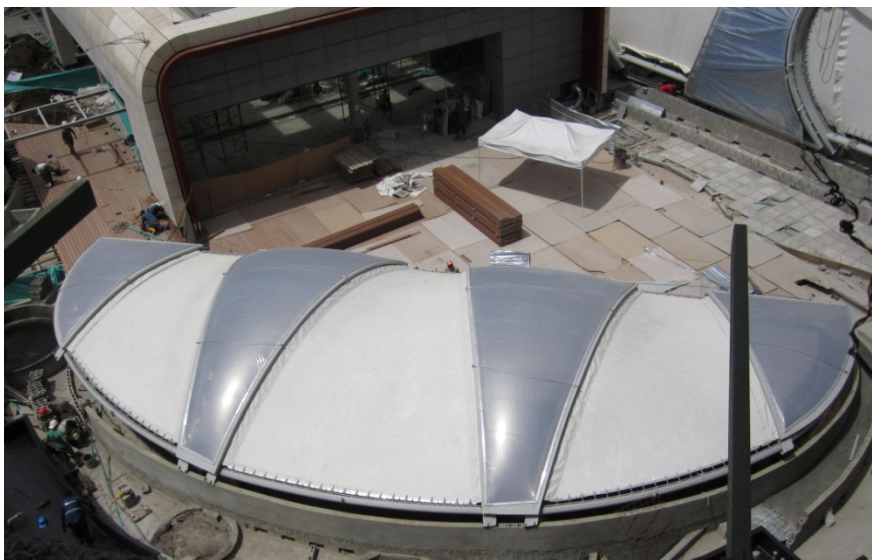

One of the varied roof shapes: a crescent-shaped roof
 Photo: TITAN-IMG_0934.jpg

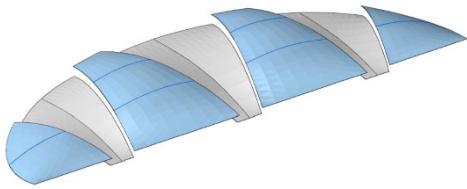

Drawing of the crescent-shaped roof
Drawing: 03_dshapeddome.jpg

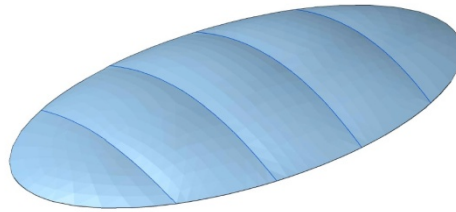

Oval roof consisting of ETFE cushions
Drawing: 04_elliptical.jpg

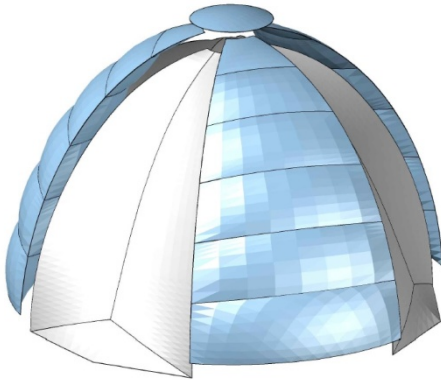

Roof with a circular layout
Drawing + photo: 02_spericaldome.jpg; TITAN-DomoAscensor.JPG



Photos of assembly



Photo: TITAN-DSC02126.JPG



Photo: TITAN-DSC03137.JPG

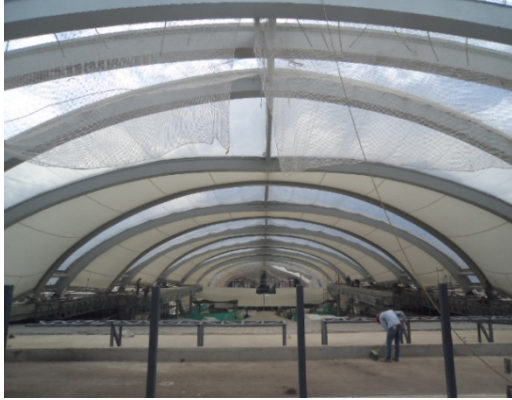

Photo: TITAN-DSC03126.JPG



Photo: TITAN-DSC03122



Photo: TITAN-DSC03382.JPG



Photo: TITAN-DSC03405.JPG



Photo: TITAN-DSC03185.JPG



Photo: TITAN-DSC03184.JPG



Photo: TITAN-DSC03388.JPG

Images and text are available for download as a zip file at:
http://download.proesler.com/formtl_titan_plaza_bogota_en.zip

Please mention the photo credit **Castro Rojas** and **formTL**.

Reprint permitted – please provide Proesler Kommunikation with sample copy