

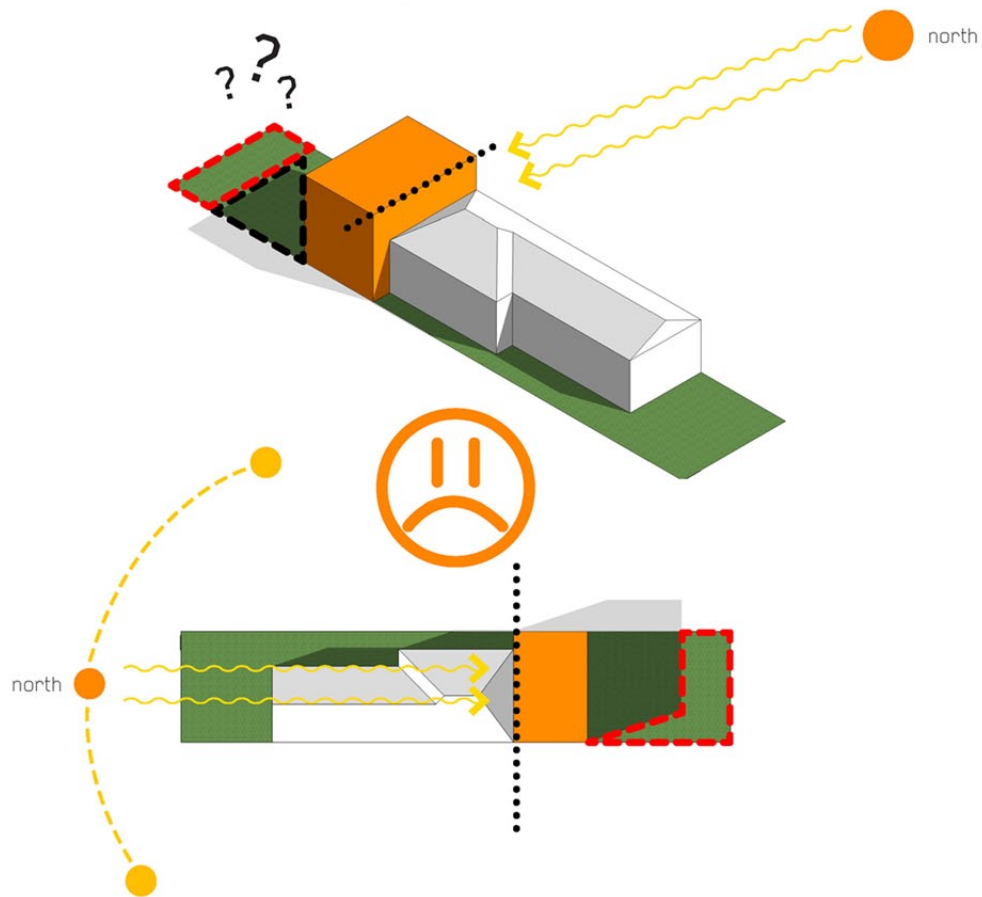

If the extension is attached to the existing part of the house

- the backyard will be overshadowed, as the two storey building will block the solar access from the north and the extension will obviously be orientated towards south.



If the extension is be separated from the extension

- enclosed courtyard will be created, and the existing hinged roof is great to provide northern solar access to this outdoor space, and the extension will also have a great thermal energy.

VS

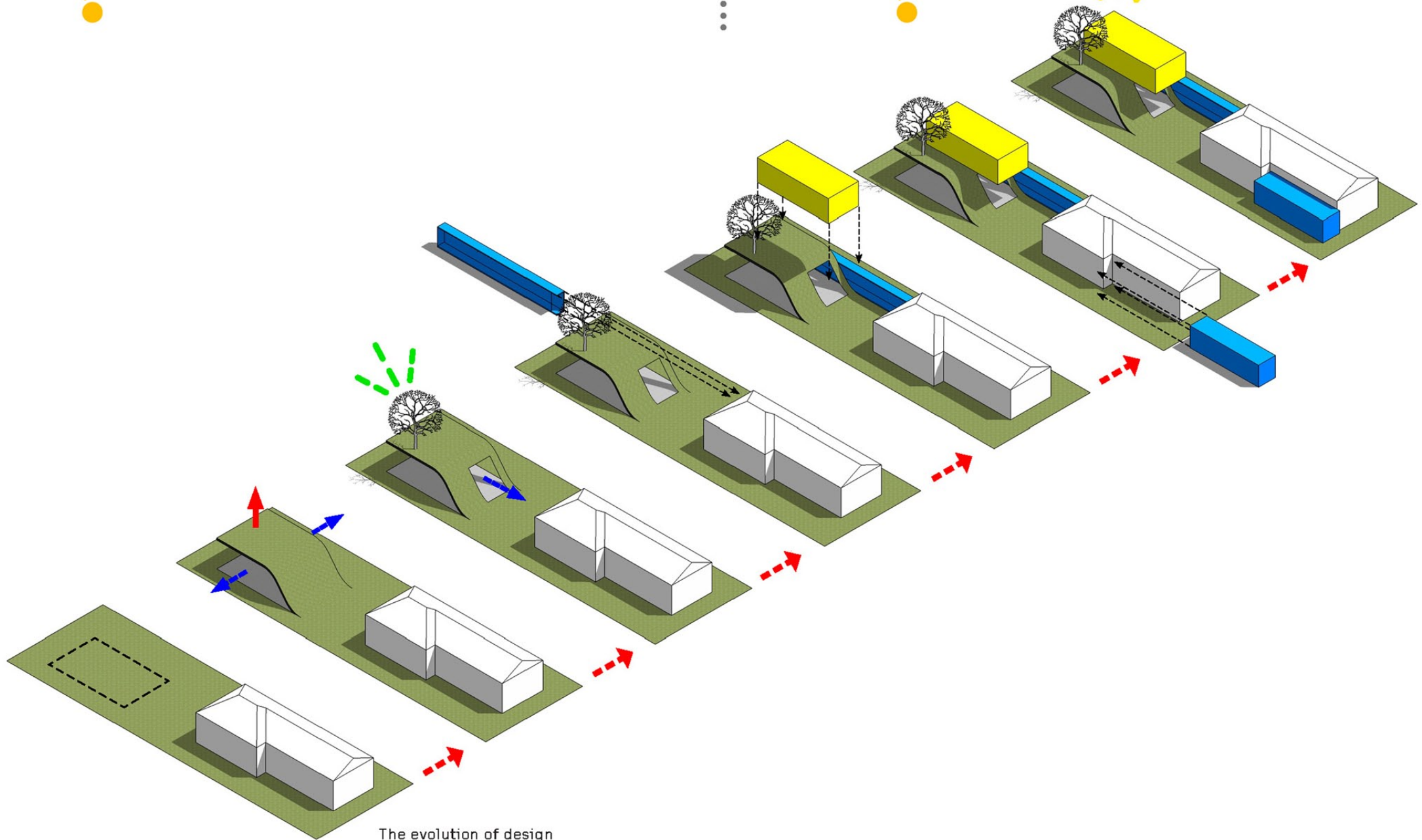
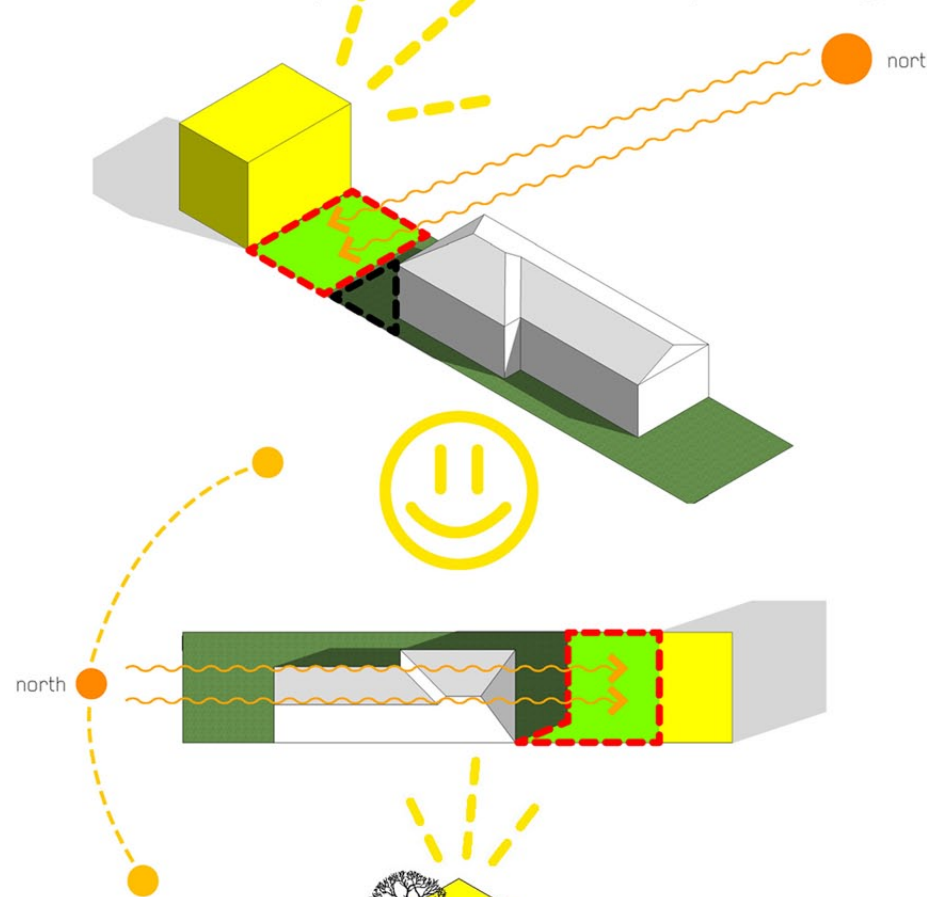

The evolution of design

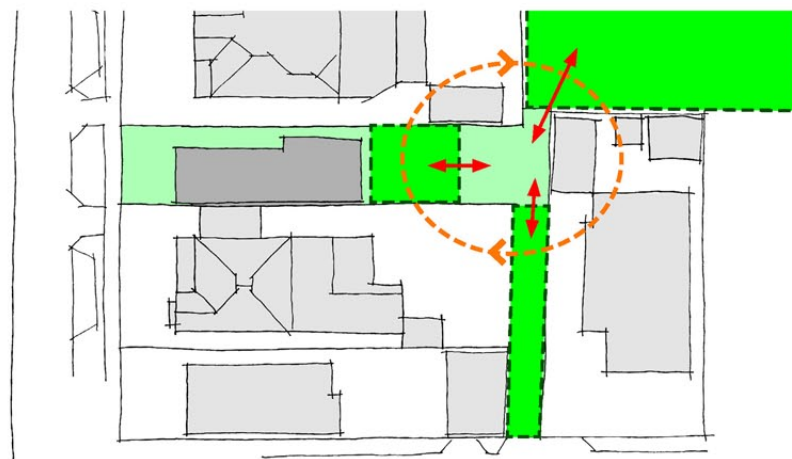
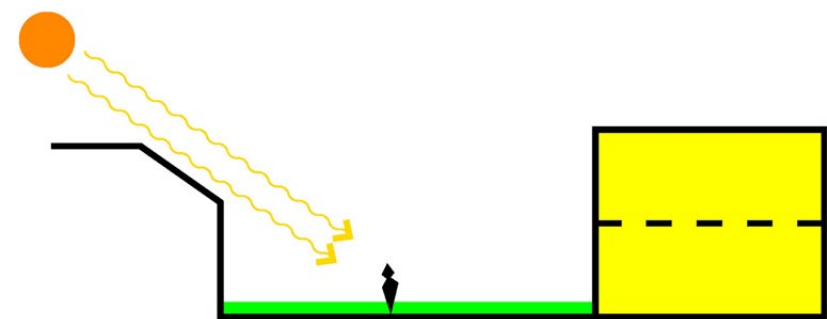
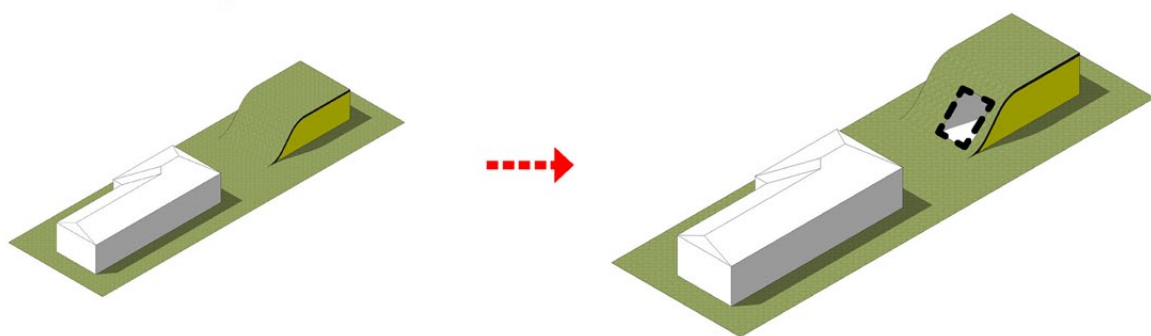
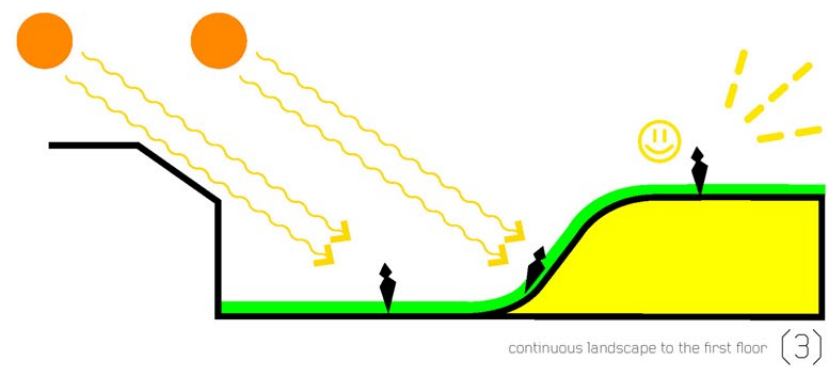
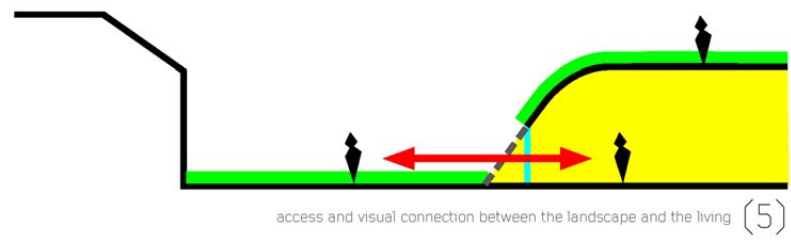
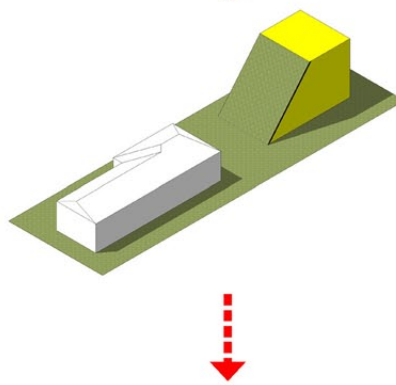
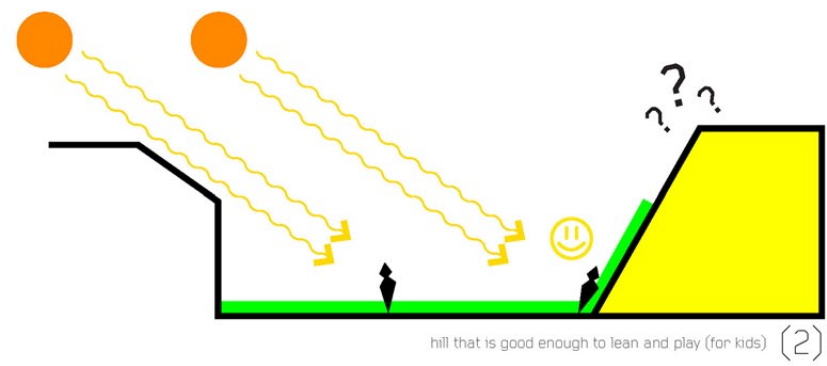
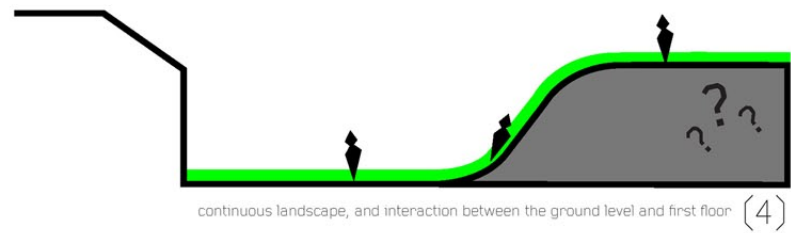
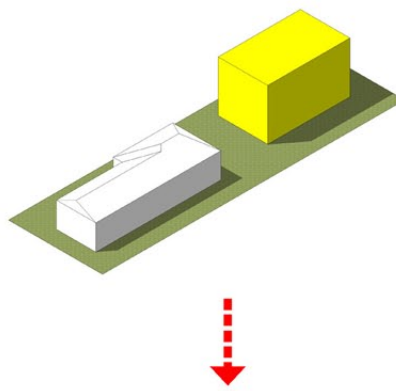
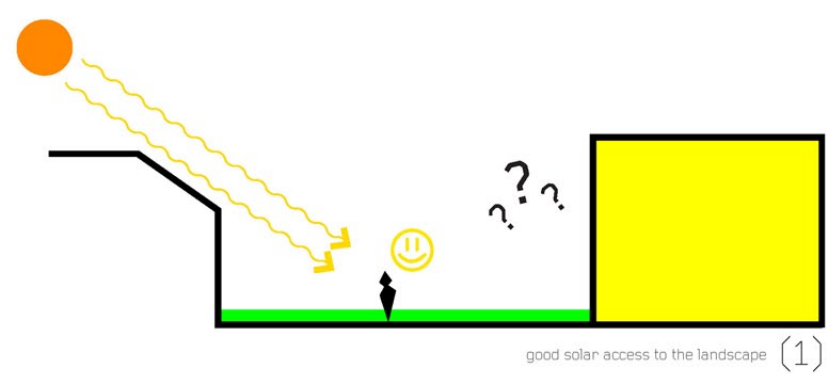

Living space surrounded by greeneries
 - also has good access on ground level from all directions.

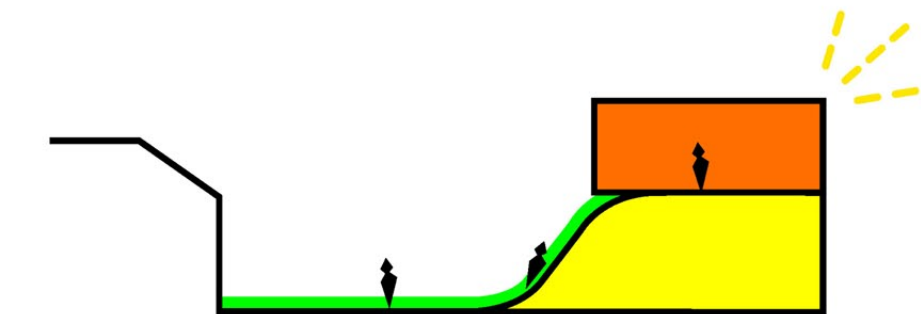
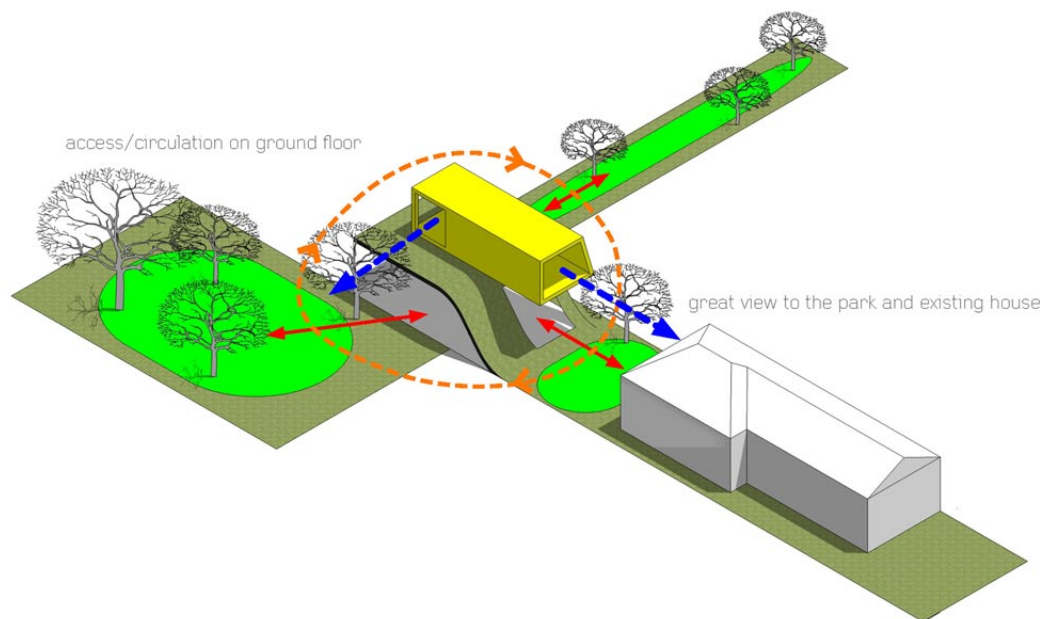
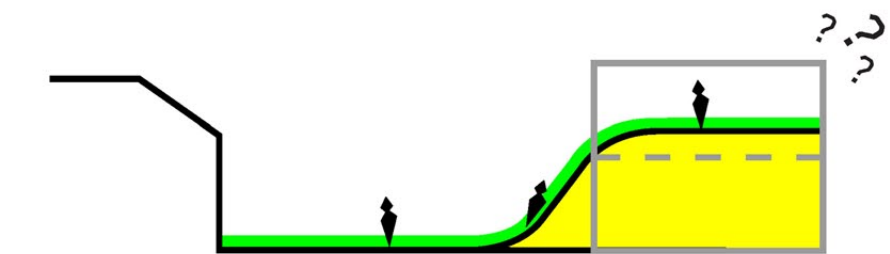

designstrategy

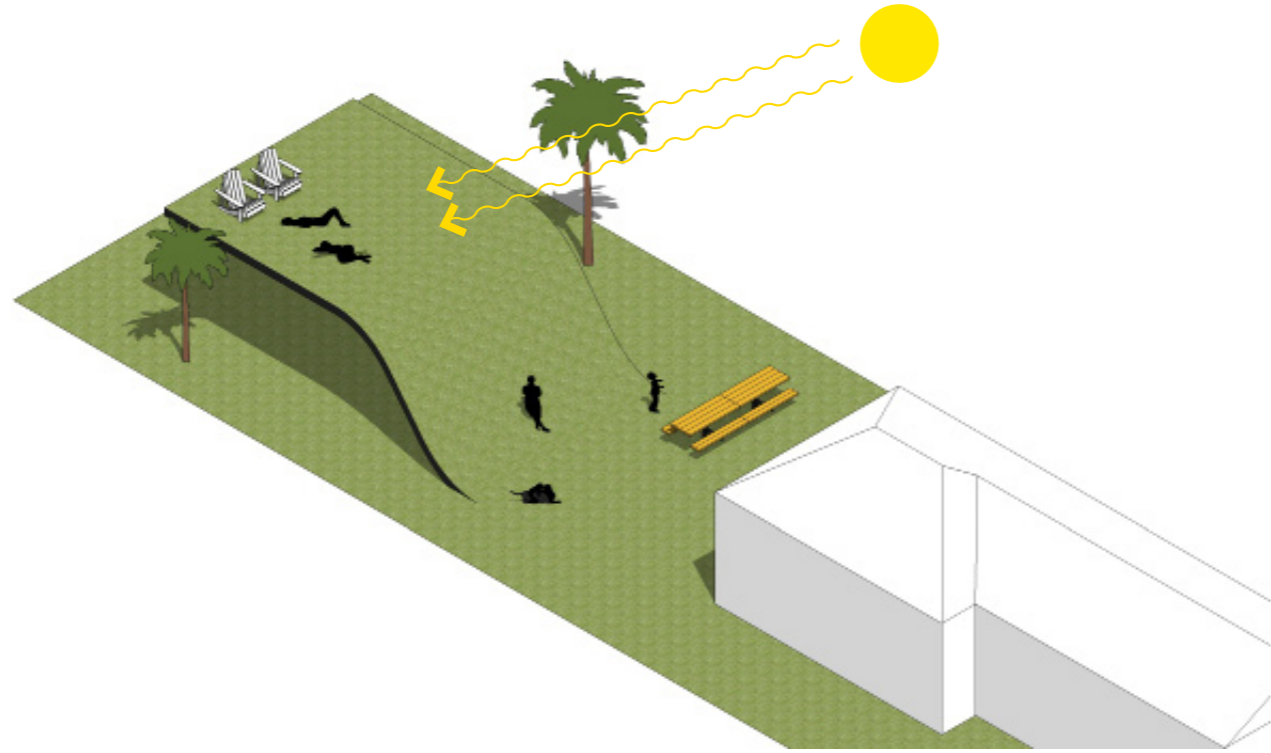

outdoor space with great solar access

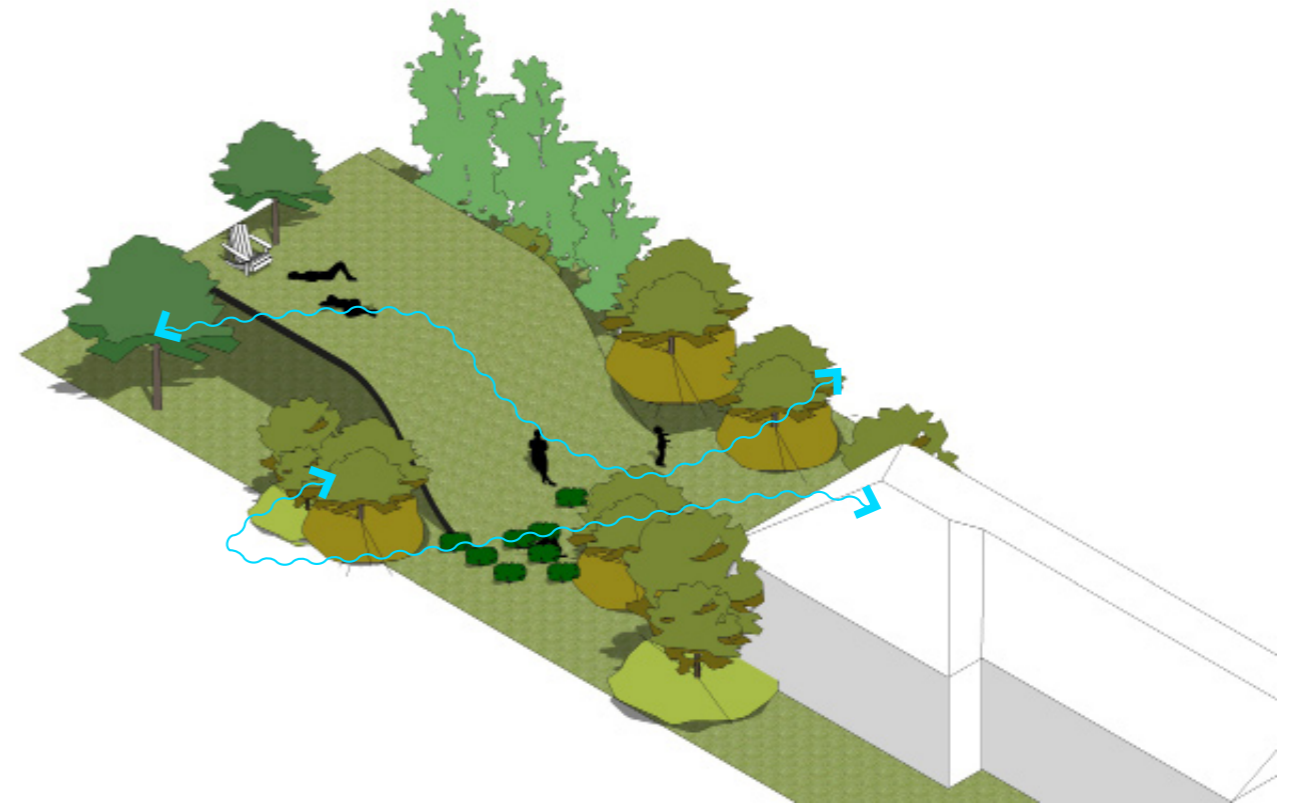

landscape with lots of vegetation, providing shades and good ventilation

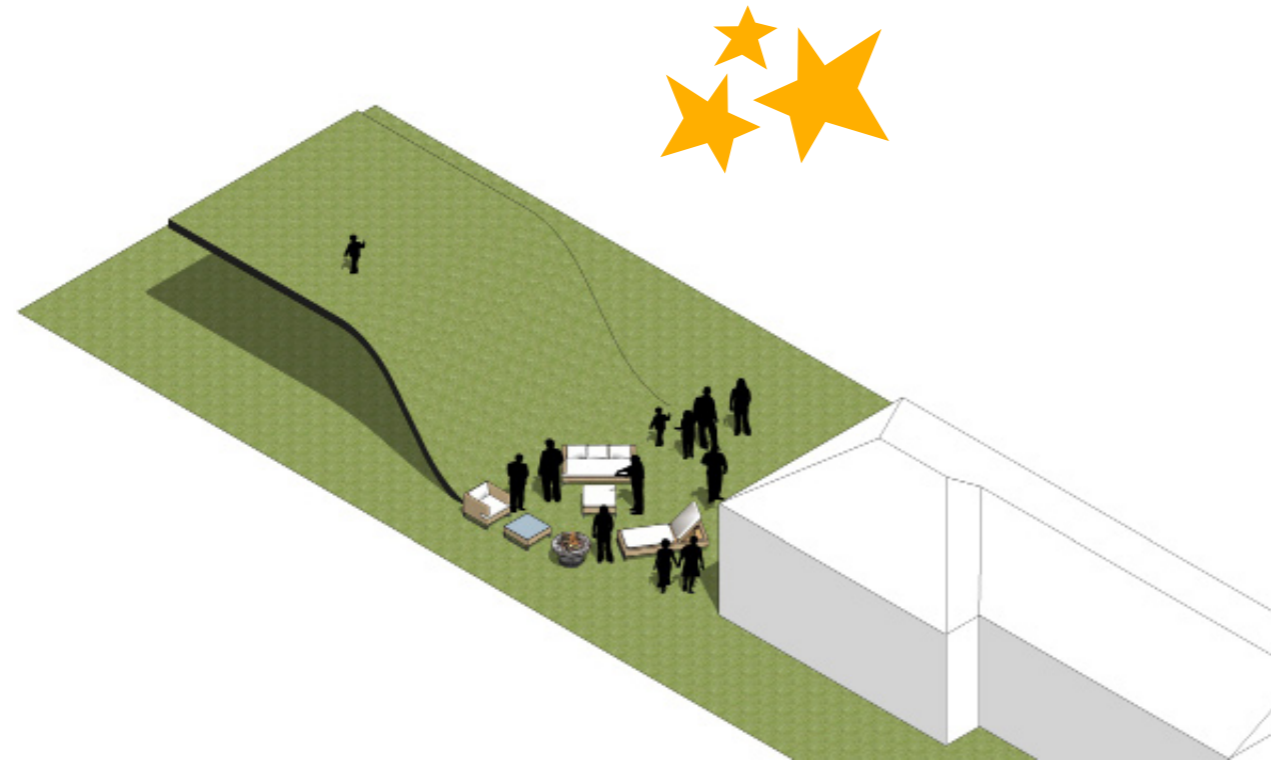

great space for gathering between friends and family under the stars during night time.

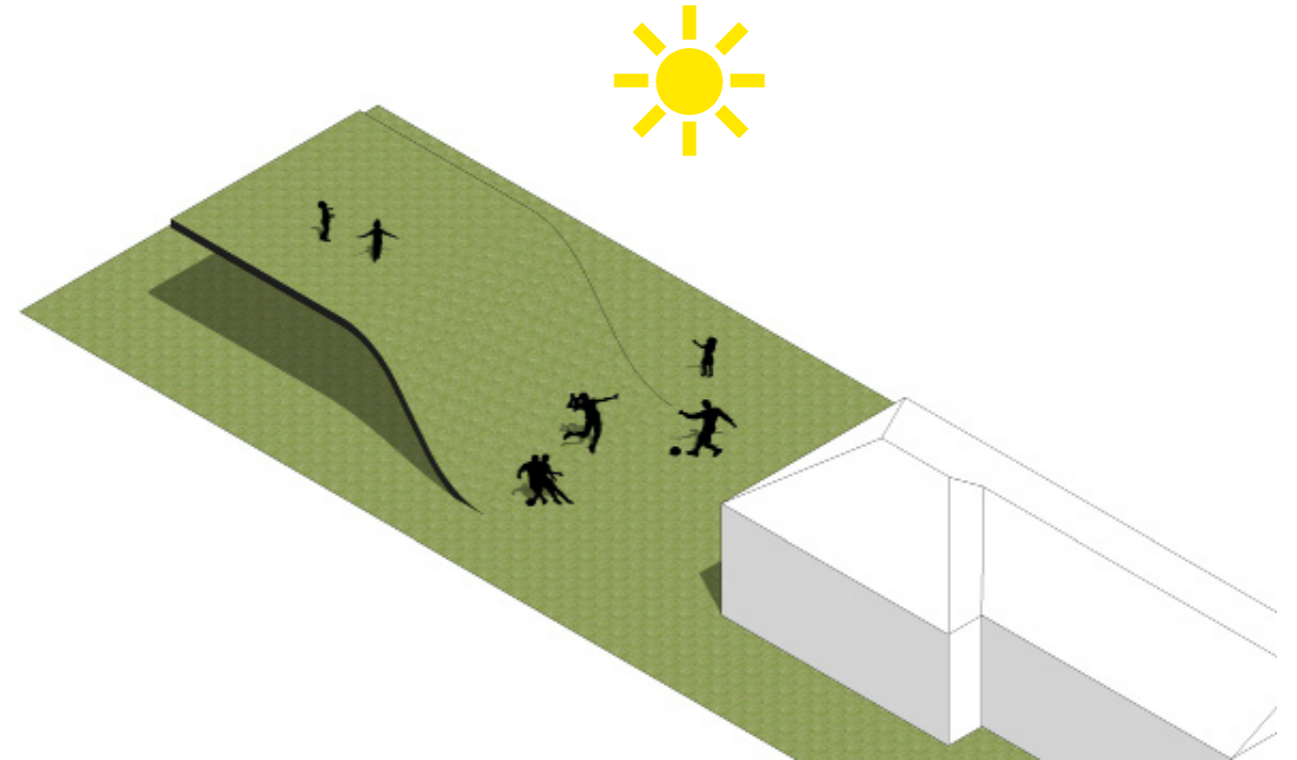

great outdoor space for kids to play and hold activities during daytime.