

Crystal *Beat*

PART II

Station: Piazza Del Rosario
8 Minutes walking - 650 m
Tram Line 14

Station: Porta Genova F.S.
10 Minutes walking - 850 m
Metro Line 2
Tram Line 2, 9
Bus 74, 325

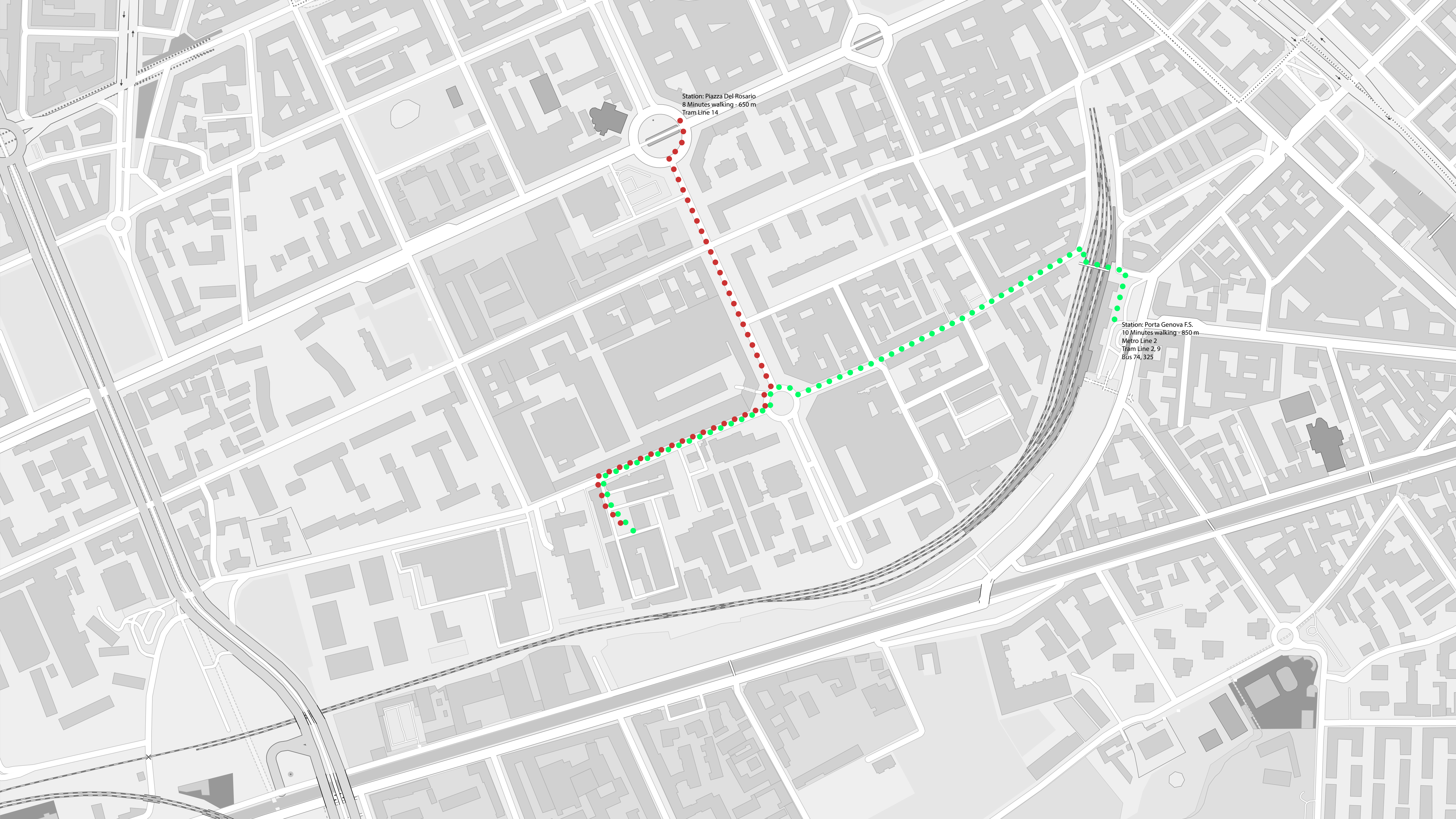

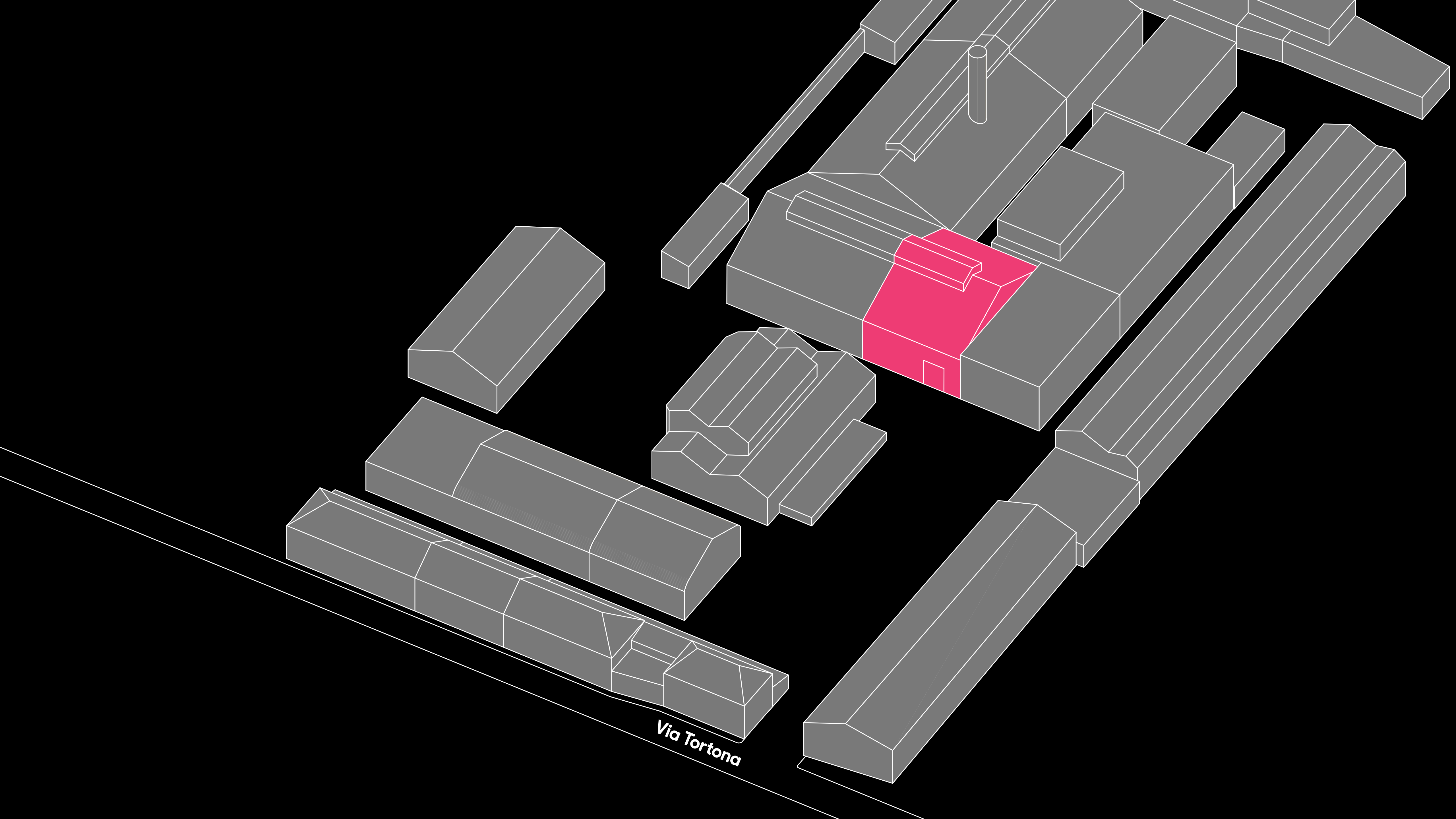

Via Tortona



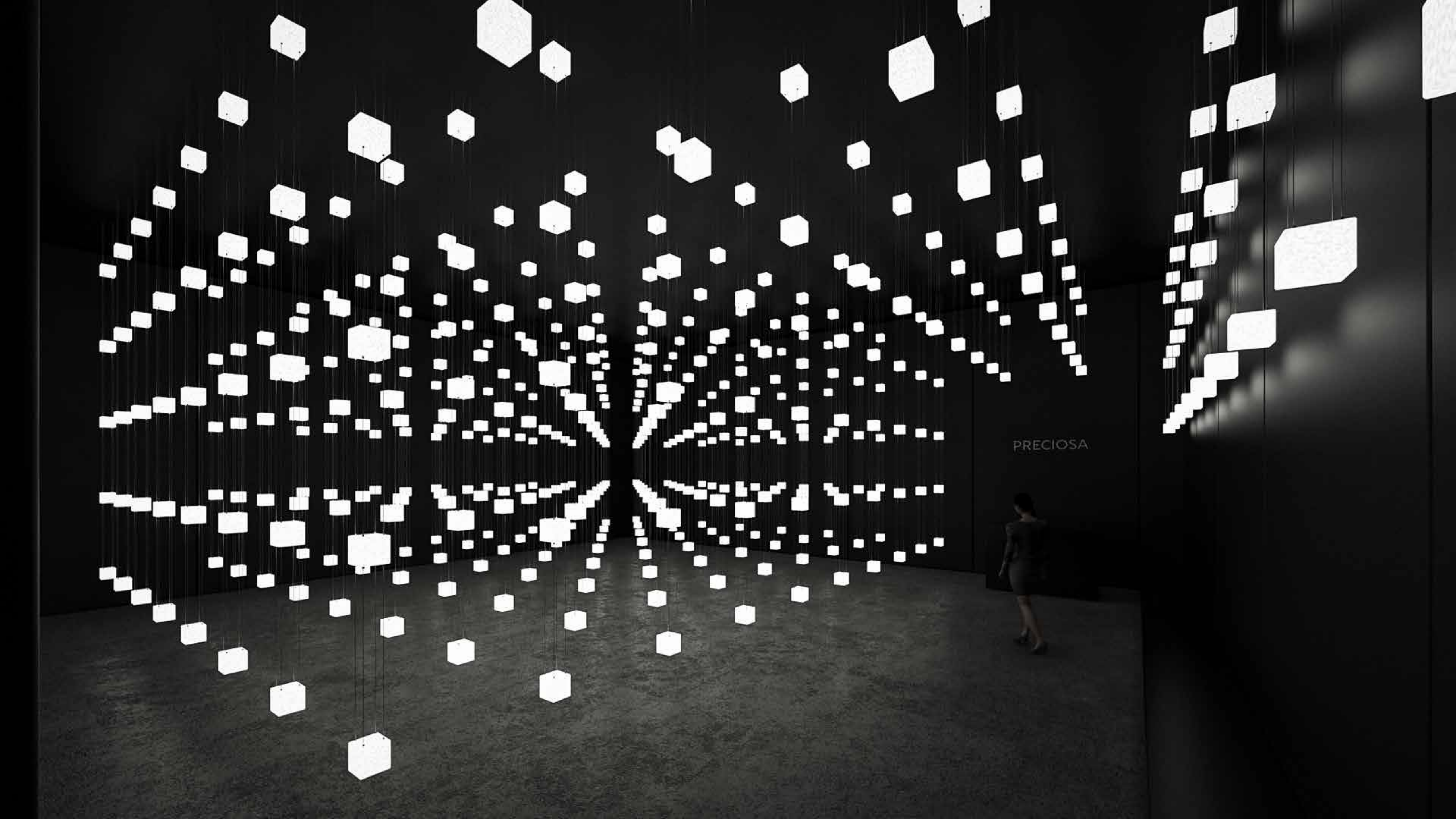

PRECIOSA

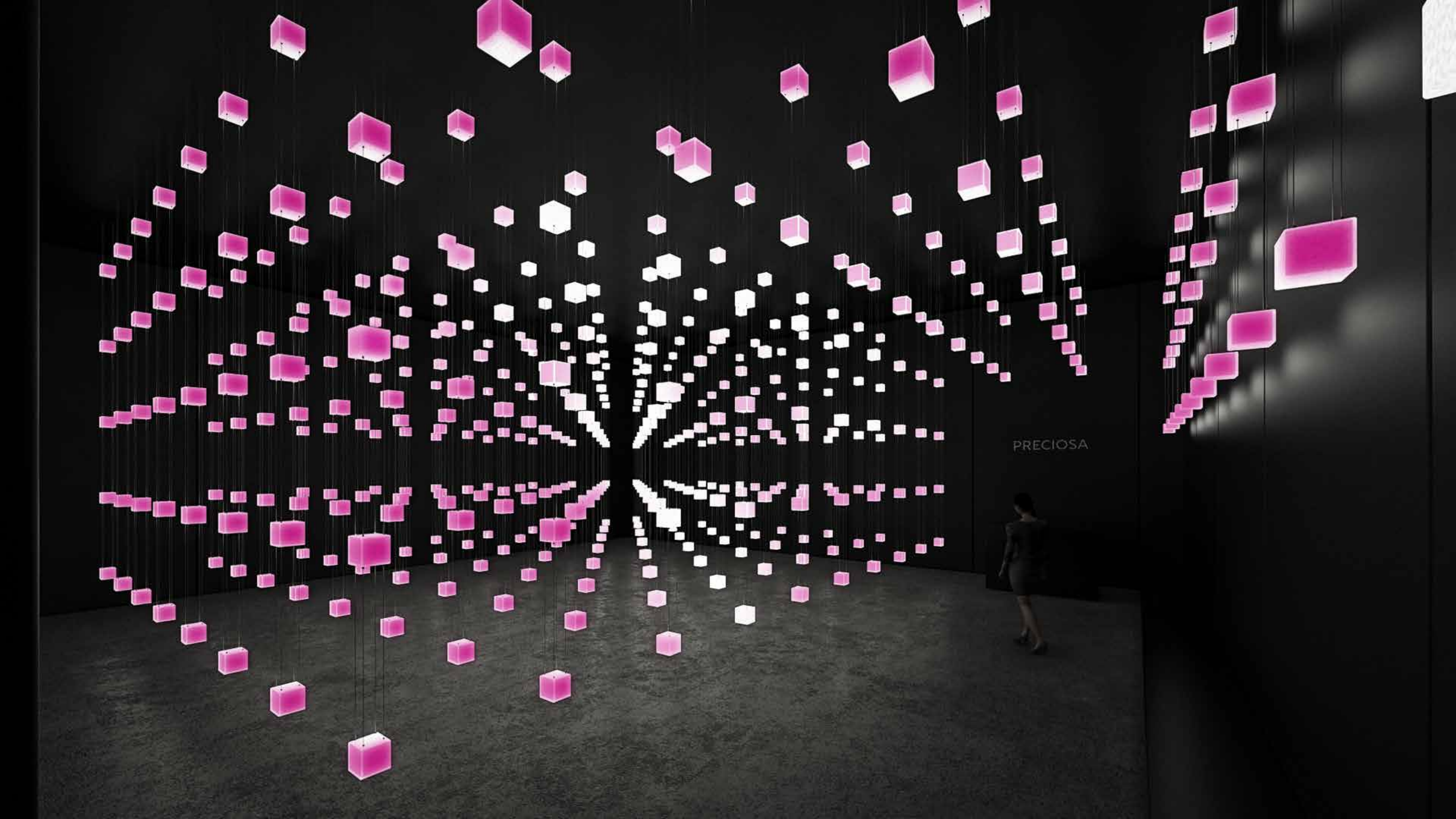

PRECIOSA



PRECIOSA

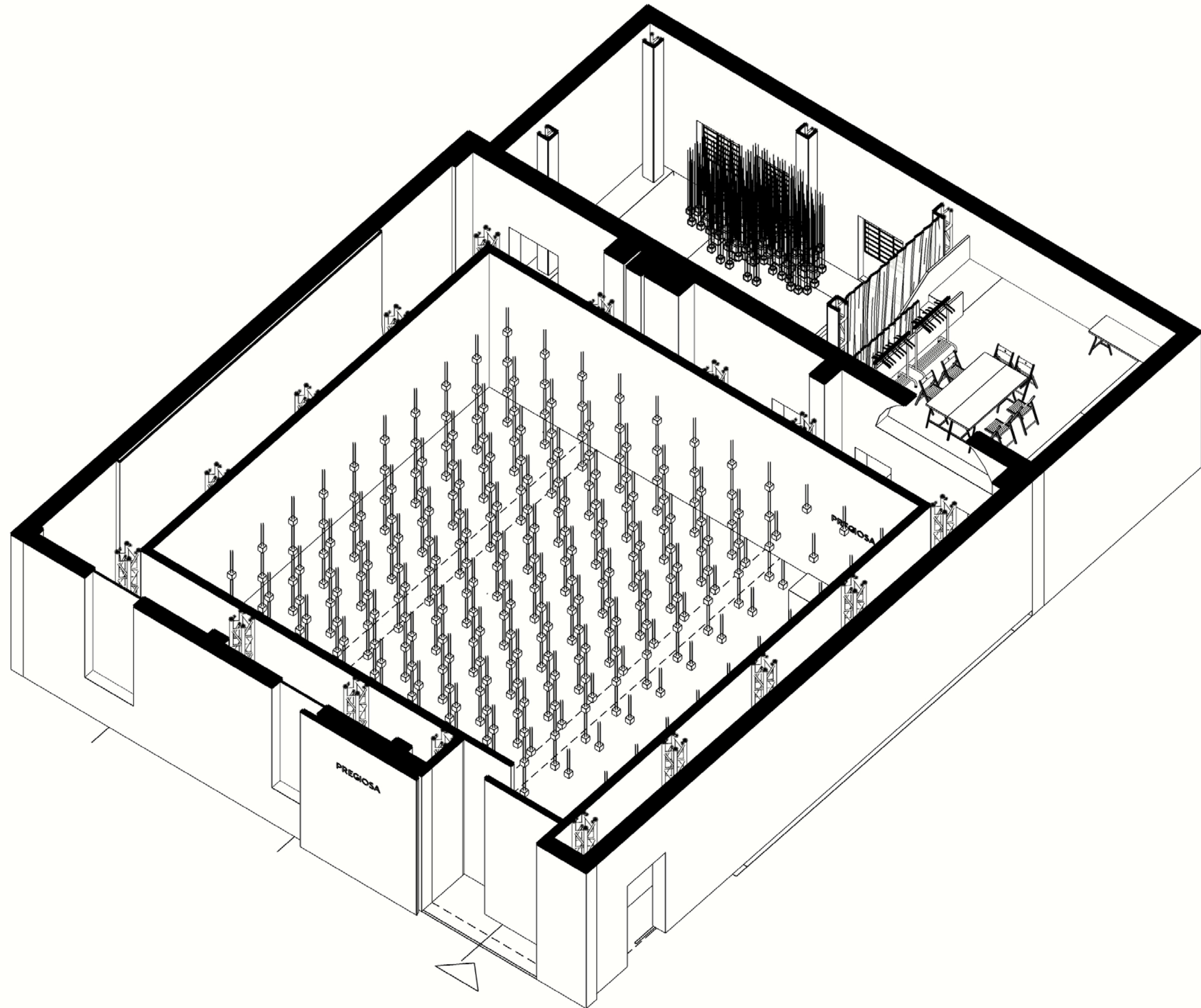

CRYSTAL PIXEL

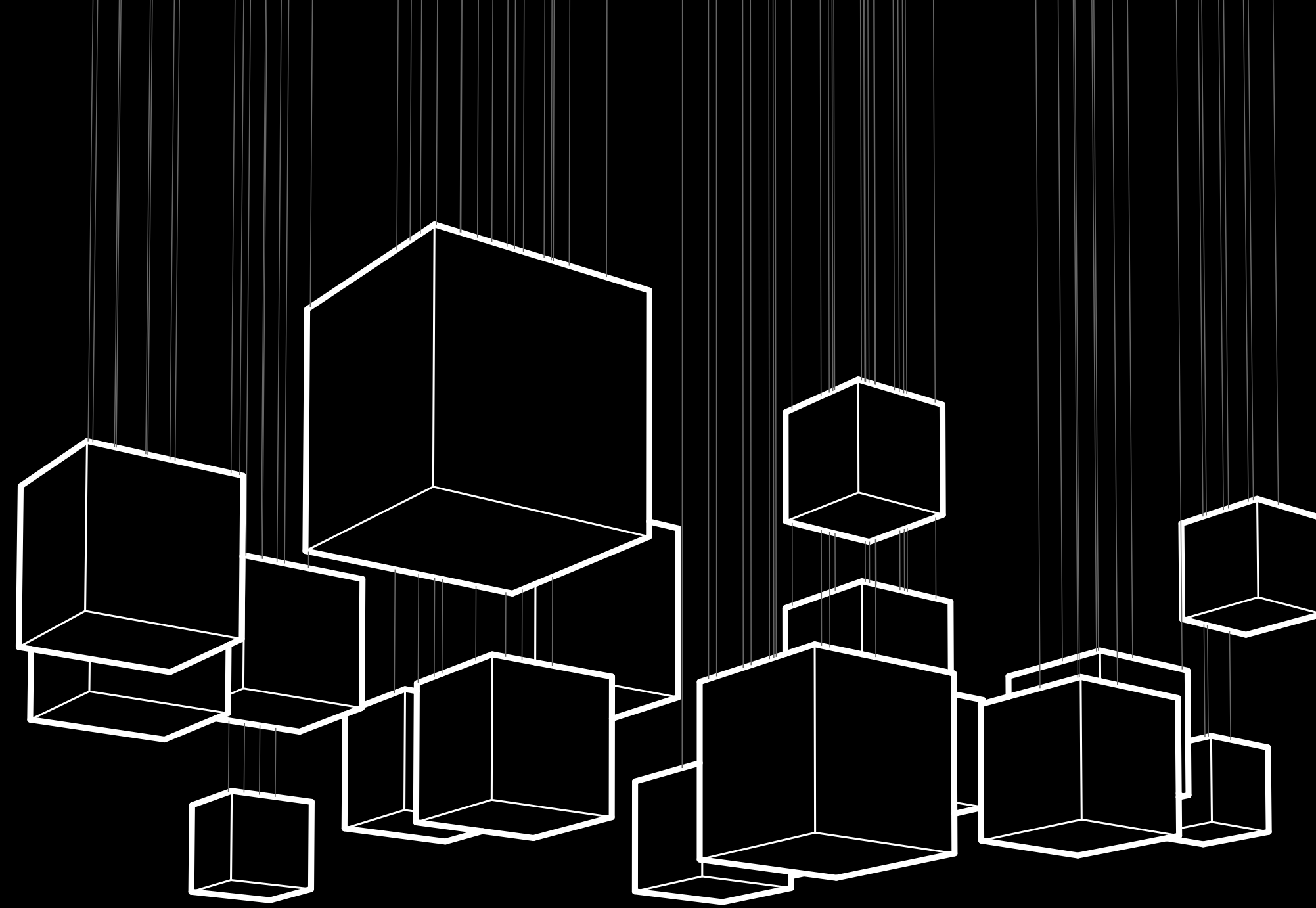

CRYSTAL PIXEL

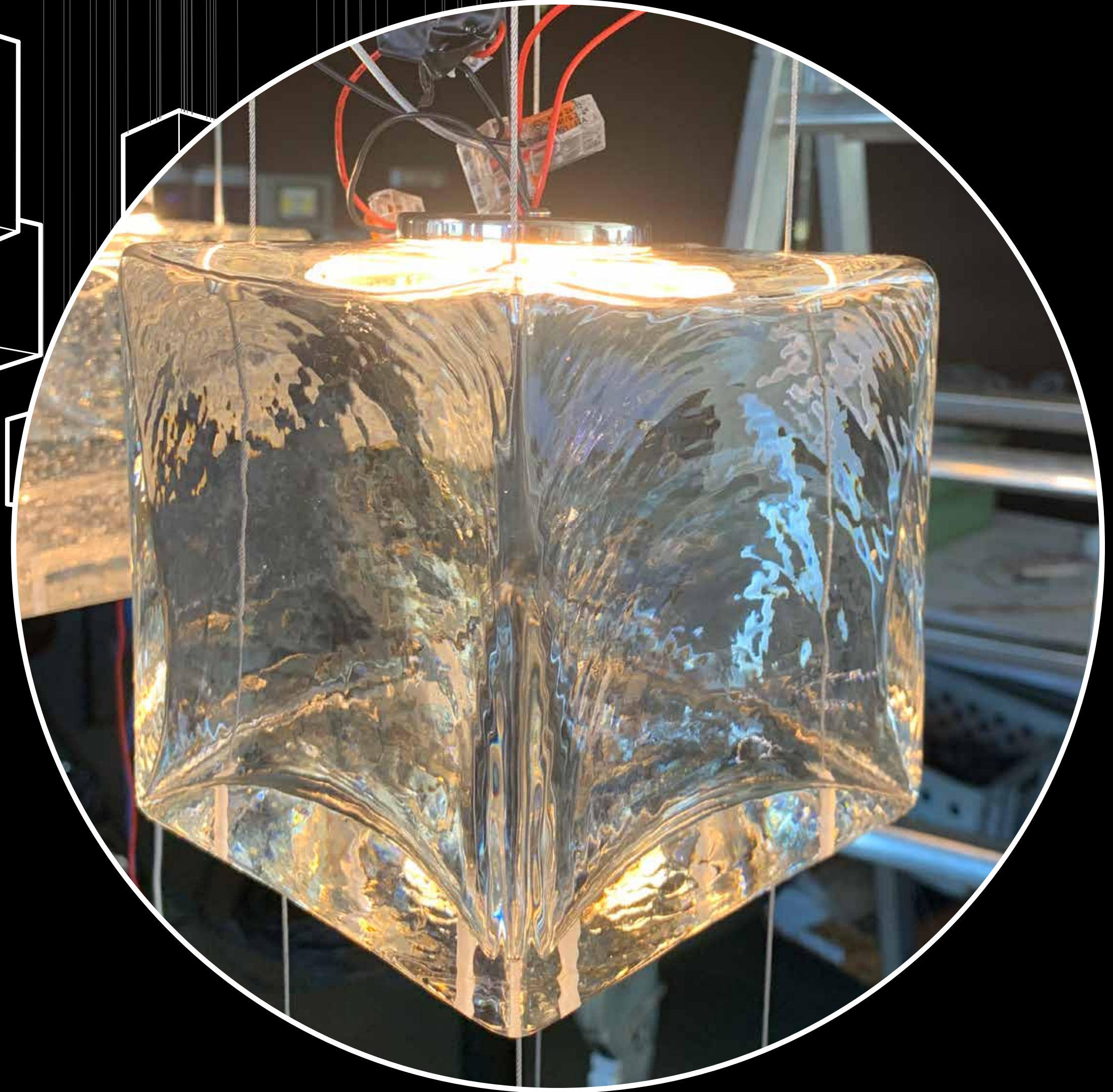
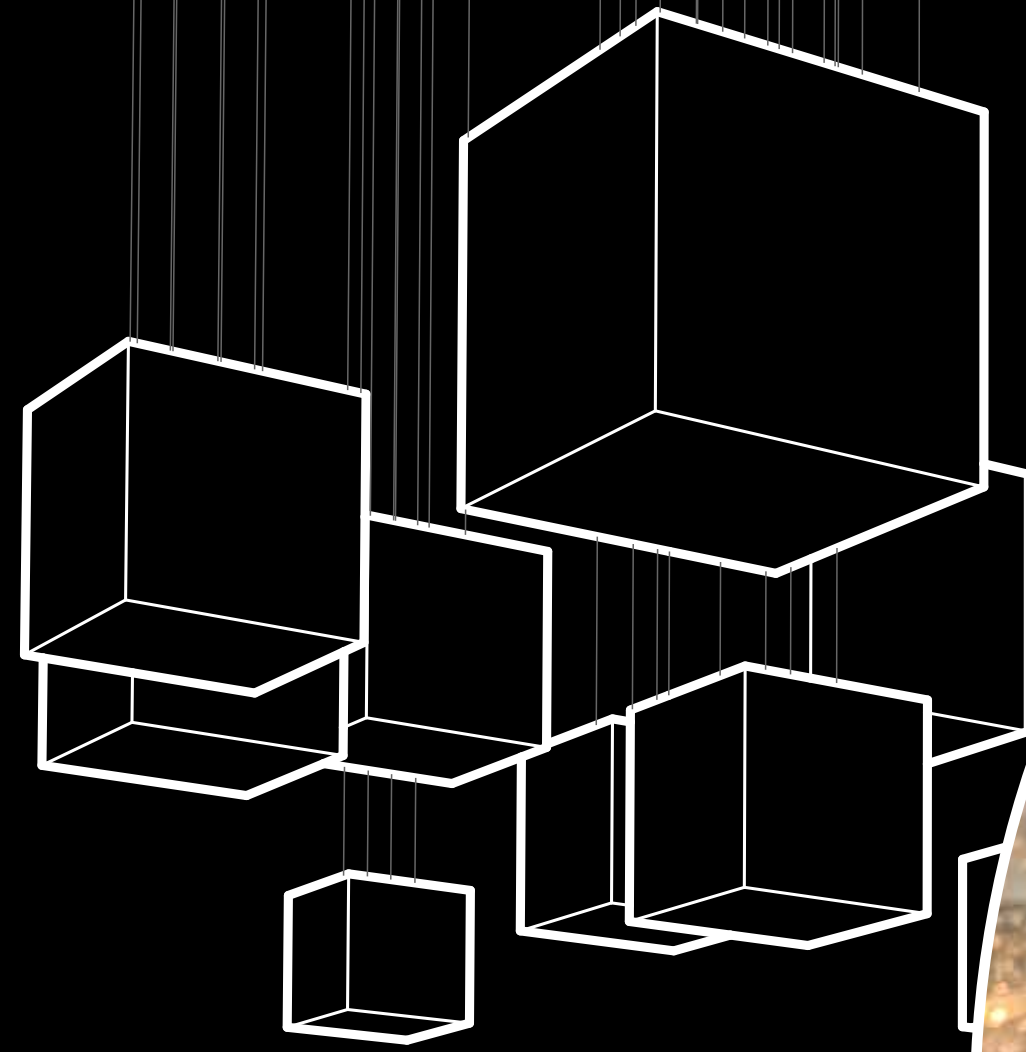

CRYSTAL PIXEL

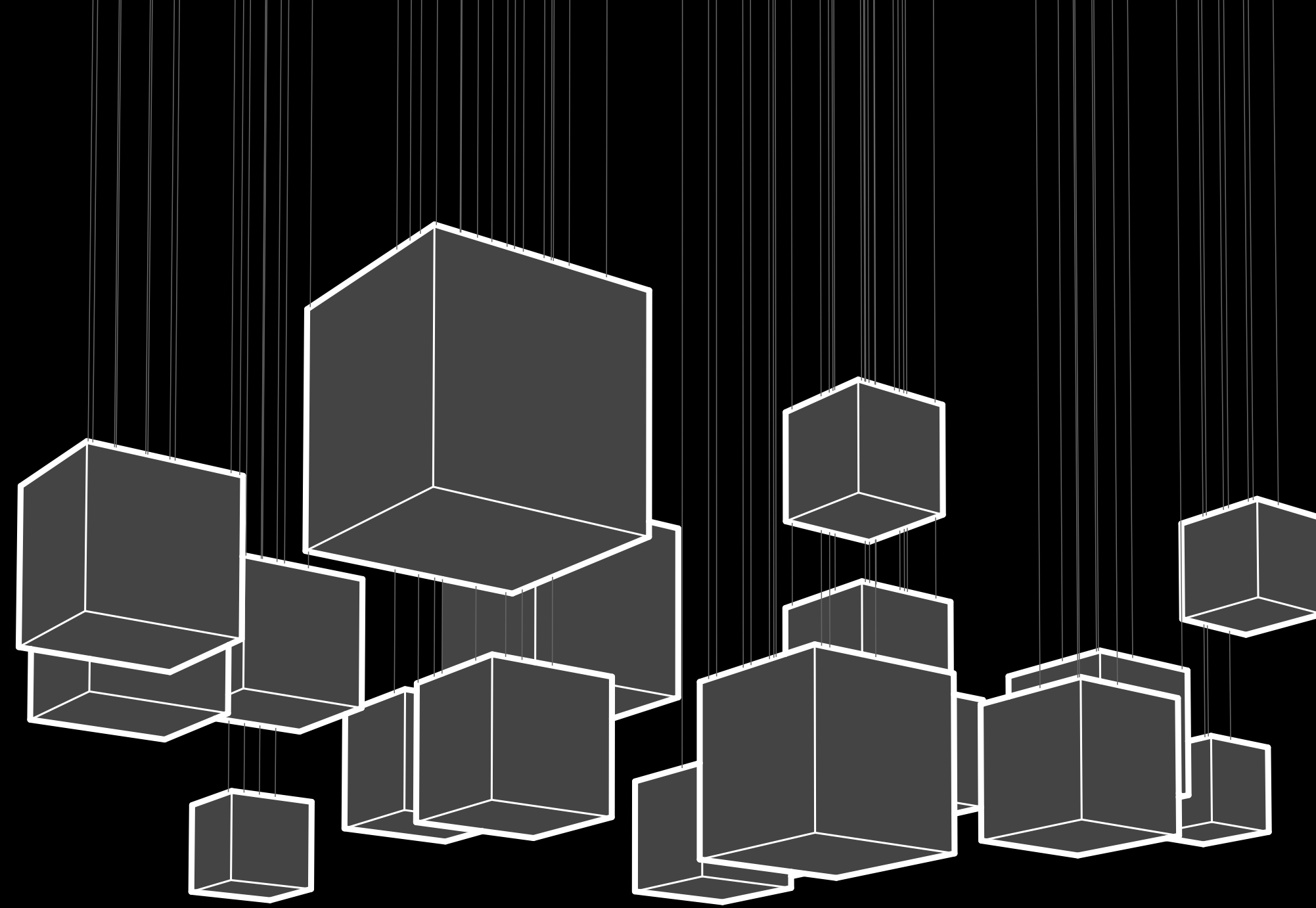

CRYSTAL PIXEL

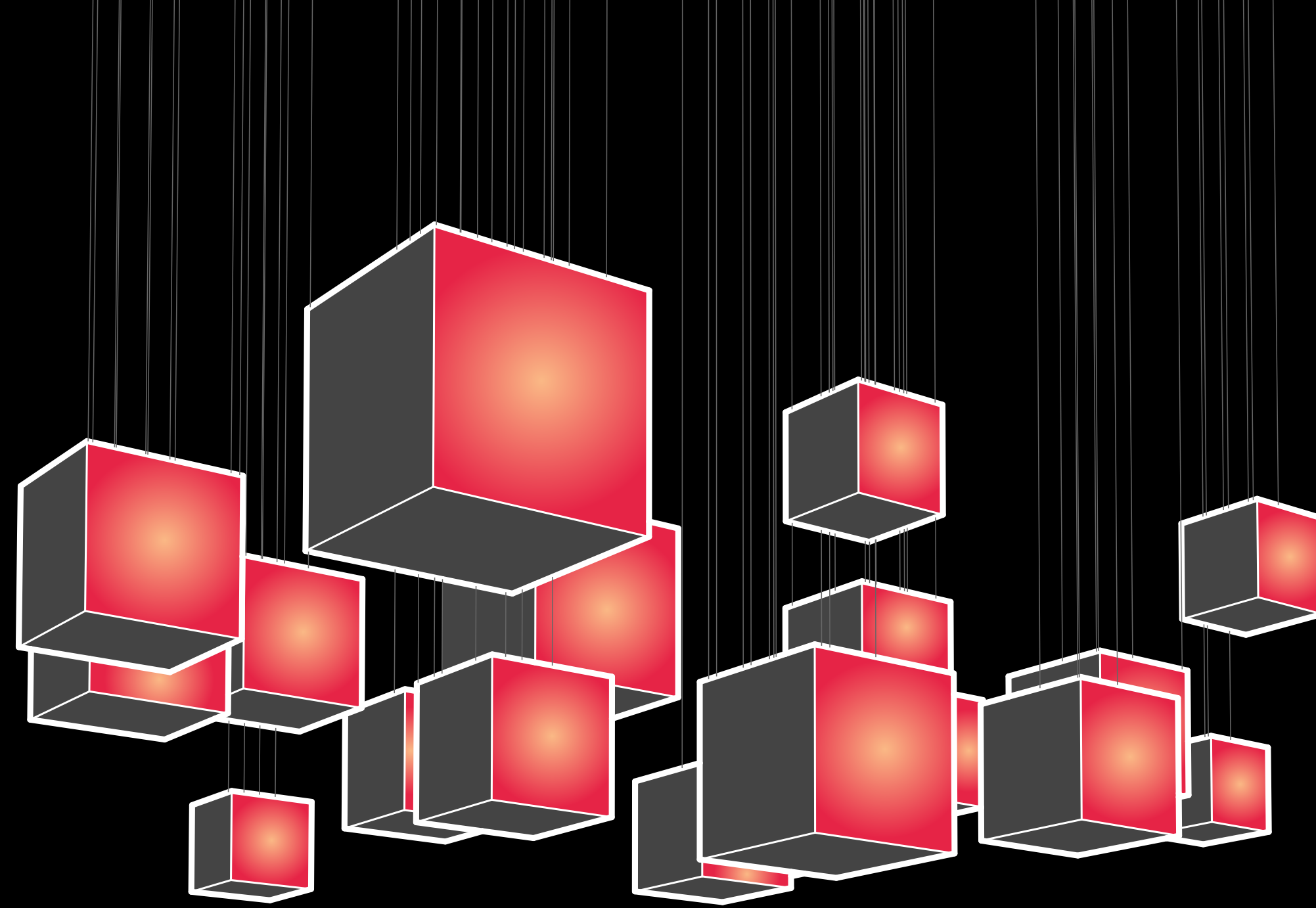

CRYSTAL PIXEL

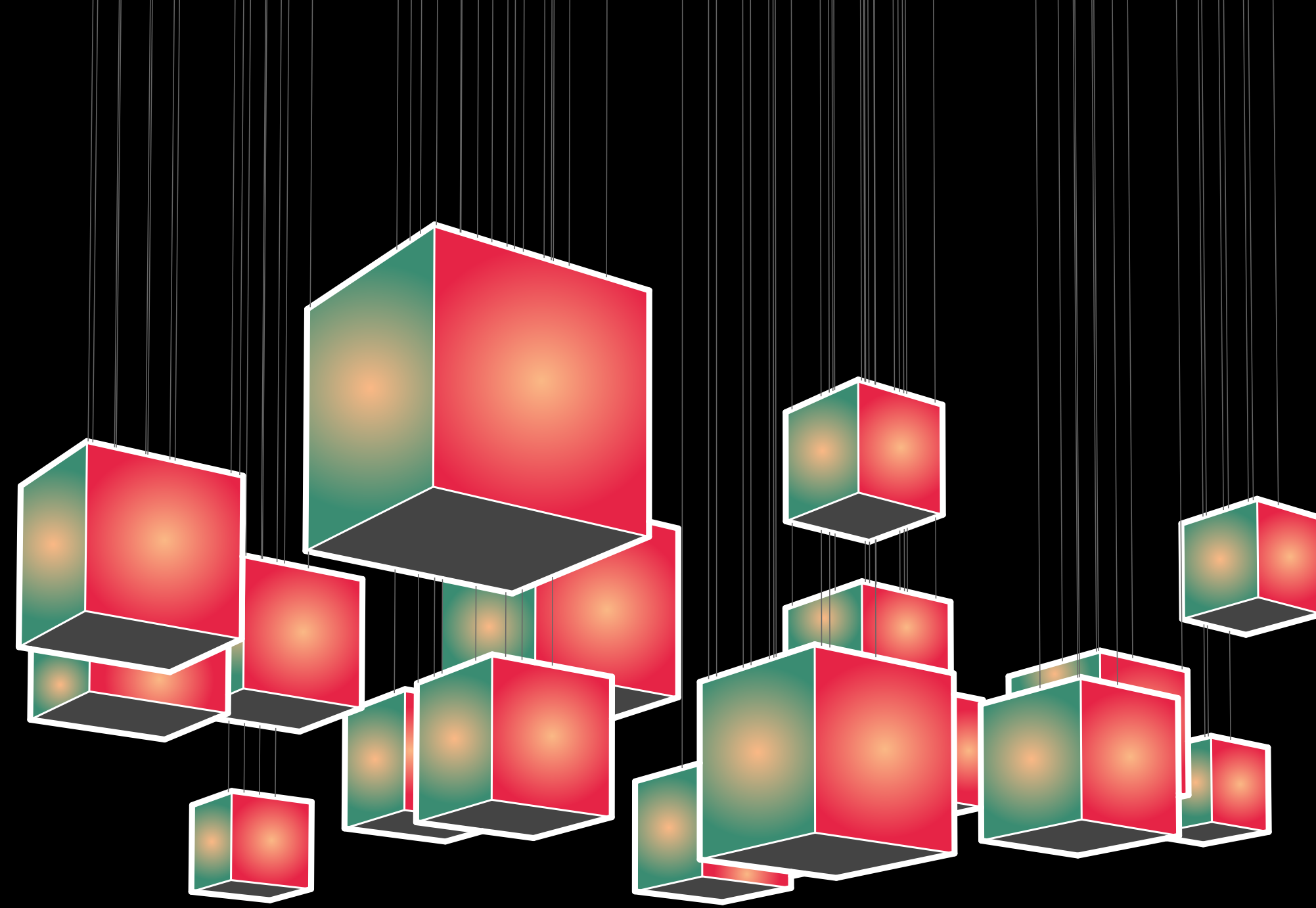

CRYSTAL PIXEL

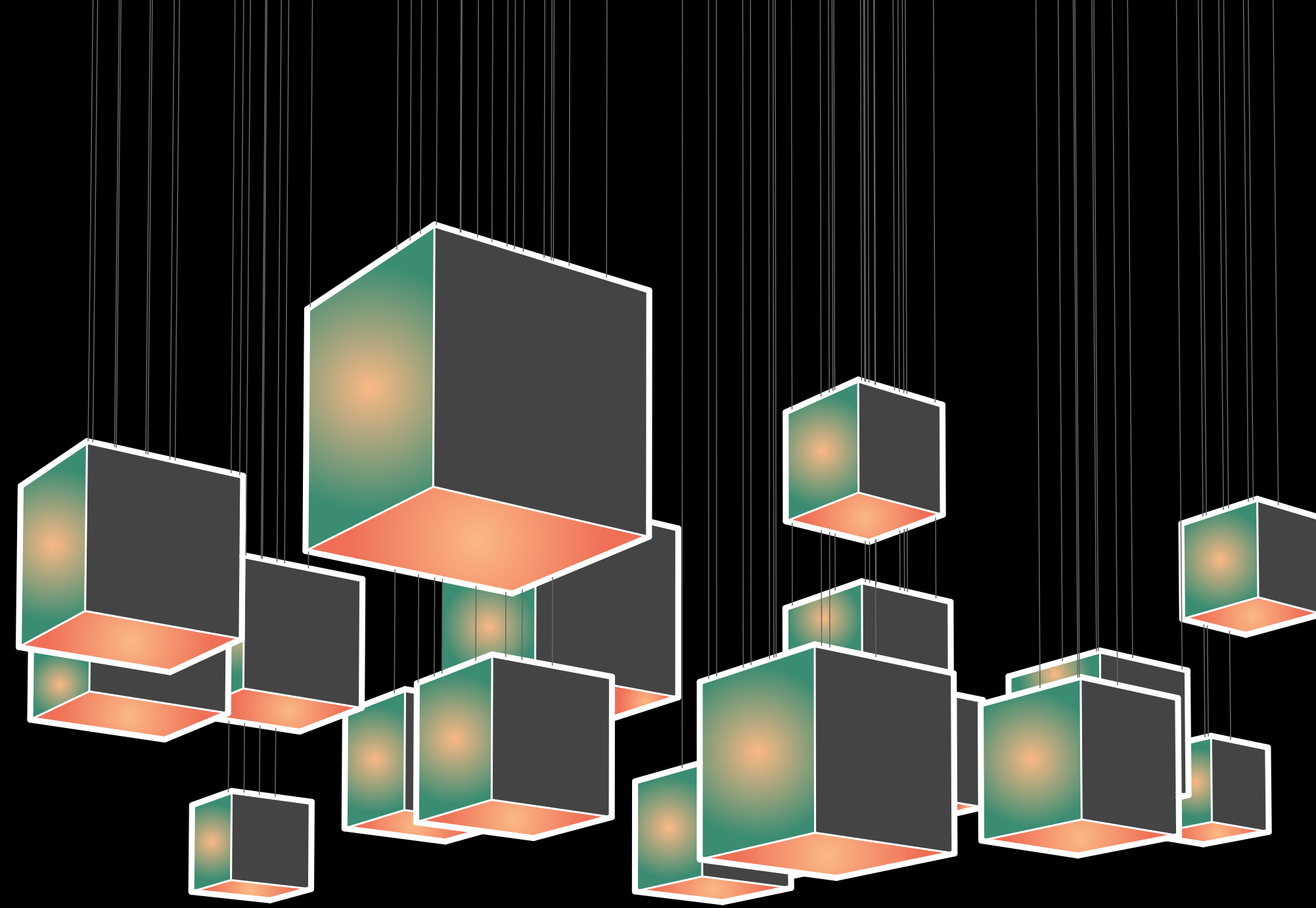

CRYSTAL PIXEL

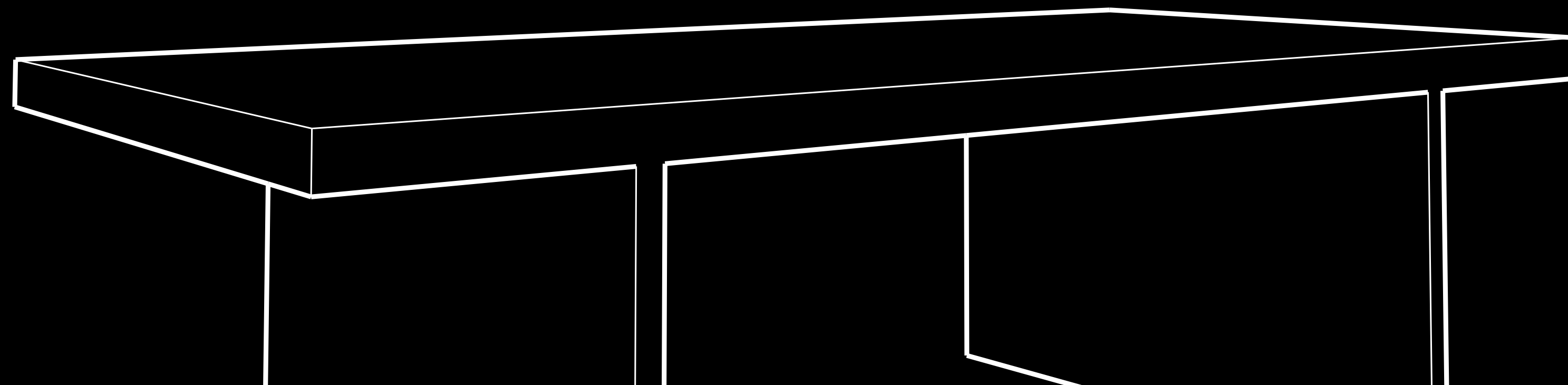
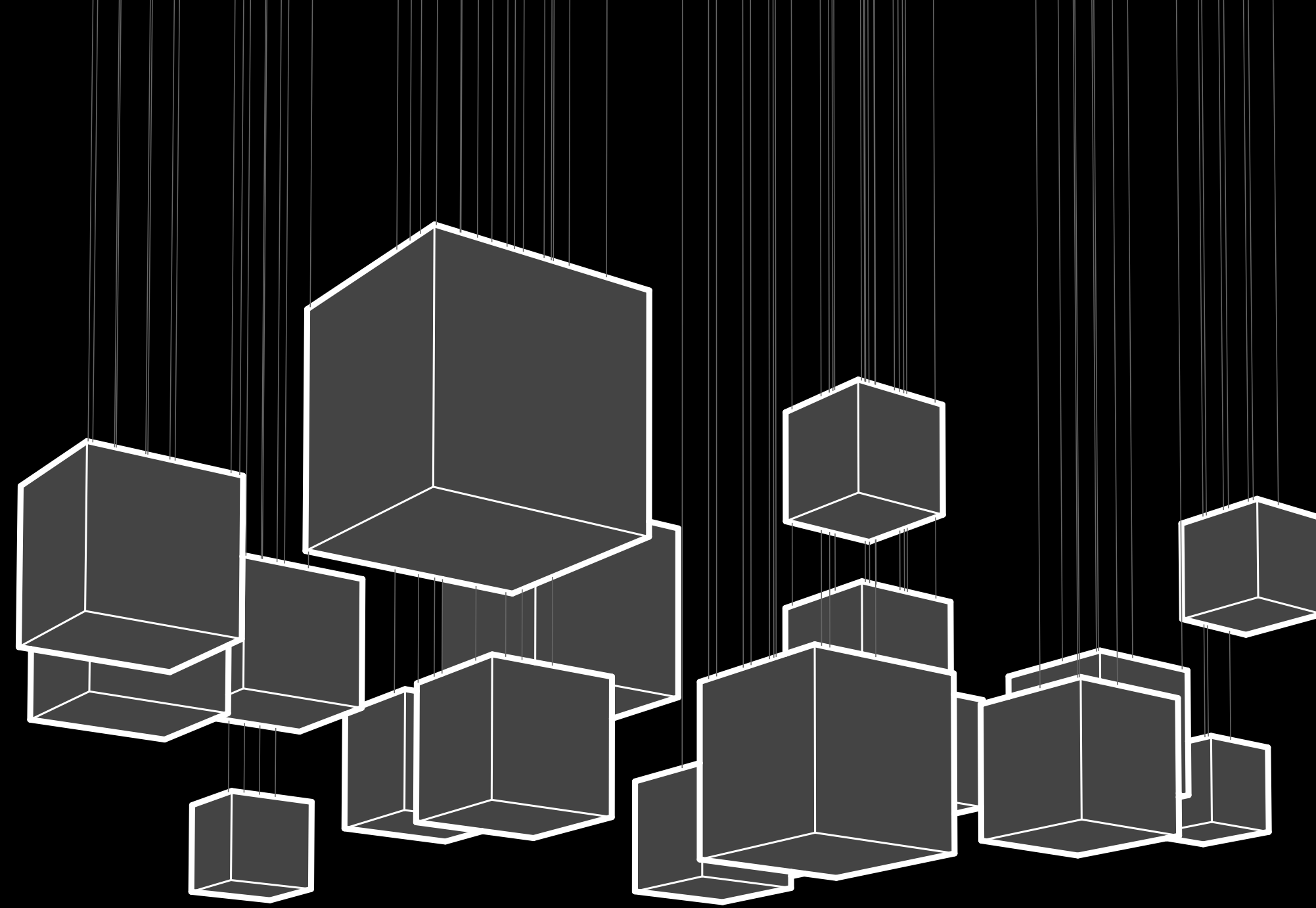

CRYSTAL PIXEL

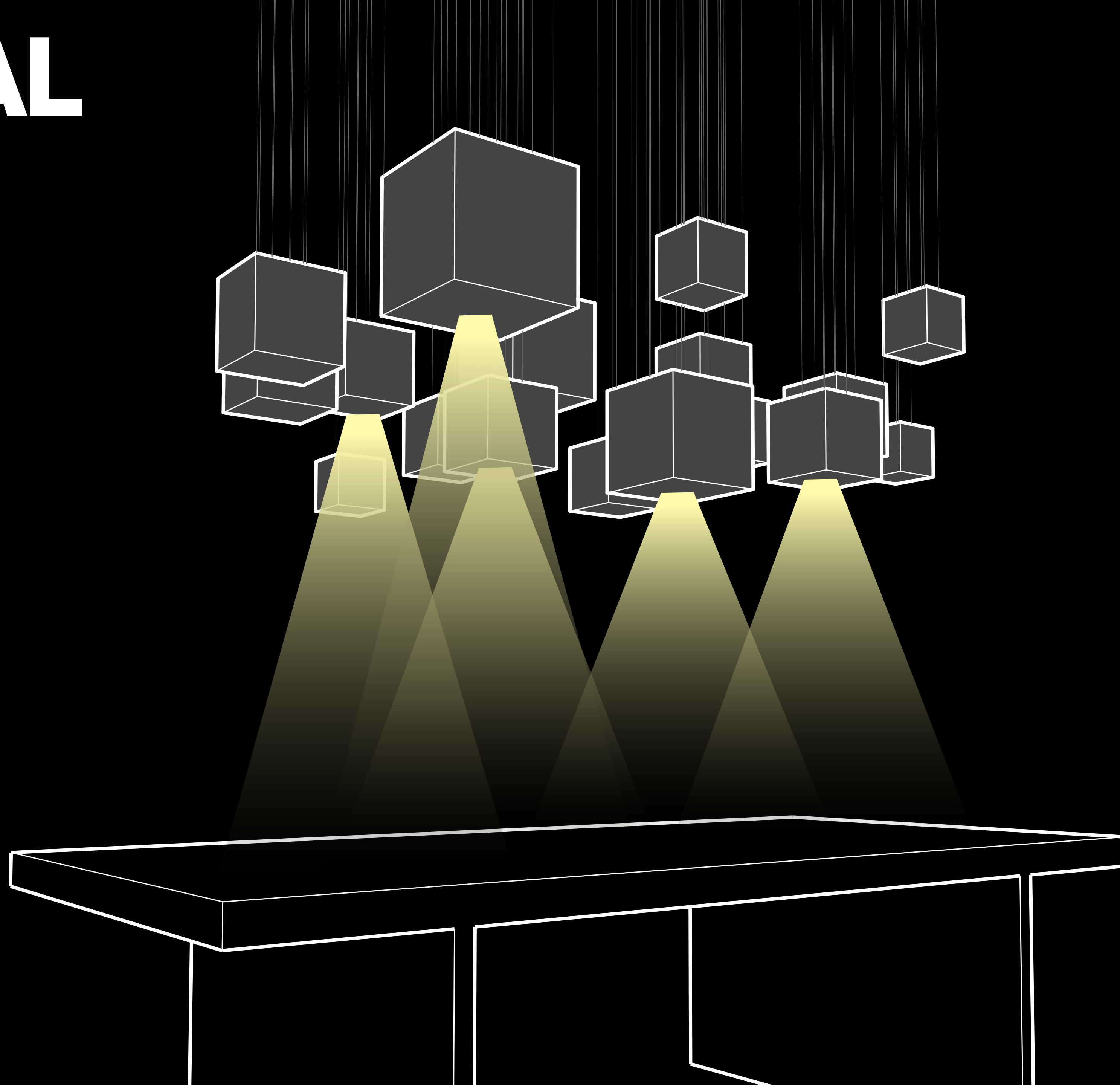

CRYSTAL PIXEL

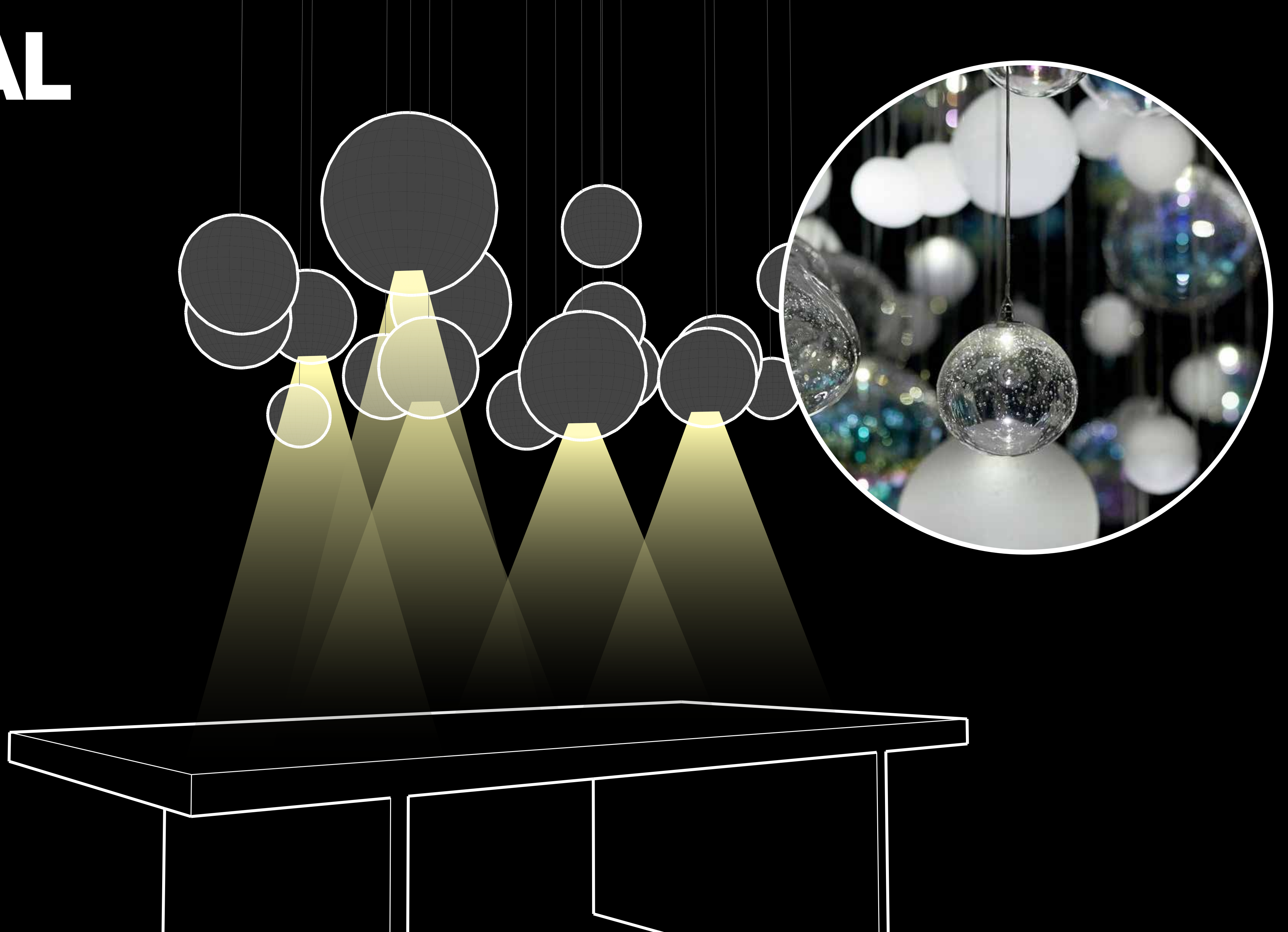

CRYSTAL PIXEL

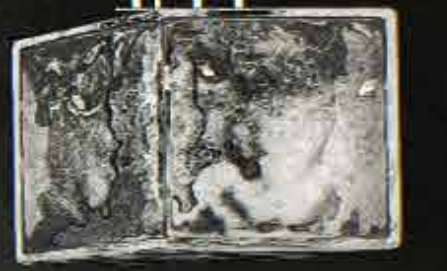
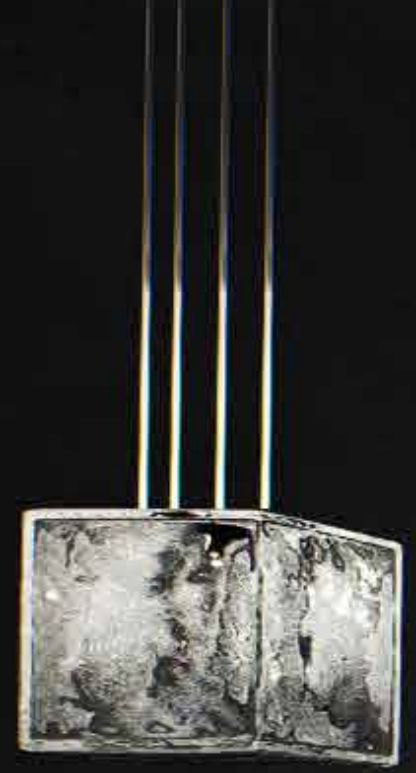

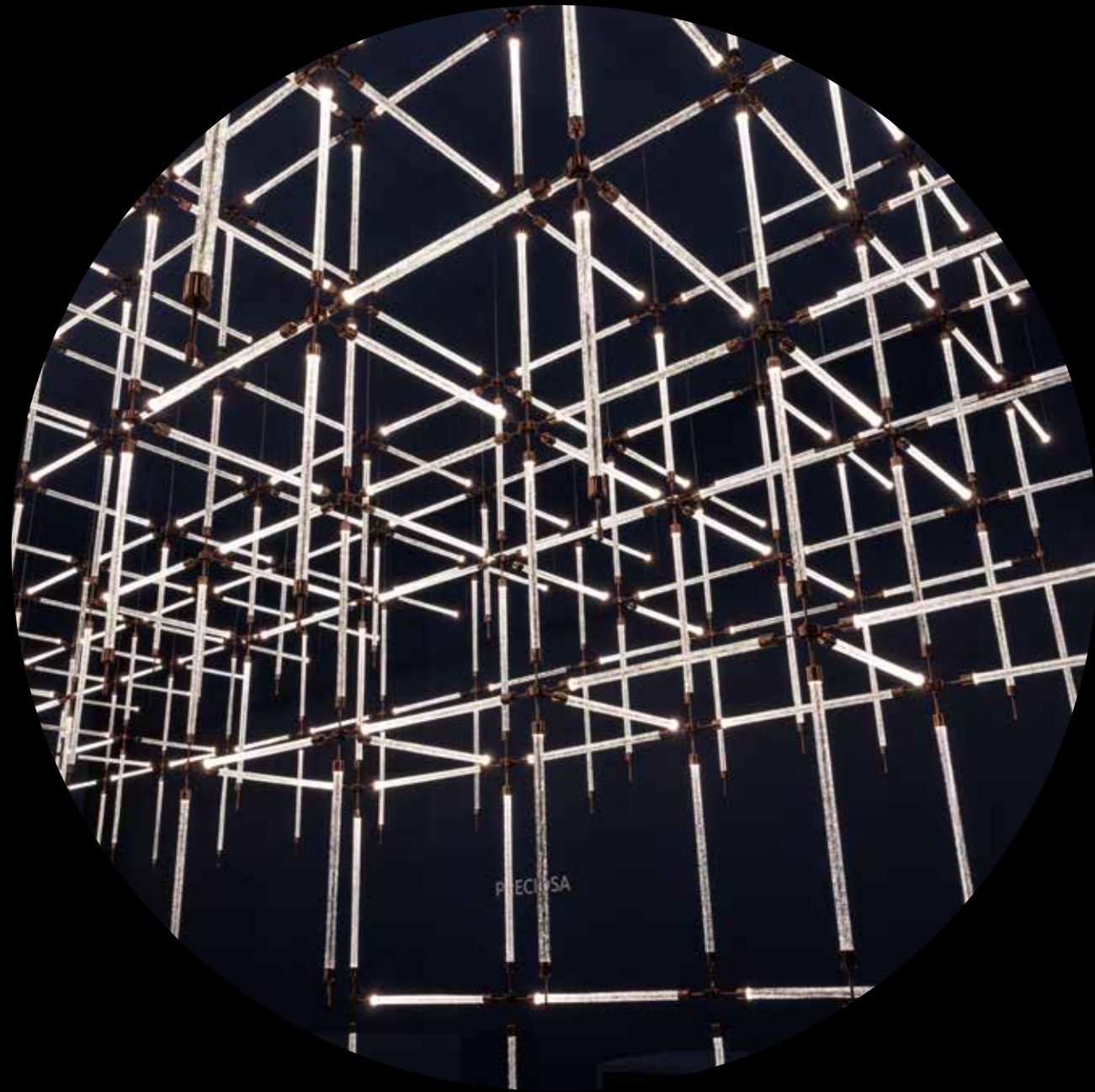

Crystal *Beat*

PART I

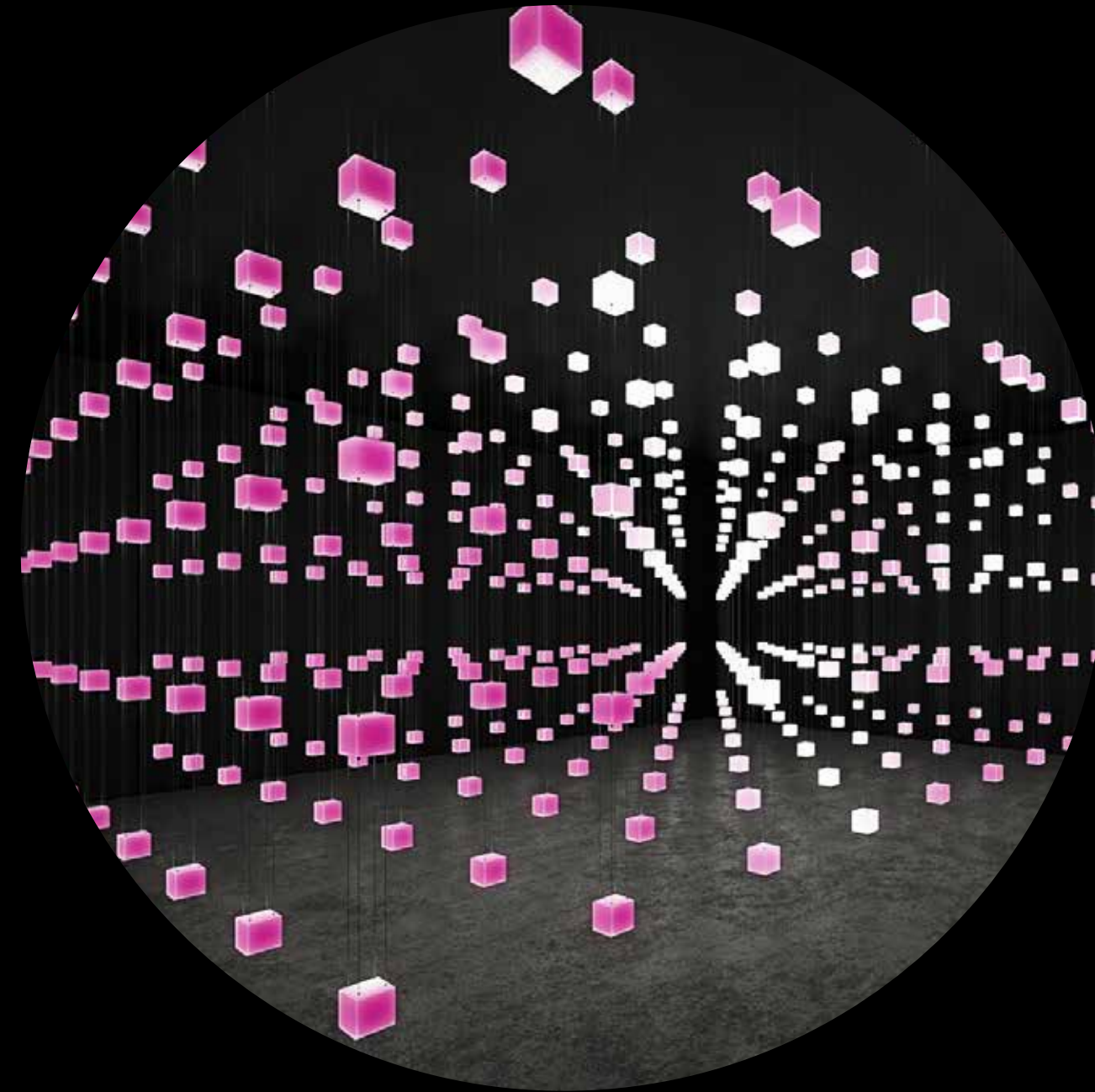

Crystal *Beat*

PART II