

structural engineer

Perrett Simpson
 137 Burnley Street Richmond Victoria 3121
 telephone 9417 5753
 email info@perrettsimpson.com.au

building surveyor

Nelson McDermott
 PO Box 419 Hampton Park VIC 3976
 telephone 1300 799 543

LEGEND

- FP FIREPLACE - MORSE 1440 SUPPLIER: CASTWORKS
- FWG FLOOR WASTE GULLY
- HB HANDBASIN
- HWU RINVAI 80 L HOT/FLO ELECTRIC STORAGE HOT WATER UNIT
- J JOURNEY UNIT
- LF LIGHT FITTING TO DETAIL
- MB ELECTRICAL METER BOX
- M 6 TOUGHENED SAFETY GLASS MIRROR
- PW FLOORWOOD
- RC REINFORCED CONCRETE
- REF REFRIGERATOR
- S SINK
- SS STAINLESS STEEL
- SB ELECTRICAL SWITCHBOARD
- SD SOAP DISH
- SM SHOWER MIRROR
- SR SHOWER RECESS
- TB WALL MOUNTED TOILET BRUSH
- TC AMPELITE LEXAN THERMOCLICK
- TH TOILET PAPER HOLDER
- TR TOWEL RAIL - CUSTOM 25 DIAM SS ON 10 DIAM LAMINATED SS RODS AT MAX 800 CENTRES
- EPK EPOXY FIX TO NOGGINS
- WC WATER CLOSET
- WF 'WEBFORGE' 30 x 3 @ 30 CTRS STEEL GRATING AS SPECIFIED

GLAZING LEGEND

- A DOUBLE GLAZED LOW-E COATED ARGON FILLED TO THE FOLLOWING SPECIFICATIONS:
 U VALUE 1.8
 SHGC COEFFICIENT 0.77
 SOLAR HEAT GAIN FACTOR 0.67
- B 600 CLEAR TOUGHENED SAFETY GLASS TO SHUG'S SASHLESS DOUBLE HUNG WINDOWS

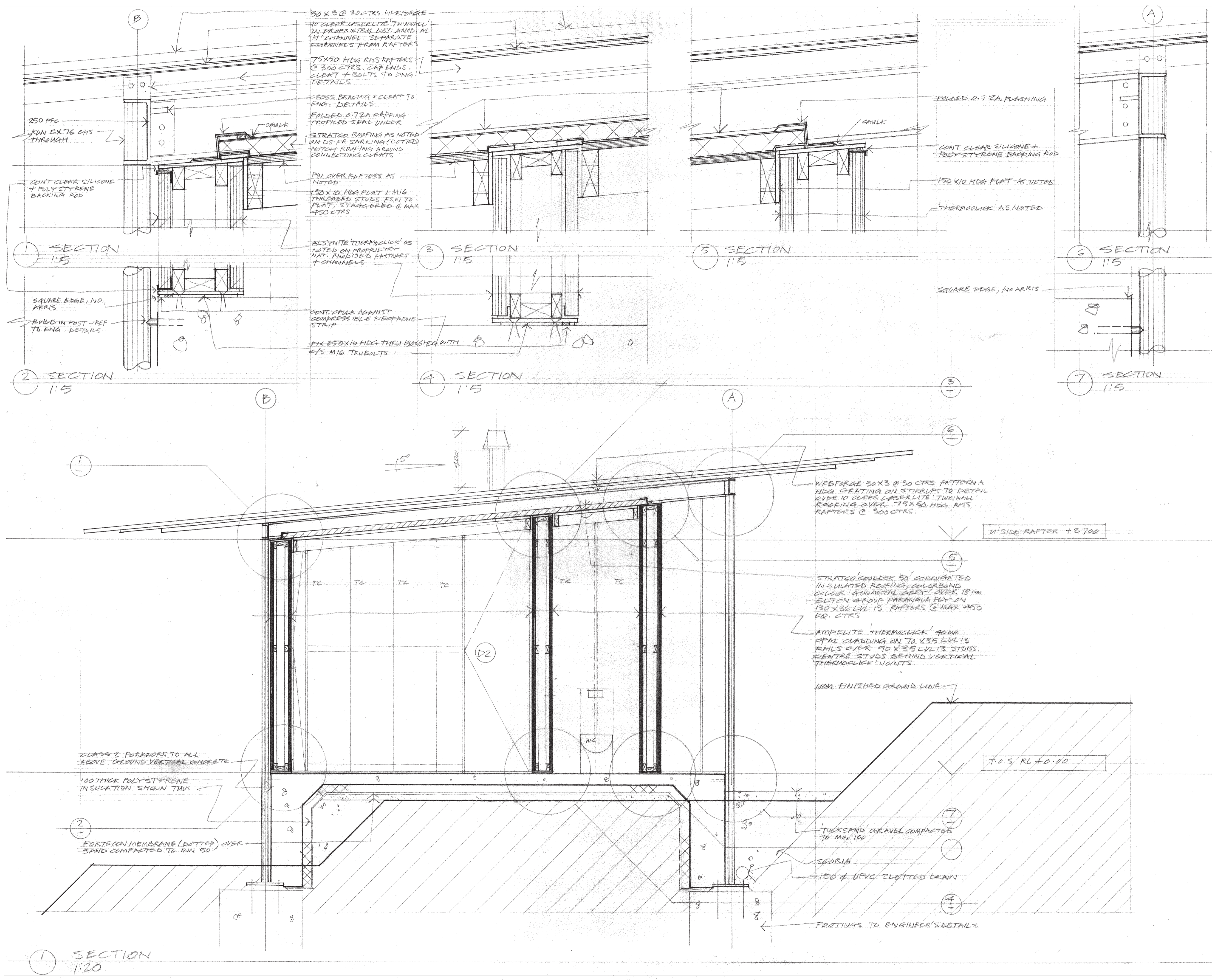

30 X 3 @ 30 CTRS. WEBFORGE
 10 CLEAR LASERLITE TWINWALL
 IN PROPRIETARY NAT. ANOD. AL
 'H' CHANNELS SEPARATE
 CHANNELS FROM RAFTERS

75 X 50 HDG RHS RAFTERS
 @ 300 CTRS. CAP ENDS
 CLEAT + BOLTS TO ENG.
 DETAILS

CROSS BRACING + CLEAT TO
 ENG. DETAILS

FOLDED 0.7 ZA CAPPING
 PROFILED SEAL UNDER

STRATCO ROOFING AS NOTED
 ON DS FR SARKING (DOTTED)
 NOTCH ROOFING AROUND
 CONNECTING CLEATS

FIN OVER RAFTERS AS
 NOTED

150 X 10 HDG FLAT + M16
 THREADED STUDS FSW TO
 FLAT, STAGGERED @ MAX
 450 CTRS

ALUMITE THERMOCLICK AS
 NOTED ON PROPRIETARY
 NAT. ANODISED FASTENERS
 + CHANNELS

CONT. CAULK AGAINST
 COMPRESSIBLE NEOPRENE
 STRIP

FIX 250 X 10 HDG THRU 180 X 6 HDG WITH
 4/5 M16 TRUBOLTS

WEBFORGE 30 X 3 @ 30 CTRS PATTERN A
 HDG GRATING ON STIRRUPS TO DETAIL
 OVER 10 CLEAR LASERLITE TWINWALL
 ROOFING OVER 75 X 50 HDG RHS
 RAFTERS @ 300 CTRS.

STRATCO COOLDEK 50 CORRUGATED
 IN SILLATED ROOFING, COLORBOND
 COLOUR 'GUNMETAL GREY' OVER 18 MM
 ELTON GROUP PARANGULA PLAT ON
 130 X 36 LVL 13 RAFTERS @ MAX 450
 BR. CTRS

AMPELITE THERMOCLICK 40MM
 OPAL CLADDING ON TO X35 LVL 13
 RAILS OVER 40 X 35 LVL 13 STUDS.
 CENTRE STUDS BEHIND VERTICAL
 THERMOCLICK JOINTS

CLASS 2 FORMWORK TO ALL
 ABOVE GROUND VERTICAL CONCRETE

100THICK POLYSTYRENE
 INSULATION SHOWN THUS

FORTECON MEMBRANE (DOTTED) OVER
 SAND COMPACTED TO MIN 50

NON FINISHED GROUND LINE

TUCKSAND GRAVEL COMPACTED
 TO MIN 100

SCORIA

150 Ø UPVC SLOTTED DRAIN

FOOTINGS TO ENGINEER'S DETAILS

revision	
project	
drawing	WORKING DRAWING
scale	AS SHOWN A1
date	JULY 2019
project no.	1503B
revision	
drawing no.	A06

It is the Contractor's responsibility to confirm all dimensions on site prior to commencing. Do not scale the drawings. Refer any discrepancies to the Architect for clarification. Copyright Godsell Associates Pty Ltd.