

1906

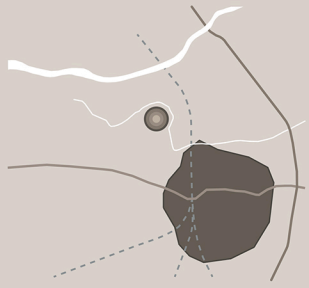

1928



1930



1978

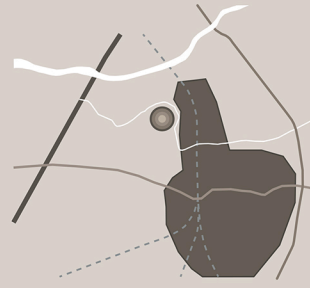

2014

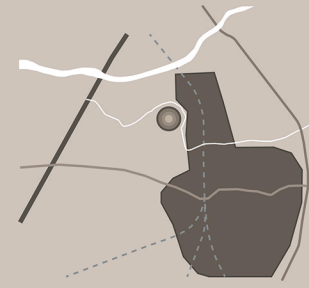

SINTESI INTERPRETATIVA

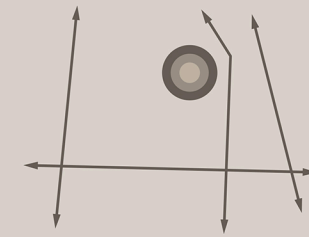

ESCLUSIONE

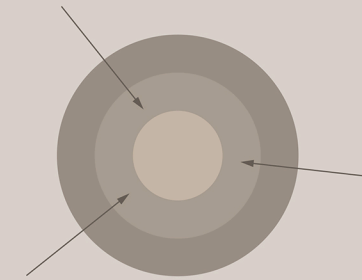

IMPORTANZA DEL CENTRO

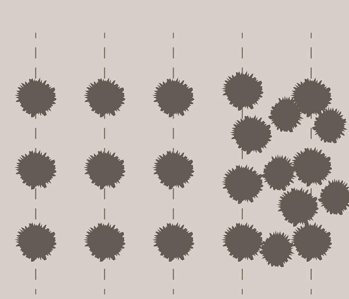

PERDITA DI CONTROLLO

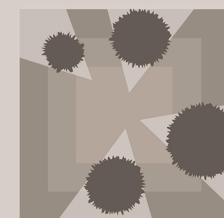

OSTRUZIONE

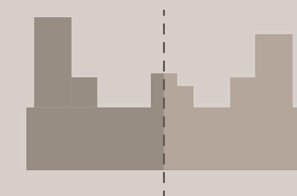

PERDITA DELLA SIMMETRIA
A FAVORE DELLA FUNZIONALITÀ

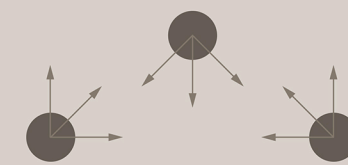

PERMEABILITÀ

LINEAMENTI DI PROGETTO

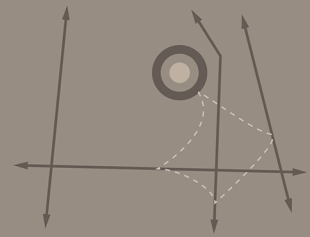

SVILUPPO DEI COLLEGAMENTI

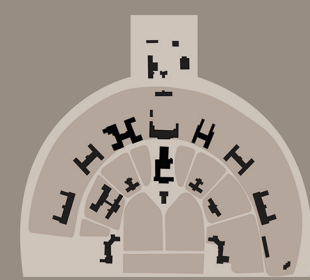

FUNZIONALITÀ

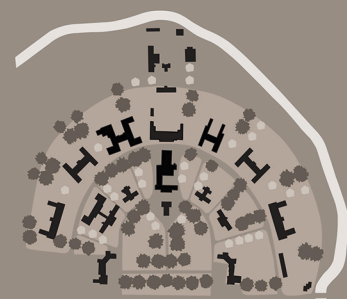

EQUILIBRIO

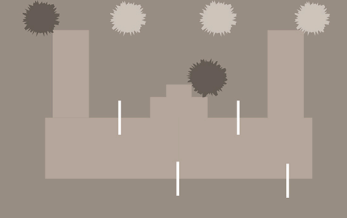

ACCESSIBILITÀ

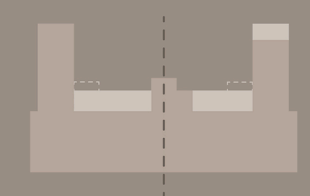

SIMMETRIA

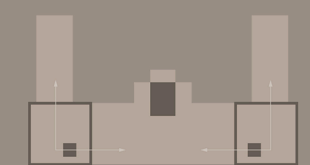

SERVIZI COME CONNESSIONE

RETE VIARIA

ORGANIZZAZIONE DELLA STRUTTURA
sistema efficiente

PROGRESSIVA PERDITA DI CONTROLLO
rapporto con il verde

RAPPORTO INTERNO ESTERNO
sistema degli accessi

AGGREGAZIONE SPAZIALE

DIREZIONALITÀ

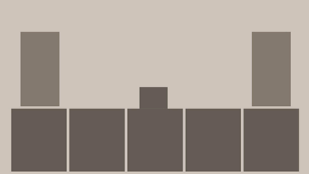
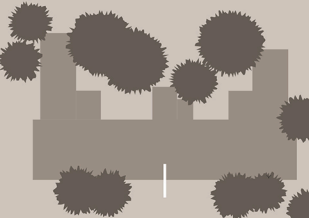
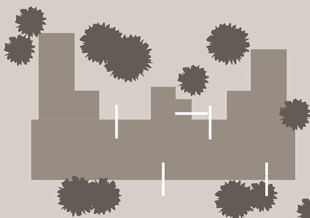
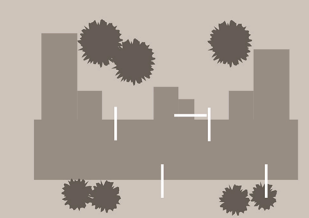
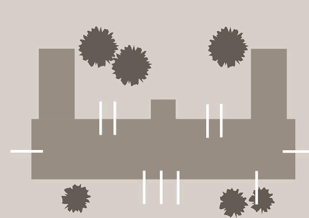
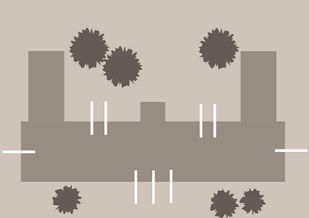
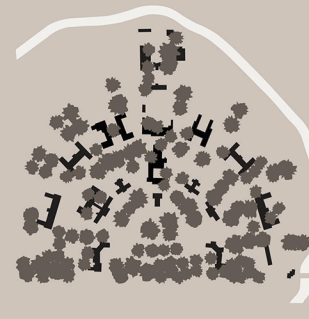
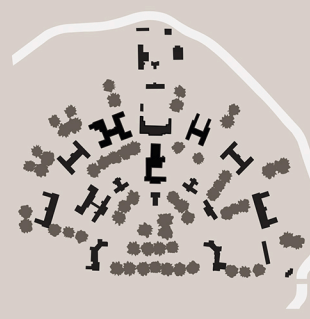
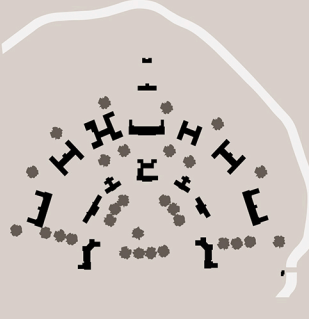
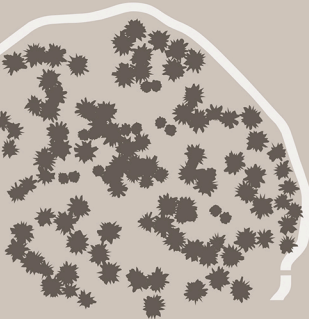
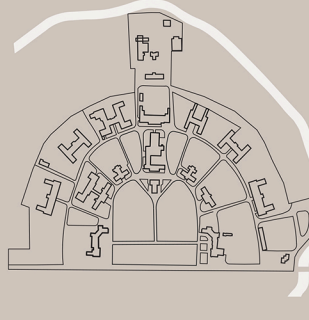
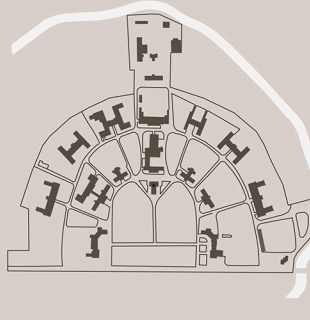
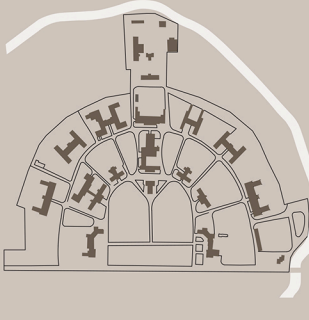
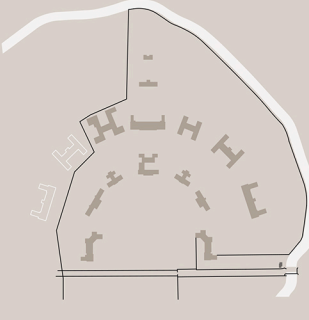
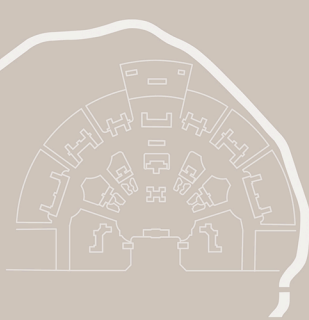

scansione modulare

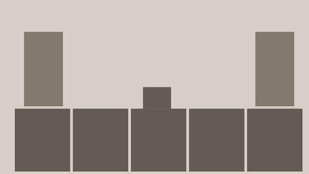

scansione modulare



perdita della simmetria
perdita della scansione modulare

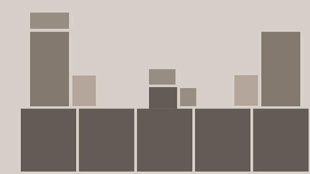

perdita della simmetria
perdita della scansione modulare

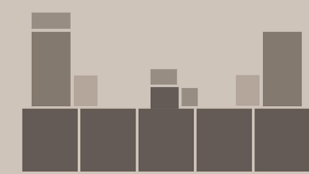

perdita della simmetria
perdita della scansione modulare

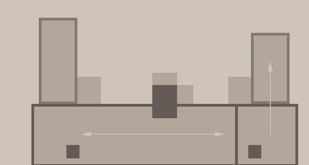
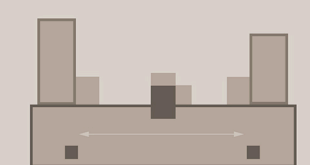
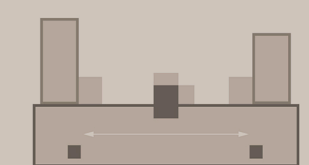
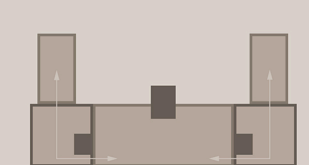

EX OSPEDALE PSICHIATRICO DI ROVIGO

INTERPRETAZIONE STORICO-CRITICA

LABORATORIO DI RESTAURO
professoressa Emanuela Sorbo - Arch. Lela Signorelli - Arch. Eva Rimondi

Giulia Stella276478
Silvia Secchiero276534
Erika Bolzonello276625
Matteo Pozza276532

I
- -
U
- -
A
- -
V