



The buildingsite is located on the former Renault plant along the Seine.



Situated right at the new park with great views on the Seine.



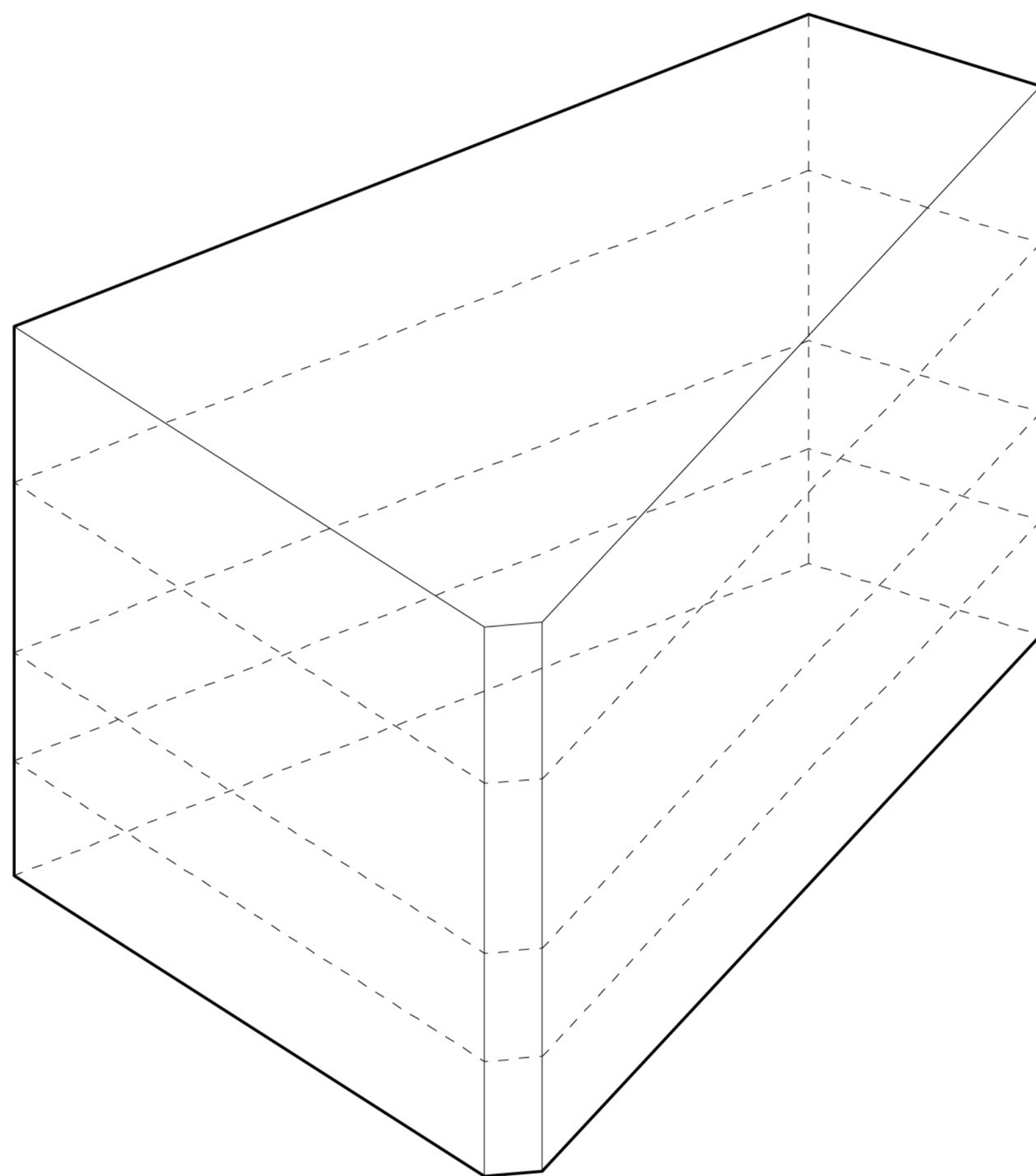

We wanted the building to be perceived as a single clear volume. We divided the volume horizontally according to the plotrules and the direct urban fabric.

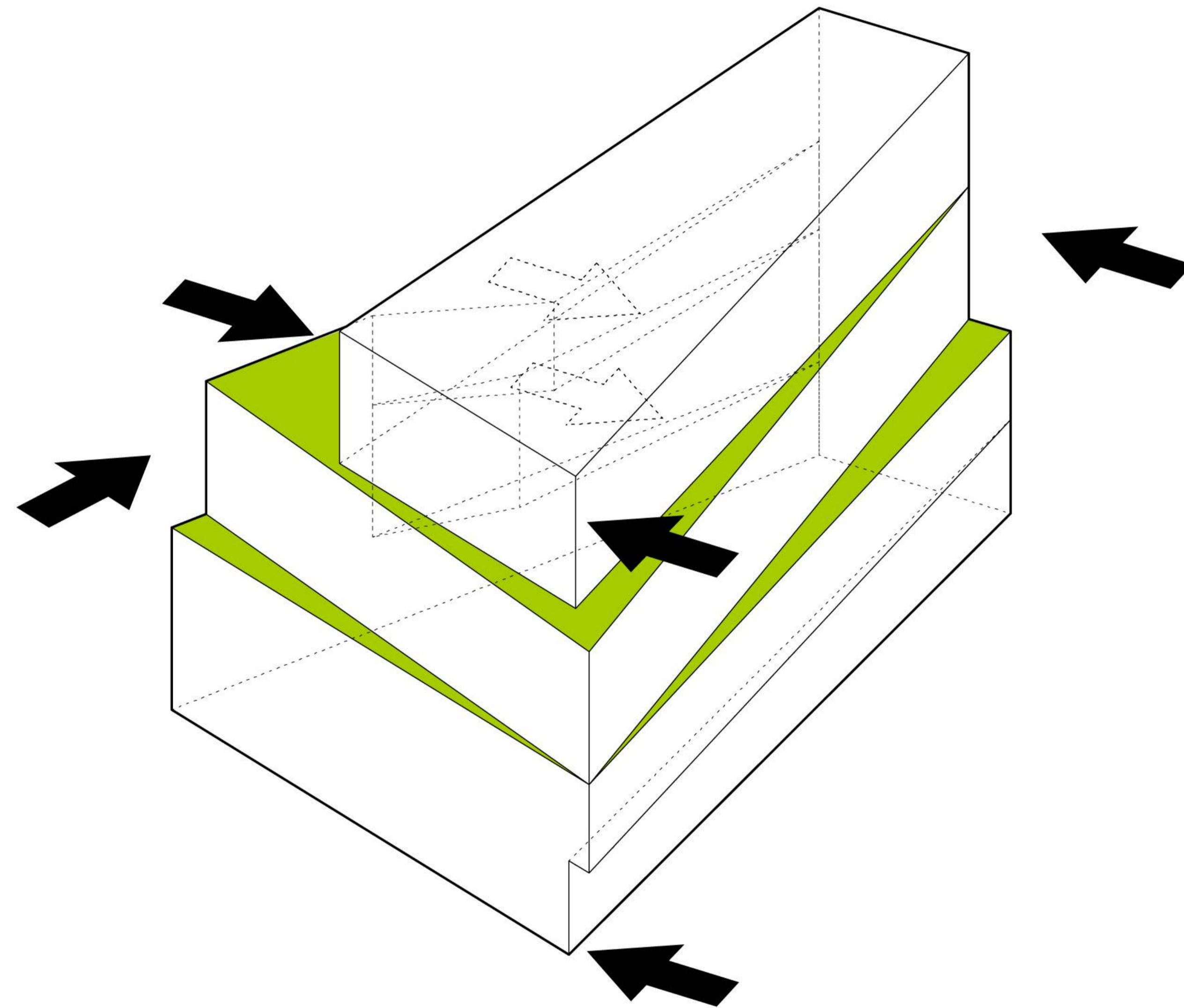

The volume will be pushed back, creating setbacks for terraces.
Resulting in a clear and recognizable building





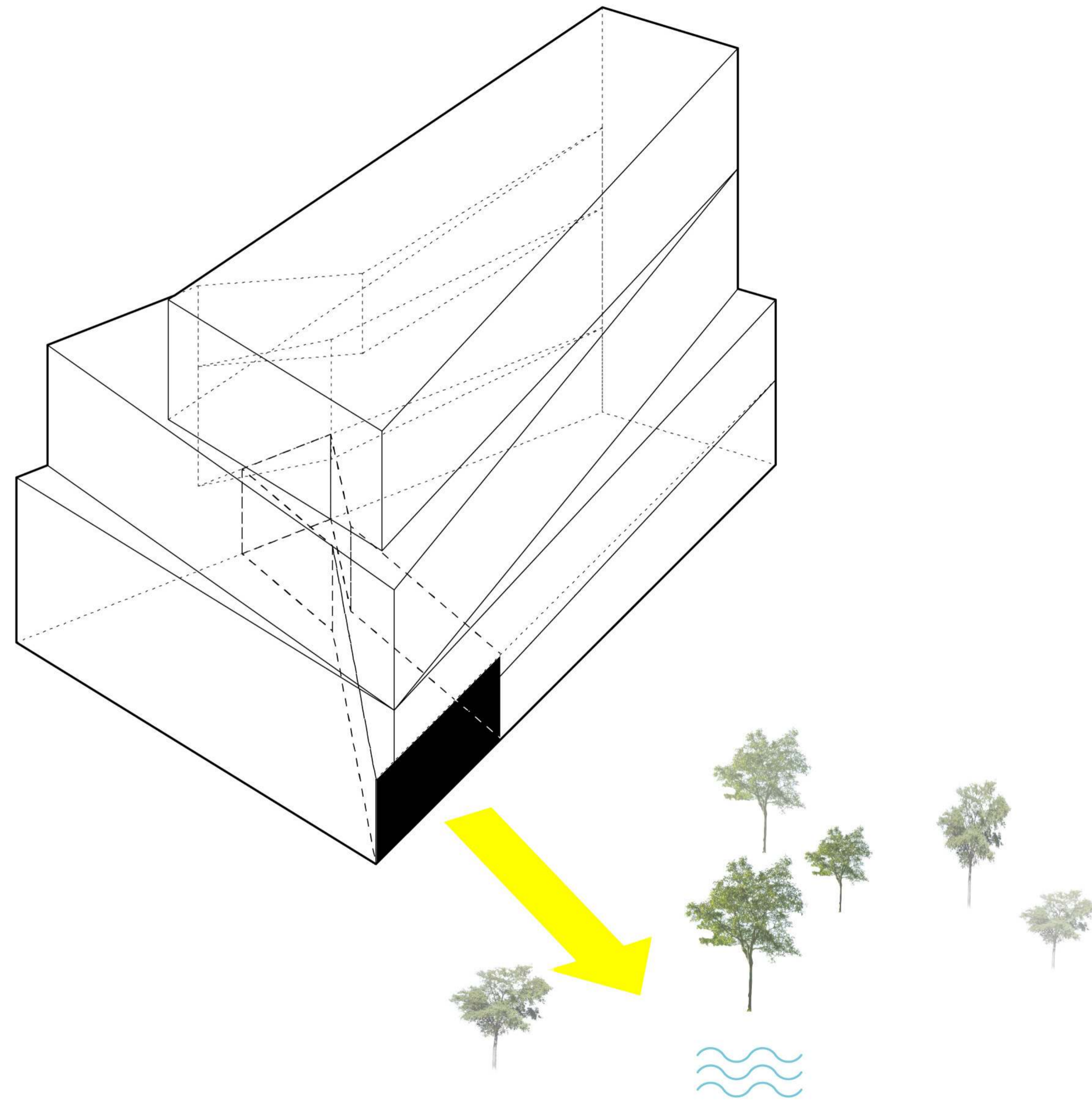

The entrance will be orientated on the park ...



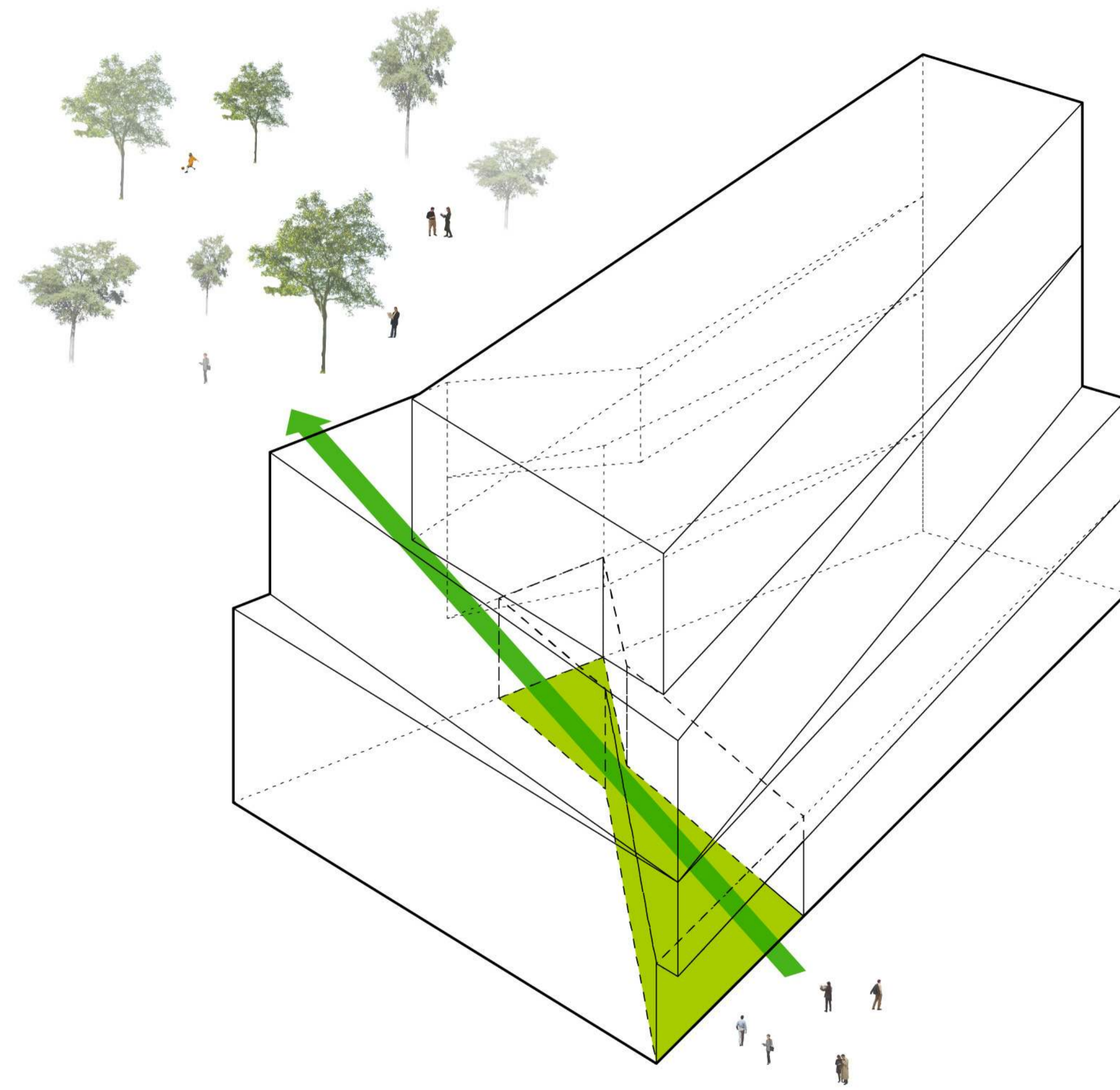

... and connected with the public space and inner court.



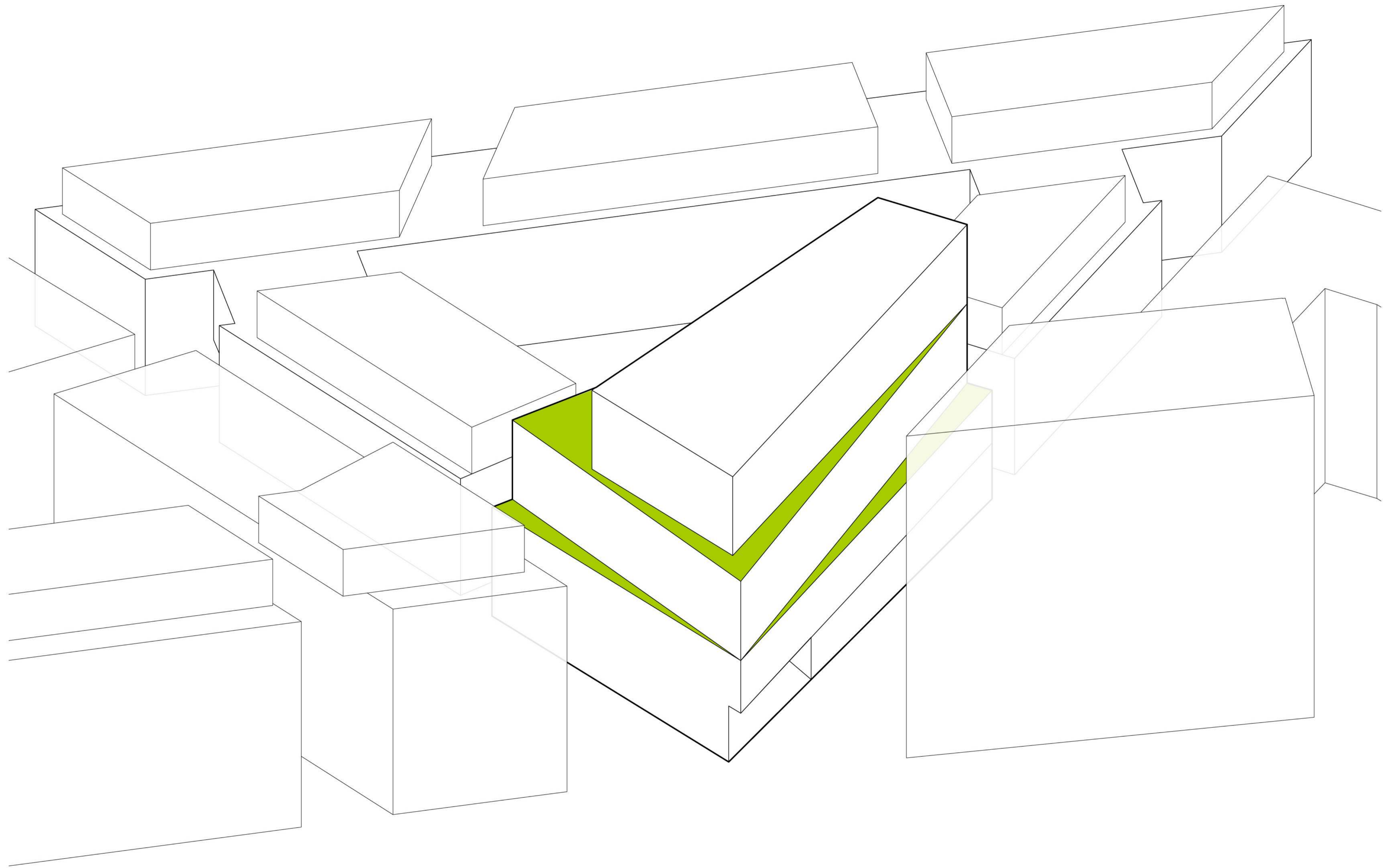

The volume scales down to the size of the housing developments behind, without losing its iconic volume at the park side.







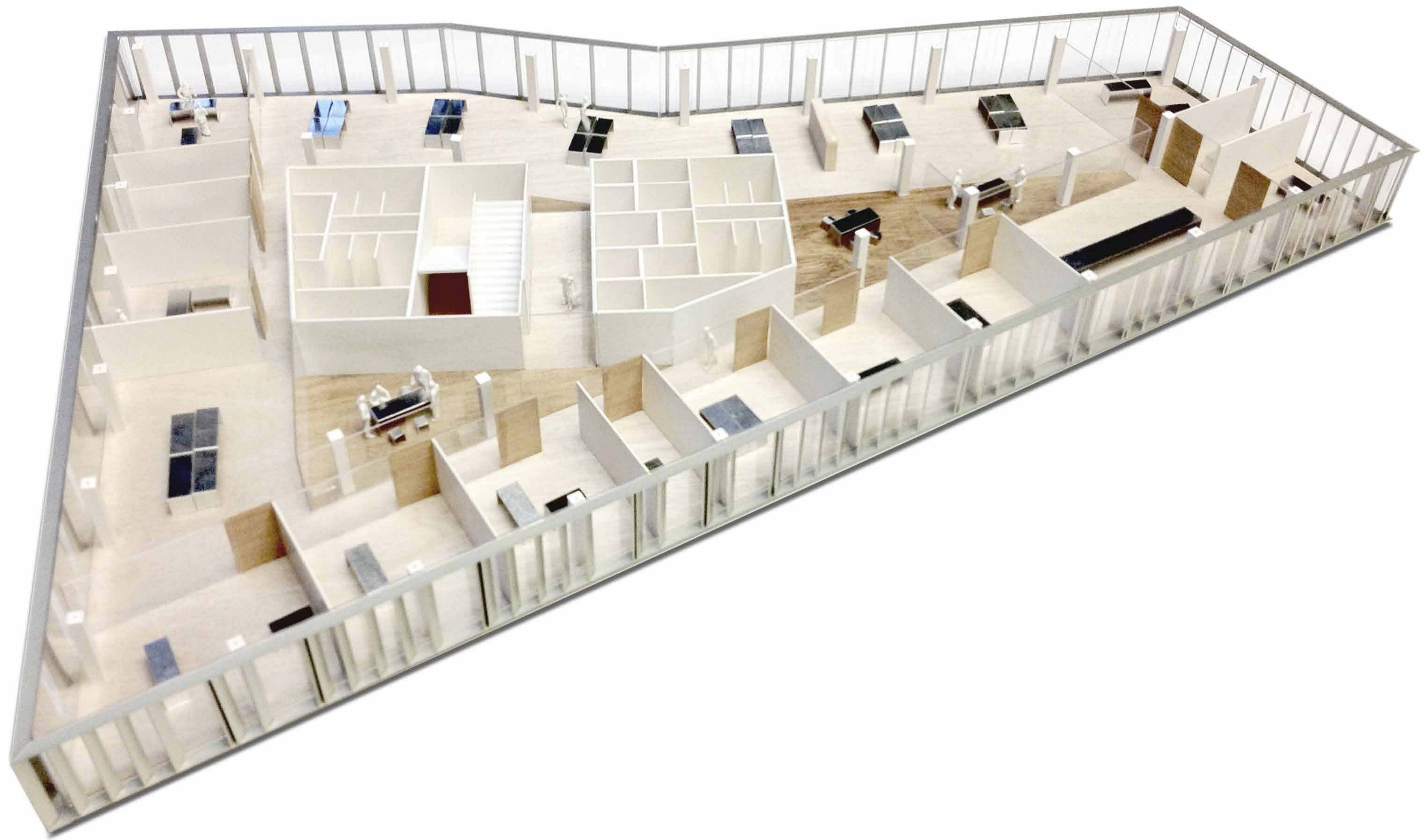

Typical plan



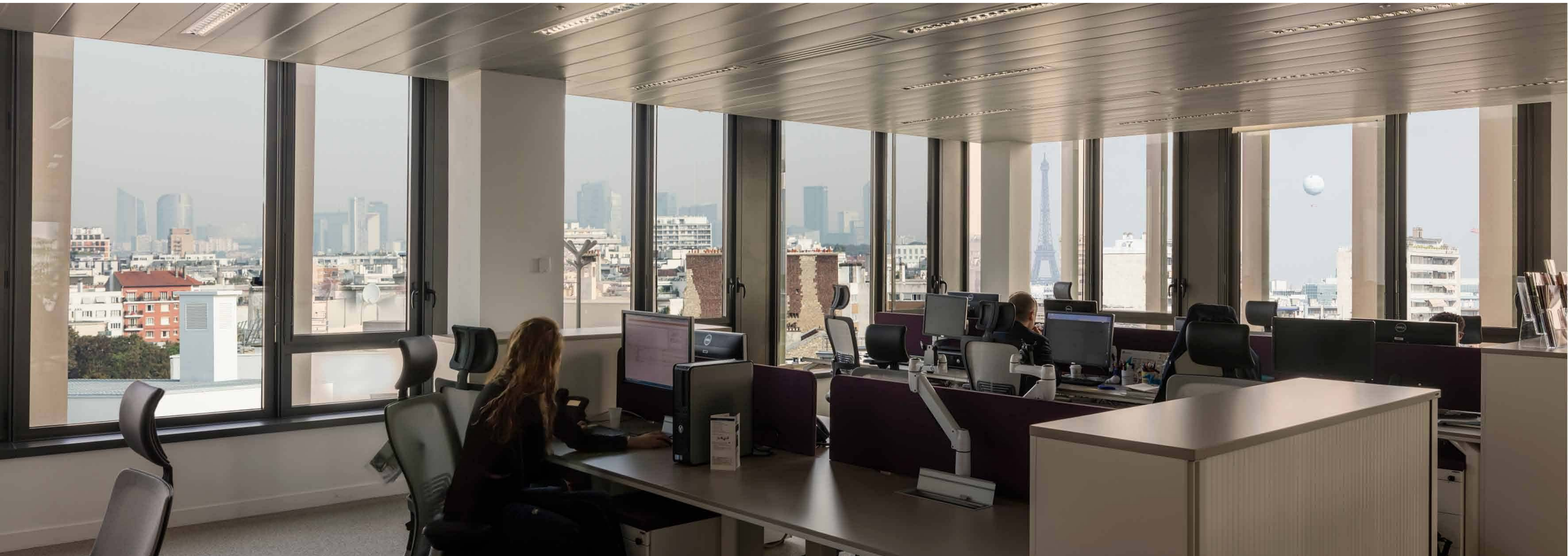

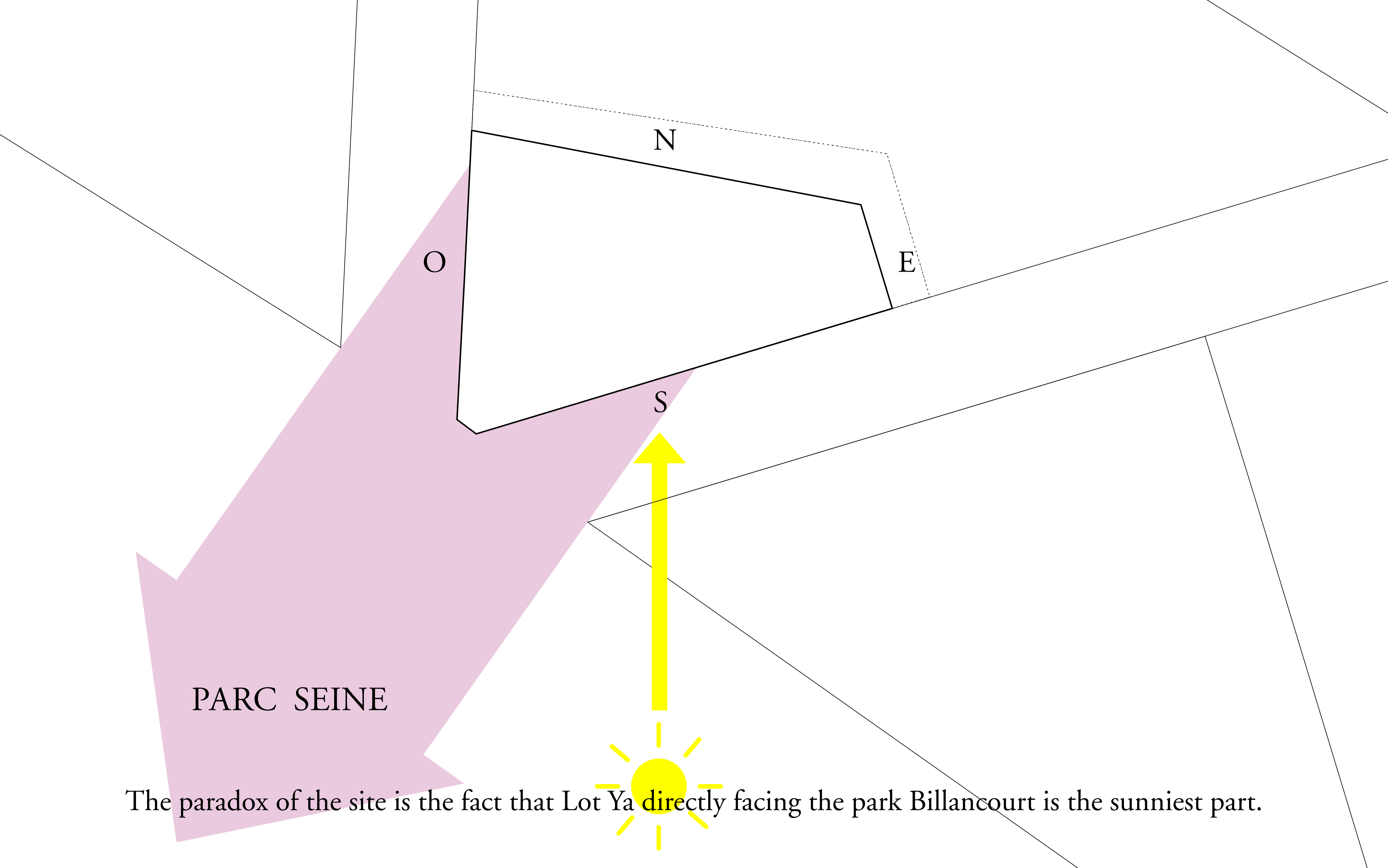

PARC SEINE

The paradox of the site is the fact that Lot Ya directly facing the park Billancourt is the sunniest part.

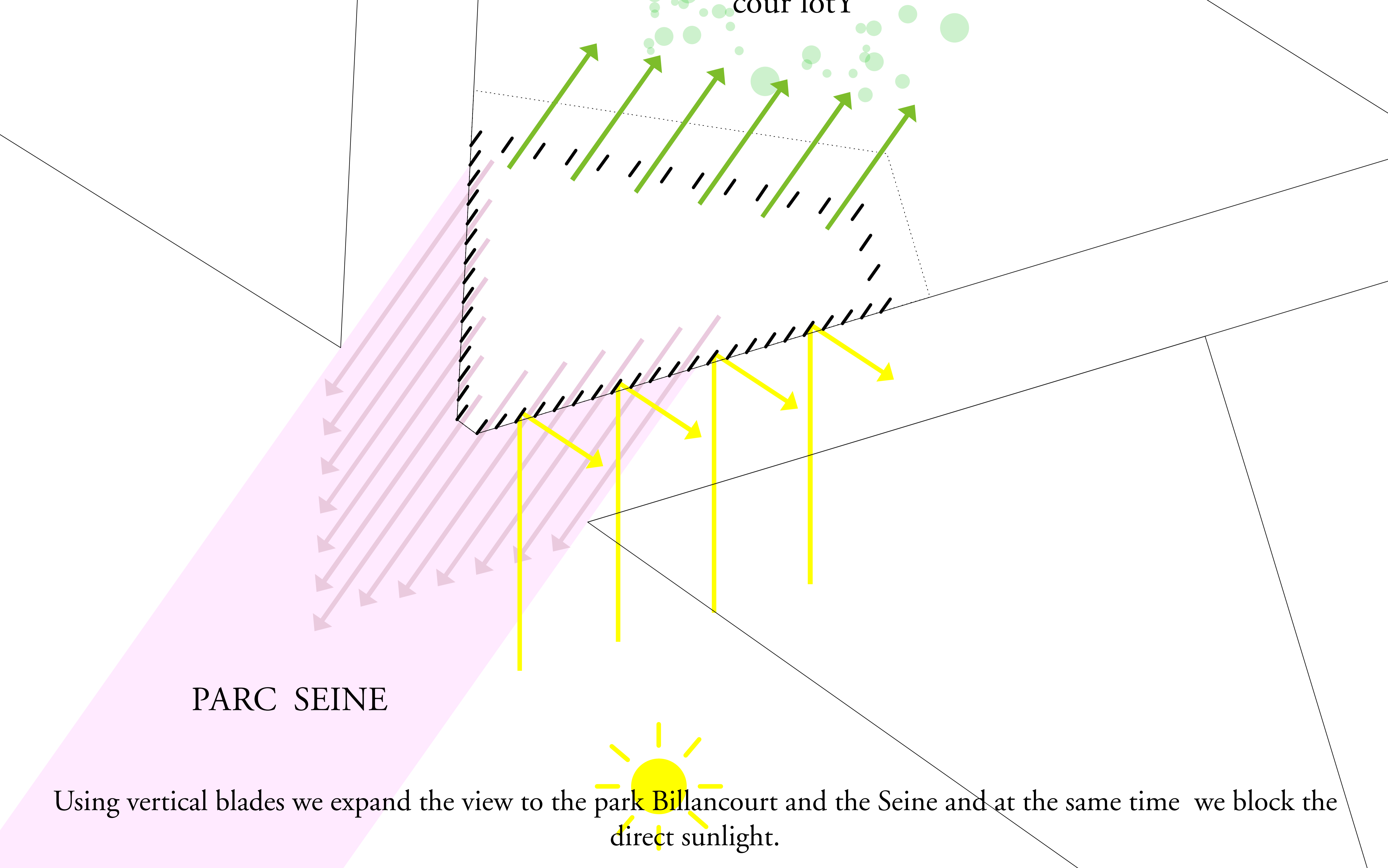

COUR LOT 1

PARC SEINE

Using vertical blades we expand the view to the park Billancourt and the Seine and at the same time we block the direct sunlight.

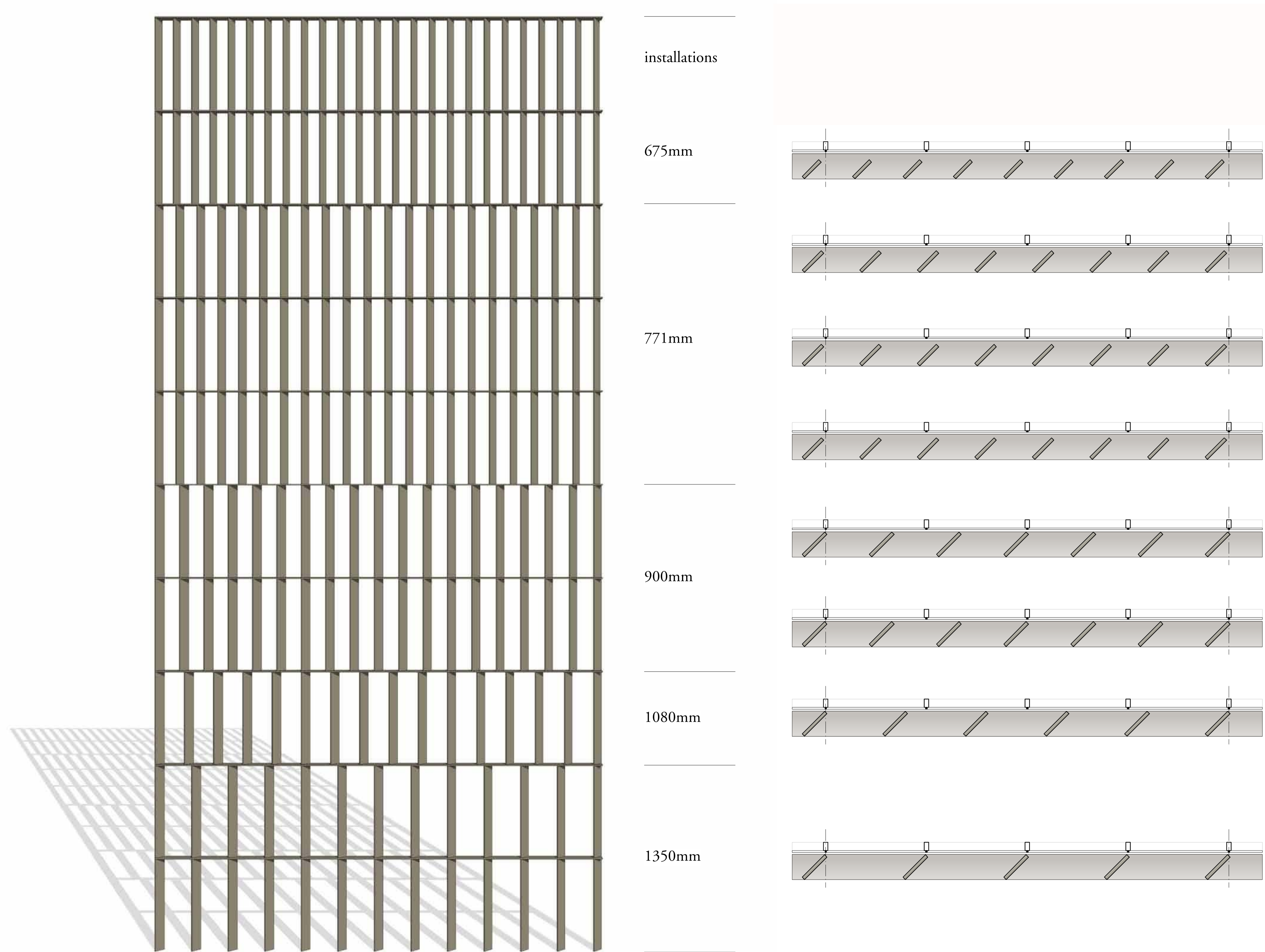

Principal detail of the facade.
The facade closing down in rhythm to the top blocking the sun.

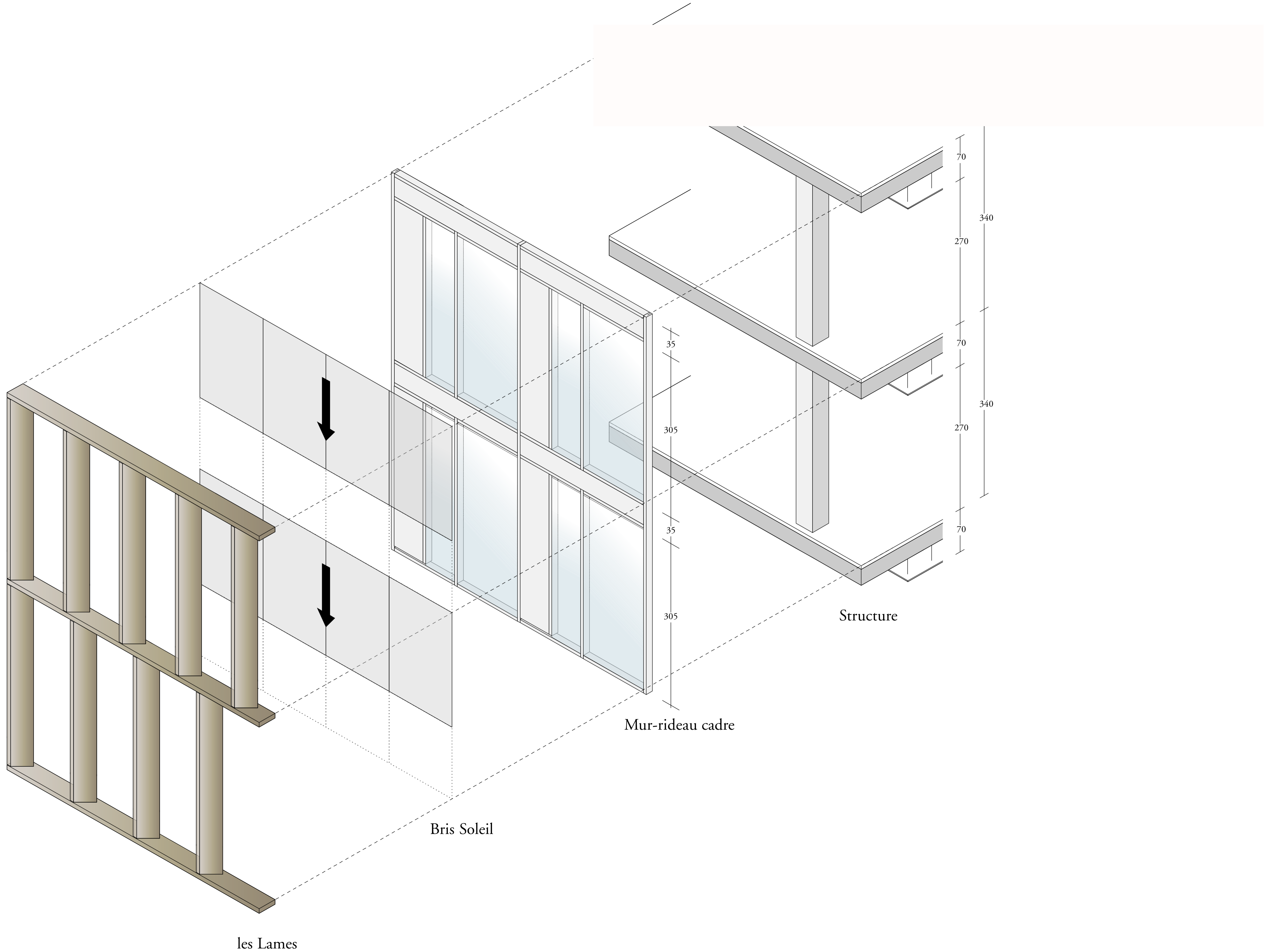





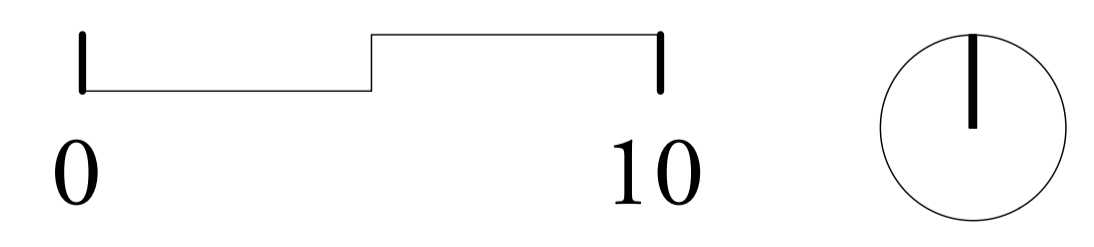
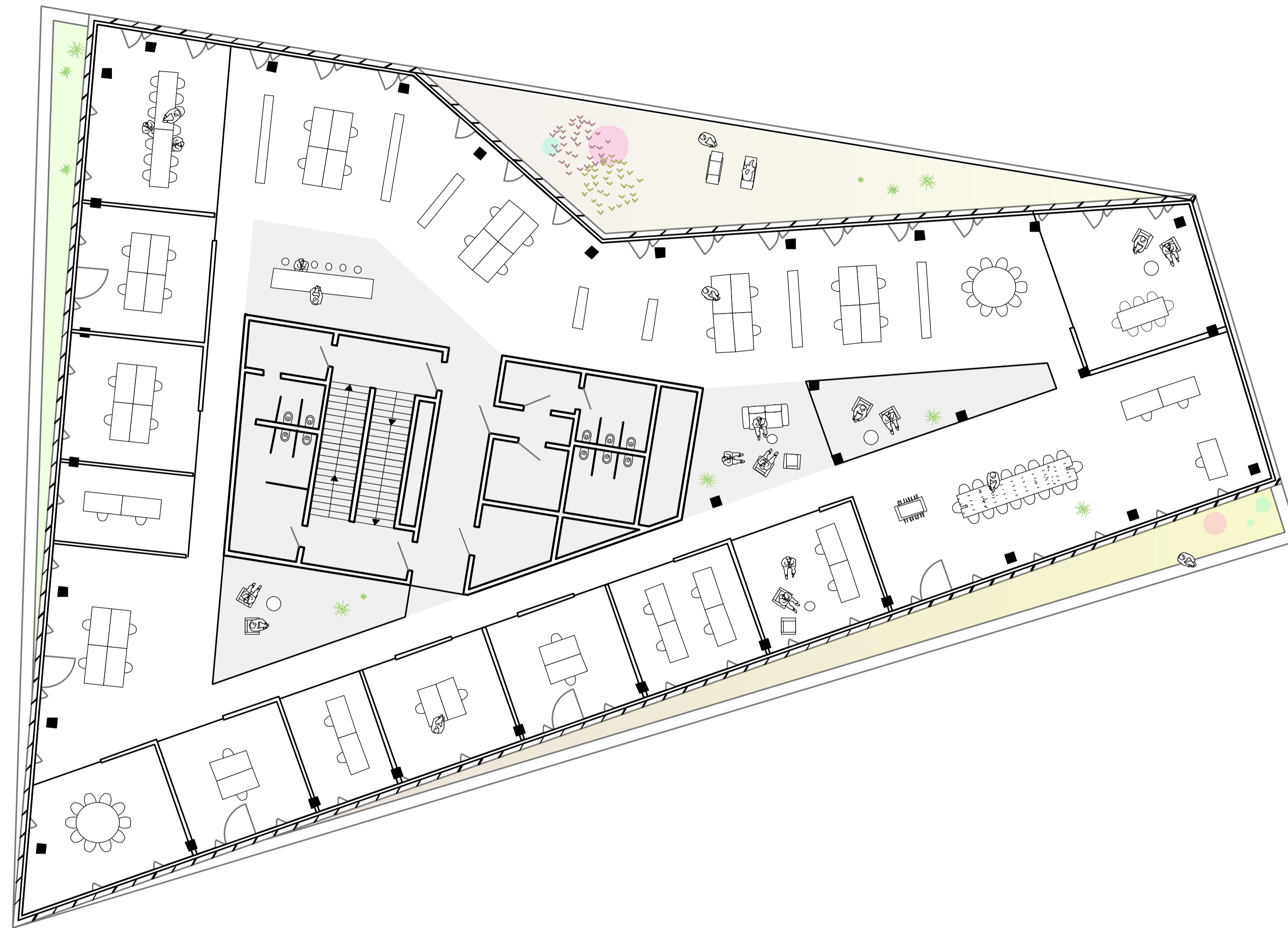

Typical floorplan



 Boursorama
Banque

 Boursorama

