

EXPLODED AXONOMETRIC OF GALLERY SYSTEMS

roof battens profile and pattern studies developed in GC - tied to secondary geometry roof model.

roof membrane related to roof surface GC model for pricing and installation templating.

wood frame and roof diaphragm were exported from GC to excel spreadsheets to serve as info to contractor on each unique compound cut. roof panels exported as 2d plan within documents for pricing and field construction

jumbo panel IGU 1 3/4" thick: panel geometry exported from GC for pricing and fabrication, digitally fabricated and pre assembled in China

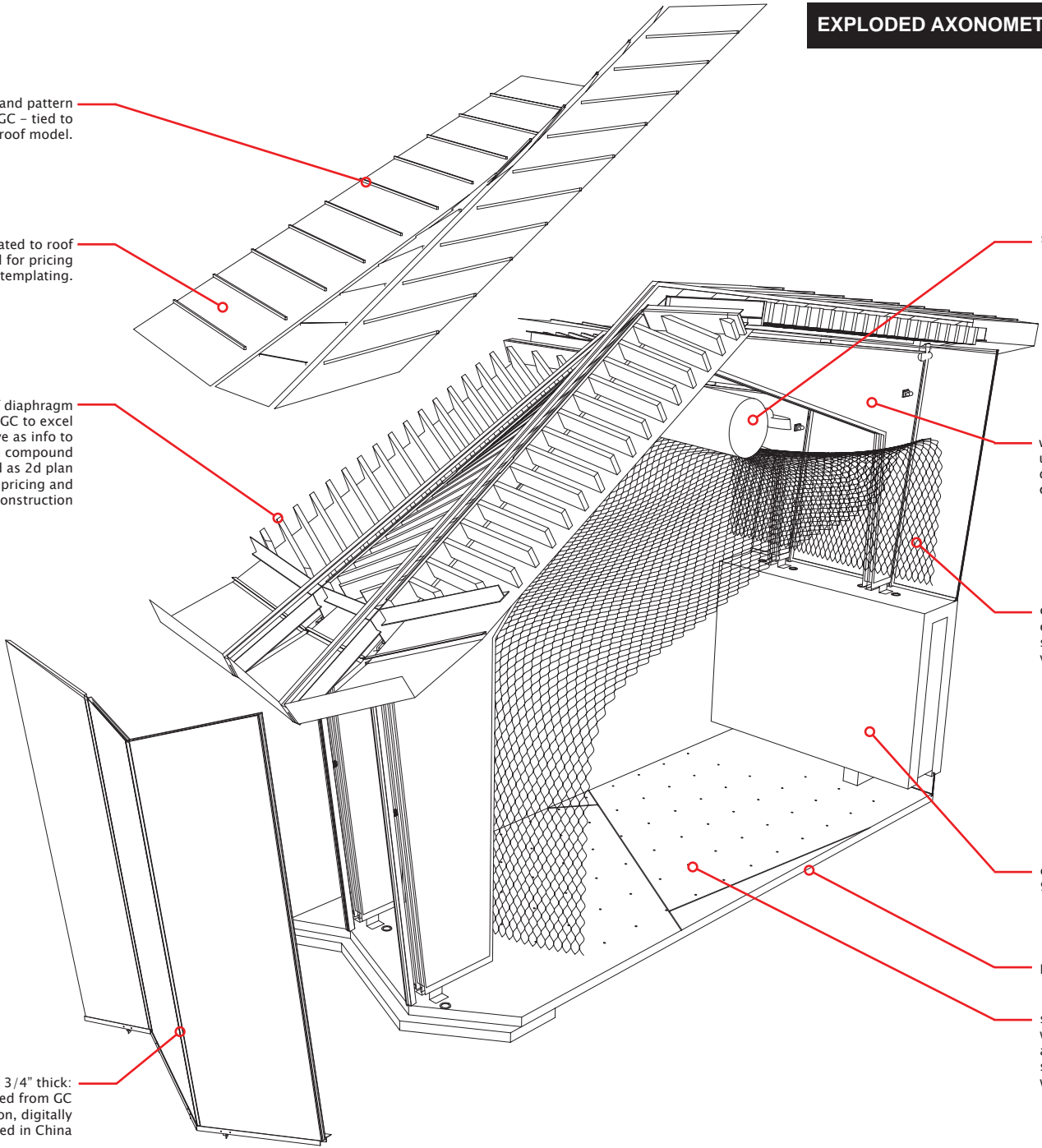

spiral duct

weathering steel frames, each with unique context development profile digitally fabricated and fully erected in china prior to shipping to the site.

custom wire mesh, developed in GC, custom fabricated by design team. supports change within the gallery volume

concrete 'beam' - massive 9ft x 3ft x 106ft

pigmented concrete slab

stainless steel anchors to accept tie out with emergent systems. anchor count and location integrated into GC floor slab model for cost and coordination with systems