

General Notes
 1. Do not scale drawings. Dimensions govern.
 2. All dimensions are in millimetres unless noted otherwise.
 3. All dimensions shall be verified on site before proceeding with the work.
 4. Pardini Hall shall be notified in writing of any discrepancies.
 5. Any areas indicated on this sheet are approximate and indicative only.

IMPORTANT NOTE:
 THIS DRAWING REPRESENTS THE VISUAL DESIGN INTENT ONLY. THIS IS NOT CONSTRUCTION OR SETTING OUT INFORMATION.
 TO BE READ IN CONJUNCTION WITH THE TECHNICAL REFERENCE SHEET (TRS) AND SPECIFICATION.

04	27-10-16	Per preventivo con Capitolato
03	04-08-16	Aggiornamento
02	25-04-16	Per preventivo con Capitolato
01	11-03-16	For Information
00	08-02-16	For Information
Rev	Date	Reason For Issue

Key Plan

Architect
 Pardini Hall Architecture
 223a Portobello Road
 4 Folly Mews
 London
 W11 1LU
 tel 020 7 2434205
 www.alipsdesign.com

Client **Pardini**

Project **Volpi**

Title **Proposto Piano Tetto**

Project No.	Scale	Date	Drawn By
A123	1:50	12-12-15	RH
Number	Revision		
A1014			04

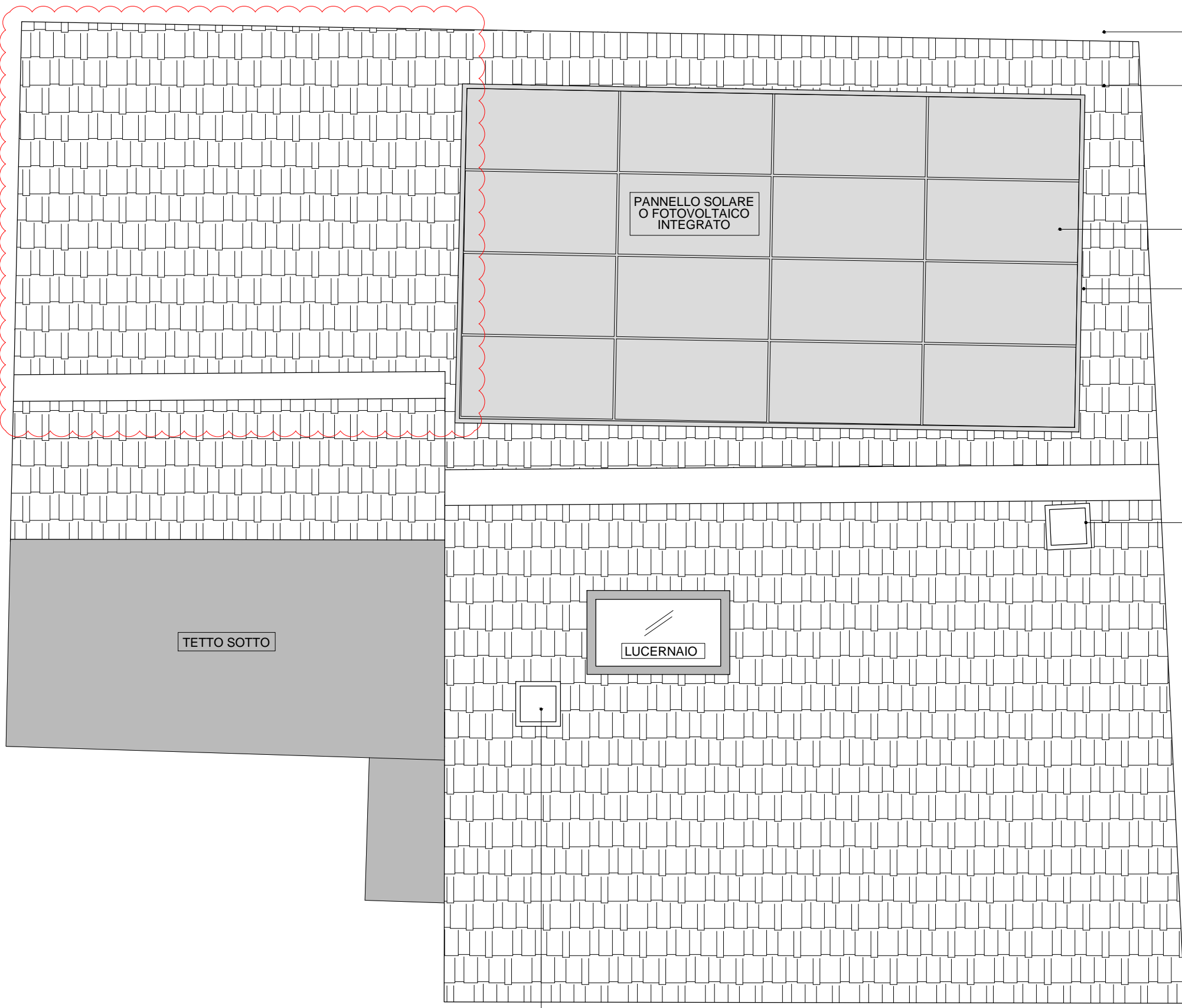

GRONDAIA

TETTO

PANNELLO SOLARE O FOTOVOLTAICO INTERGRATO

IMPERMEABILE

COMIGNOLO

TETTO SOTTO

LUCERNAIO

COMIGNOLO