

- General Notes:
1. Do not scale drawings. Dimensions govern.
  2. All dimensions are in millimeters unless noted otherwise.
  3. All dimensions shall be verified on site before proceeding with the work.
  4. Part of this shall be notified in writing of any discrepancies.
  5. Any notes indicated on this sheet are approximate and for reference only.

IMPORTANT NOTE:  
THIS DRAWING REPRESENTS THE VISUAL DESIGN SETTING OUT INFORMATION.  
TO BE READ IN CONJUNCTION WITH THE TECHNICAL REFERENCE SHEET (TNS) AND SPECIFICATION.

Rev	Date	Reason for Issue
02	12-27-17	For Information
01	08-25-16	For Information
00	08-25-16	For Information

Project No.	Scale	Drawn By
A123	1:50	RM
Number	Revision	Drawn Date
A1058	02	

Architect  
Pardini Hall Architecture  
222a Puchelle Road  
4 Filly Mews  
London  
W11 1LU  
UK 020 7 244 4205  
www.pardinihall.com

Client  
**Pardini**  
Project  
**Volpi**

Project  
**Proposto**  
**Dettaglio**

Impermeabile

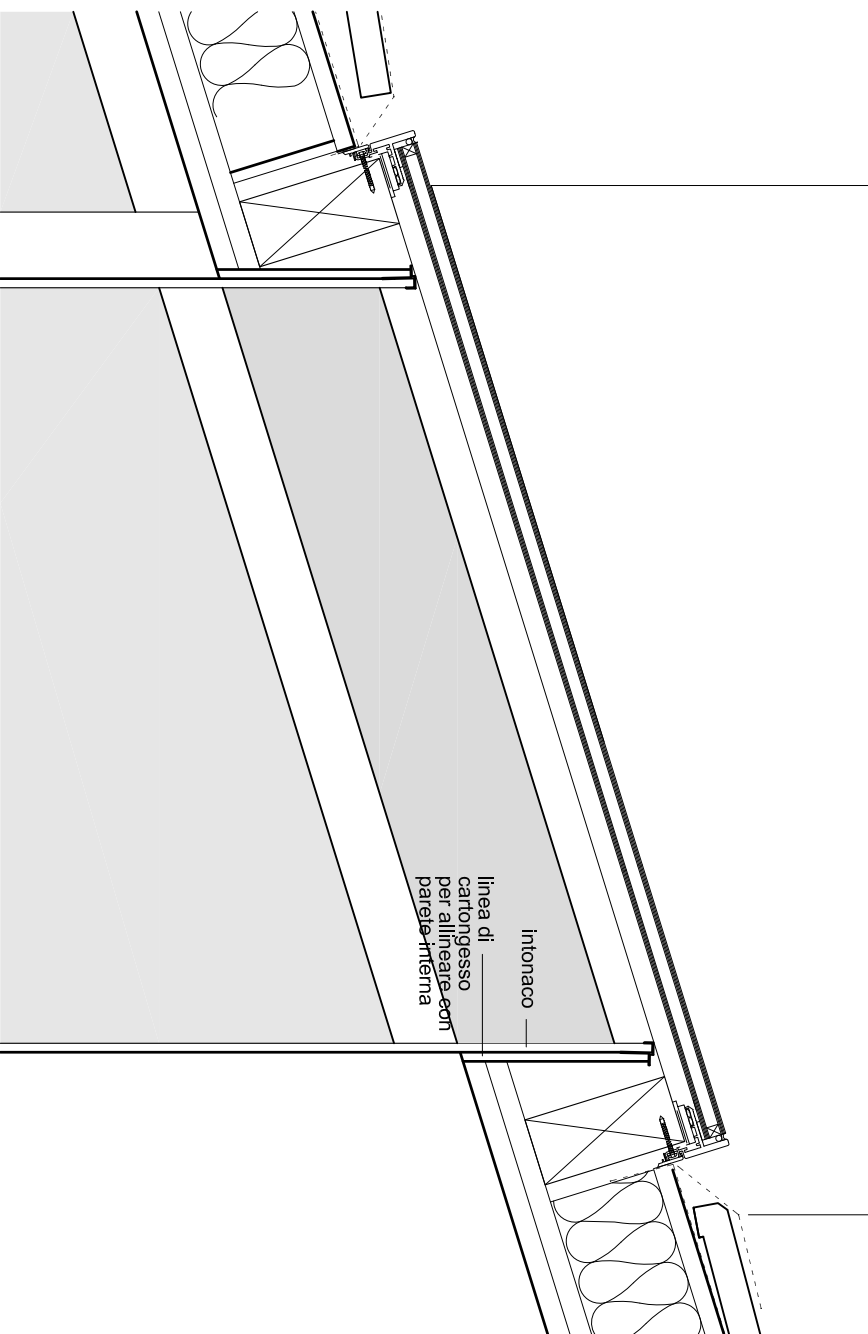

# 01 Dettaglio - Velux

Scale 1:10 @ A3

pannello solare integrato

barriera al vapore

impermeabile (pannello solare)

manto di copertura in cotto toscano (coppi ed embricci)

impermeabile

pannello isolante ventilato per coperture

grondata

ventilazione

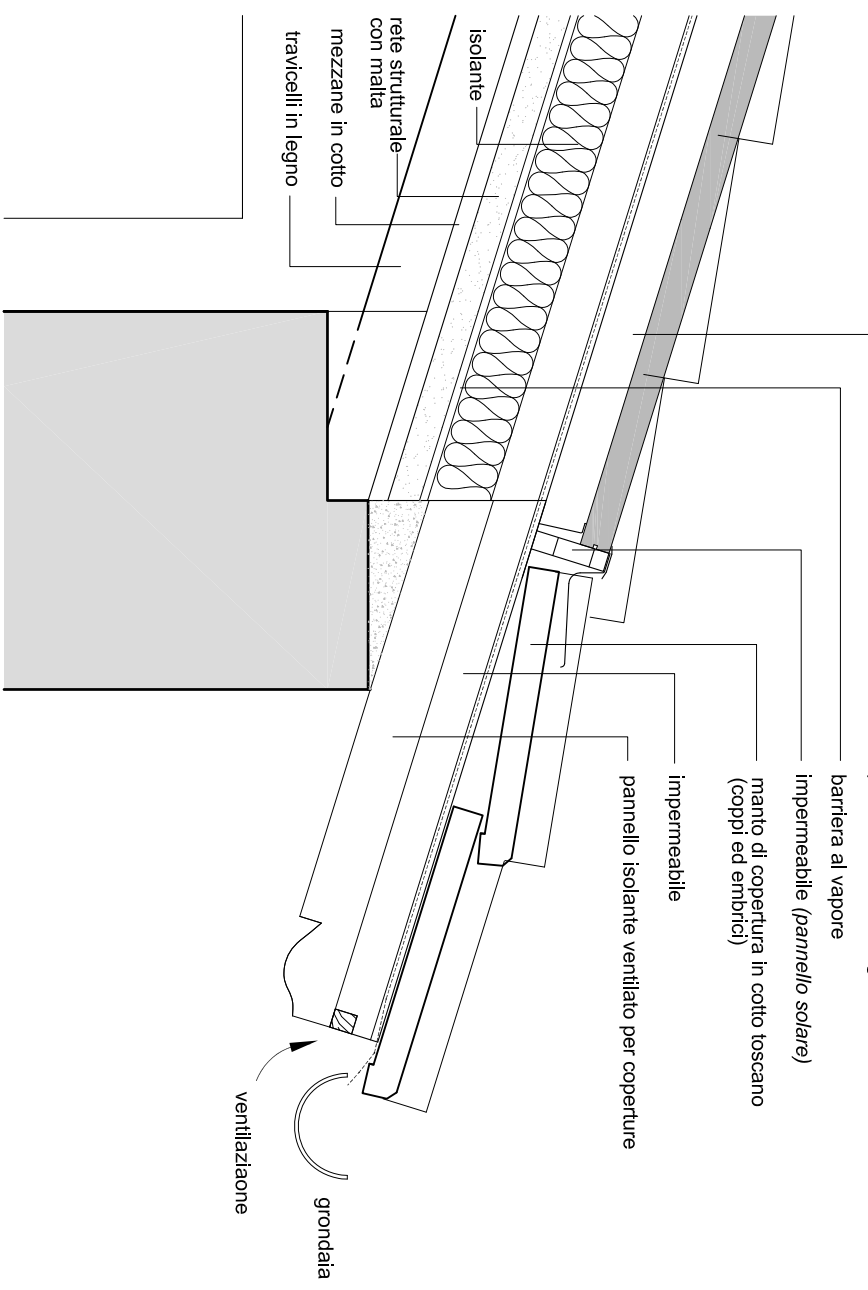

# 01 Dettaglio - Gronda

Scale 1:10 @ A3

travicelli in legno

mezzane in cotto

rete strutturale con malta

isolante