

**PREVIOUS PROPOSAL**  
 - Concept: Front and back blocks with courtyard in middle.

- TYPICAL RESPONSE**
- 2 blocks Front and Back.
  - Continuation of the street scape
  - 2 cores.
  - potentially dark and underused courtyard in middle.
  - Most flats only have single aspect.

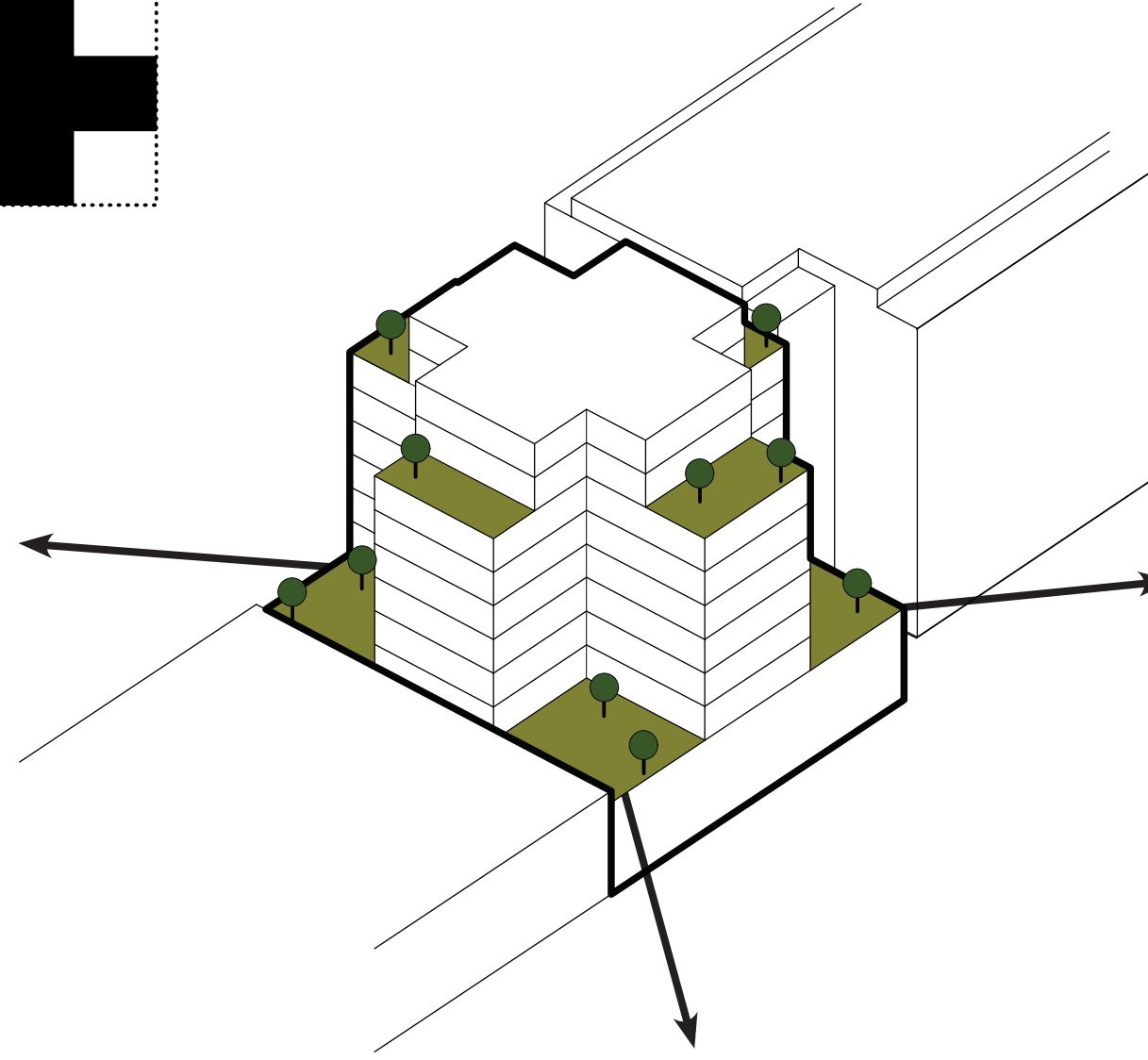
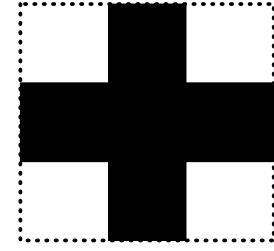

**RESPONSE**  
 - Cross formation creates more courtyards, with more natural light and views of the city.

- ALTERNATIVE RESPONSE**
- A cross with a central core.
  - 4 more intimate gardens with visual connections to the city.
  - All flats have at least 2 aspects and some have 3.
  - All flats are corner units.

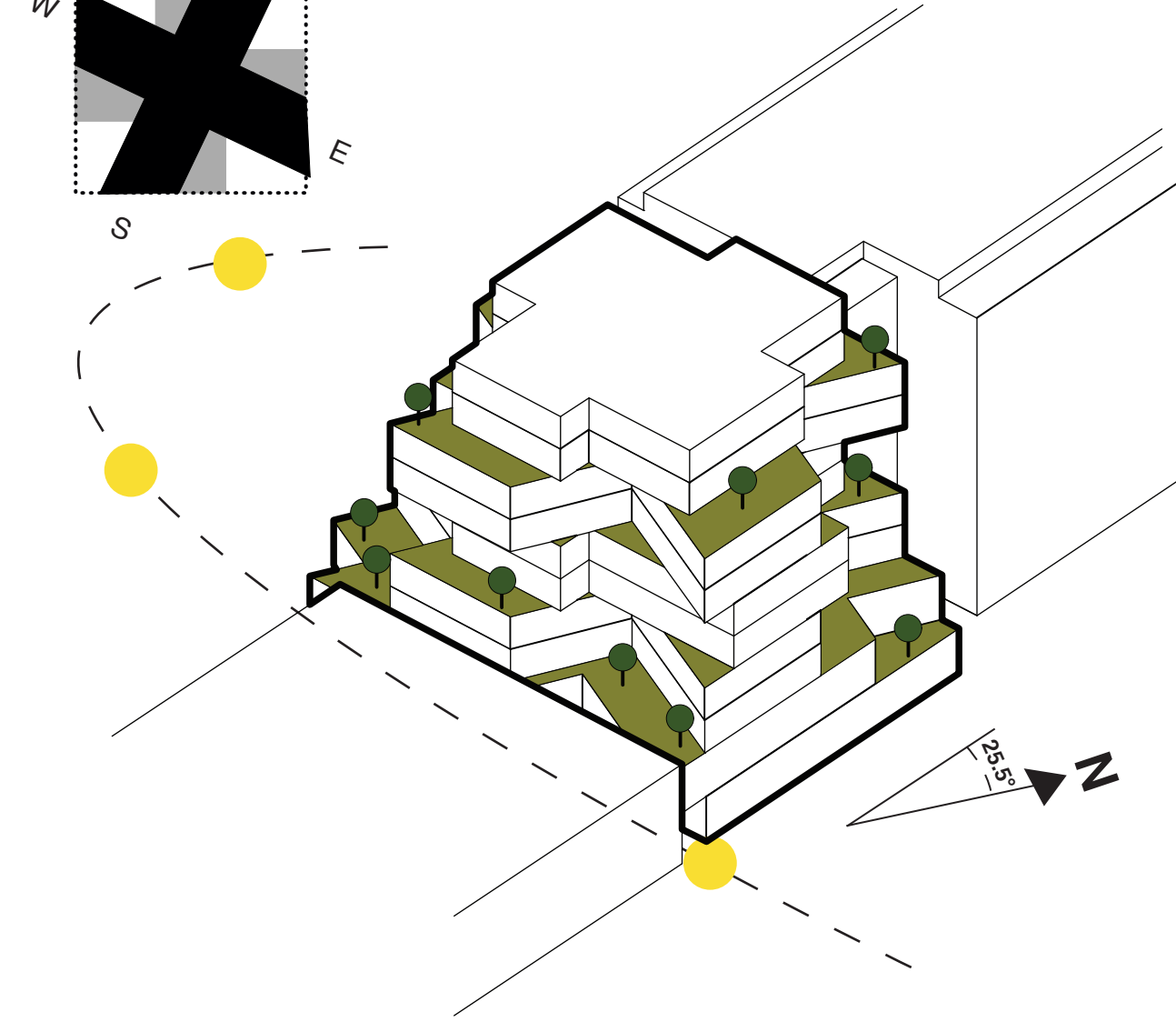
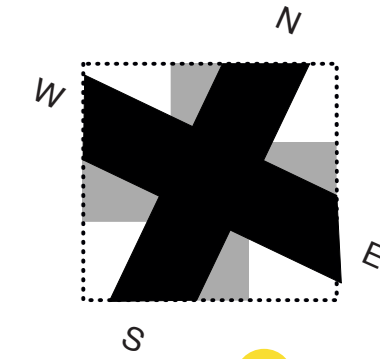

**TWIST**  
 - Twist to orientate blocks towards sun.  
 - Orientating every other block creates generous sunny terraces.

- TWIST**
- Twist most of the floors towards north offering better sunlight angles for the flats at the north of the site.
  - By only rotating half of the floors generous terraces are created as the form intersects itself.

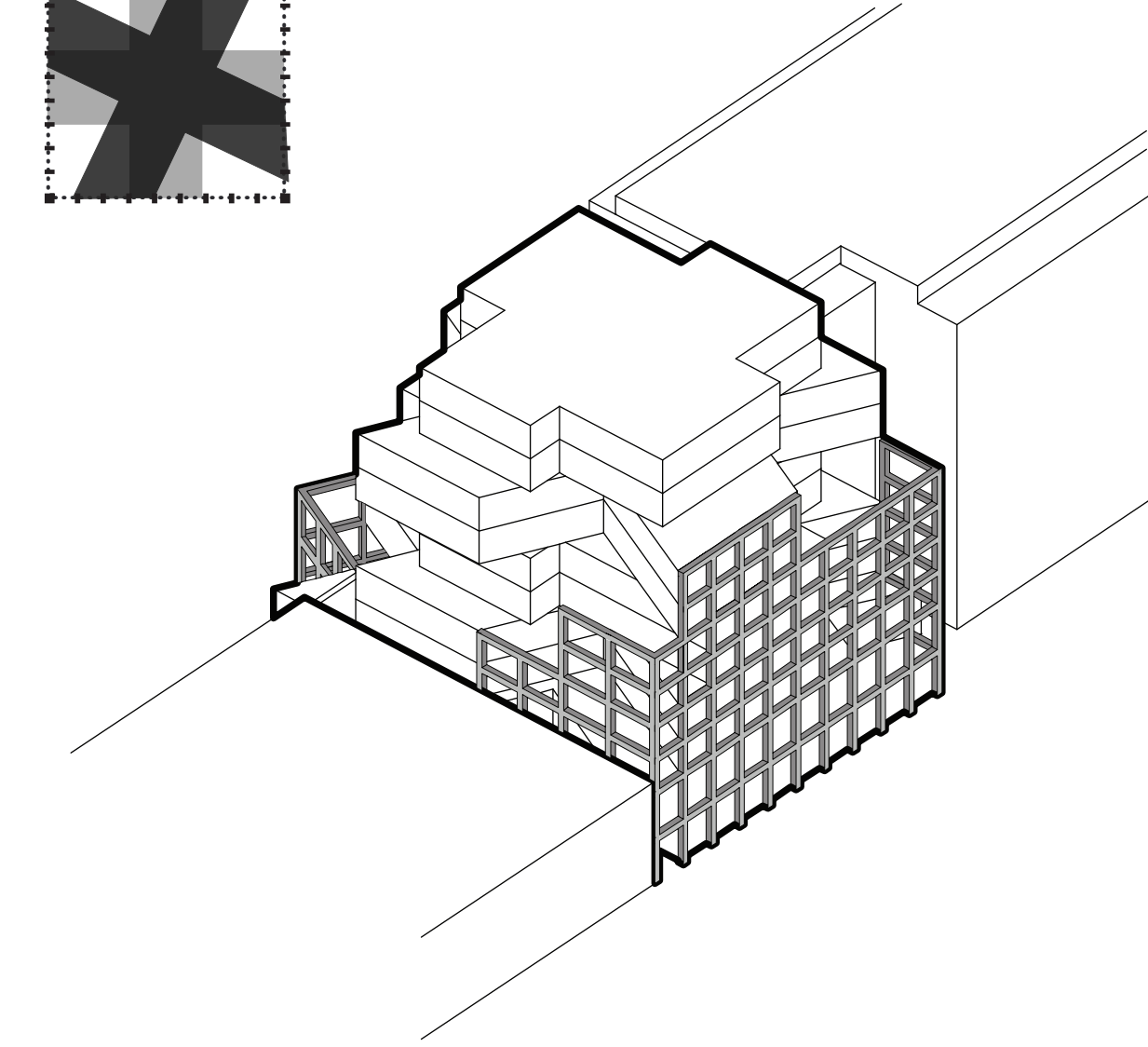
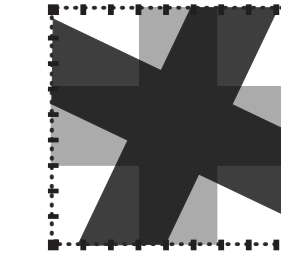

**URBAN GESTURE**  
 - The Grid  
 - Reinforces the streetscape  
 - Creates defensible space  
 - Open at the back

- THE SCREEN**
- A grided brick screen wraps the outside of the form creating an intimate spaces for those inside and a simplifying the perceived form for those outside thus "completing" the street.
  - Where the grid meets the edges of the building large picture windows and terraces are created.
  - The screen diminishes at the back in response to the natural canalside landscape.