



CITY CENTER ON THE 22ND FLOOR



INTERIOR MUNICIPAL OFFICES DE ROTTERDAM, NL

PELGRIMSSTRAAT 5-B 3029 BH ROTTERDAM THE NETHERLANDS
 T +31 (0)10 244 01 93 F +31 (0)10 244 99 90
 E MAIL@GROUPA WWW.GROUPA.NL



De Rotterdam can be regarded as a vertical city, when it comes to height, size and number of 'residents'. The sequence of public spaces, provides the user orientation, structure and interaction. Applying these urban qualities to the new work environment, fits perfectly into the New Rotterdam Ways of Work.



INTERIOR MUNICIPAL OFFICES DE ROTTERDAM, NL

CLIENT Municipality of Rotterdam
PROJECT ADRESS Wilhelminakade 177, Rotterdam
USE offices for the Municipality
TYPE interior
TASK building commission

TASK DESCRIPTION
 preliminary design, final design, design development, specifications, supervision, aesthetical supervision

AREA 44.000 sqm
STATUS completed
DESIGN 2012
START CONSTRUCTION December 2013
COMPLETION November 2014

PELGRIMSSTRAAT 5-B 3029 BH ROTTERDAM THE NETHERLANDS
 T +31 (0)10 244 01 93 F +31 (0)10 244 99 90
 E MAIL@GROUPA NL WWW.GROUPA.NL



INTERIOR "DE ROTTERDAM", IN THE MIDDLE TOWER



CONCEPT 'VERTICAL CITY'

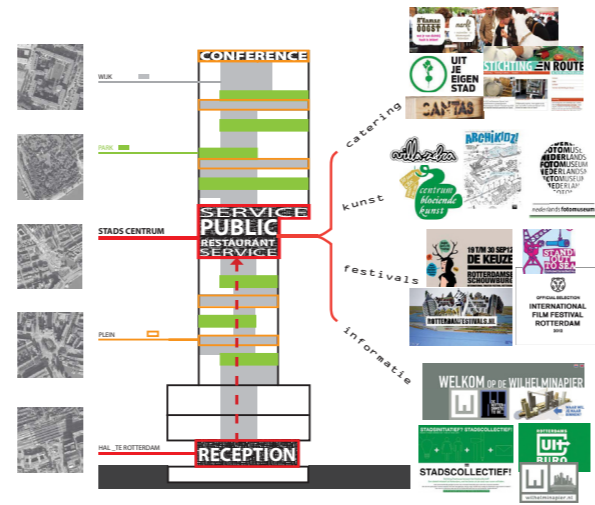

FLOORPLAN GENERIC OFFICE FLOORS - LOWRISE

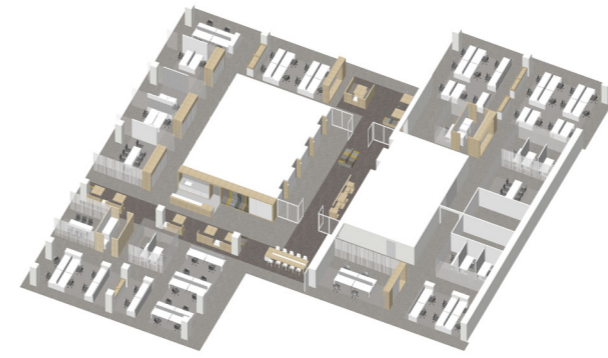

RESTAURANT ON THE 21ST FLOOR



IMPRESSION GENERIC OFFICE FLOORS



27TH FLOOR - MEETING SQUARE



CONCEPT



Together with Studio Makkink&Bey and Roukens+Van Gils, GROUP A designed the interior of the 33 storeys of De Rotterdam at the Wilhelmina Pier. This building, designed by OMA, will accommodate the Rotterdam municipal offices. The design features an interior that reflects a 'vertical city', which connects 'urban junctions' for collective use, meeting spaces and interaction. As part of the integrated design, the design offices were able to formulate their vision in an urban planning concept. The

generic parts of the work environment, such as normal work spaces, meeting areas and concentration rooms, form the 'neighbourhoods'. The specific functions, such as conference rooms, lounge areas, meeting areas for specific purposes, quiet zones and service facilities, form the 'city squares' and 'parks'. The offices each applied their own design efforts to elaborate the various sections of the space. The two design approaches create a layered effect and give the design a dynamic feel.

ADDITIONAL PROJECT INFORMATION



TEAM

Folkert van Hagen, Maarten van Bremen, Adam Visser, Birgitta Rottmann, Raymond Leentvaar, Brigitte van der Tuin

ICW Studio Makkink & Bey

CONTRACTOR BAM Utiliteitsbouw, Rotterdam

ADVISOR BAM Advies & Engineering

SPECIAL FURNITURE Smeulders Interieurgroep