



Press release 04.09.2018

Guangxi Culture & Art Center

Venue for cultural events, and new landmark of Nanning, China

The Guangxi Culture & Art Center in the Nanning metropolis in southern China has been ceremonially opened. Following the completion of similar projects in Tianjin, Chongqing und Qingdao, this is the fourth grand theater to be completed by von Gerkan, Marg and Partners (gmp) in China. Nanning, the capital of Guangxi province, now has the benefit of this type of venue which, with its wide-ranging cultural events program, is very popular in China and thus adds to the city's attractiveness. Following the completion of Nanning's trade exhibition and conference center, this is gmp's second building for the city that adds its distinct appearance to the city's skyline.

For further information please contact:

Claudia Tiesler
T +49.40.88 151 123
ctiesler@gmp.de
www.gmp.com

PR & Communications
Elbchaussee 139
22763 Hamburg
Germany

T +49.40.88 151 0
F +49.40.88 151 177
communication@gmp.de
www.gmp.com

The Guangxi Culture & Art Center in Nanning has opened its doors. It is a grand theater of the kind that is very popular in China and serves as a venue for a wide range of musical and cultural programs: in addition to classical works in the European tradition of operas, events include concerts, musicals, and gala shows.

Three concert halls have been arranged as separate volumes on a natural stone-clad plinth building that accommodates the service functions. The opera house to the south-west with its 1,600 seats and a 600 square-meter stage opens out to a newly created lake. Following the tradition of classical opera houses, the seating has been laid out in the shape of a horseshoe. The stalls and balconies are reached via a foyer and an arrangement of stairs. Softly curved wood-paneled surfaces create a warm interior atmosphere, and the reverberation time of 1.5 to 1.8 seconds provides ideal acoustic conditions. The concert hall with its 1,200 seats is located on the eastern side and has been designed as an oblong hexagon with a rounded stage area. It features an organ with 64 registers and is therefore suitable for a wide repertoire of musical performances ranging from chamber music to symphony concerts by composers like Bruckner. Wide wooden stripes on walls and ceilings provide a certain rhythmic order to the visual appearance. The smallest hall, with 550 seats, is a multi-functional hall and is located to the north. Its electronically controlled acoustics ensure that the reverberation time can be adjusted with infinite variability. Different stage scenarios for music, ballet, and theater performances as well as fashion shows can be created with the help of lift platforms.

The three venue buildings are unified by a shared, seemingly floating roof. Similar to the facades, it appears as a large structure of louvers, which has been constructed with a steel frame substructure and white folded aluminum panels as cladding. When viewed from the opposite bank of the River Yong or from the approach via Nanning Bridge, the radiant white shape of this outstanding culture center of Nanning and the Guangxi province appears confidently in contrast to its surroundings. Depending on the viewpoint, the silhouette of the building changes dynamically, evoking associations with the natural karst formations that are so typical of the Guangxi landscape.

Design Meinhard von Gerkan and Nikolaus Goetze with Dirk Heller

Project manager Dirk Seyffert

Competition design team Christoph Berle, Hanna Diers, Jessica Last, Mikael Stenberg, Wu Ziheng, Xu Xinling

Detailed design team Christoph Berle, Cai Feng, Maike Jäger, Liwen Knoll, Jessica Last, Holger Schmücker, Alexander Schnieber, Mikael Stenberg, Marcus Tanzen, Xu Xinling

Project management China Wu Di, Lin Wei, Wang Zheng, Pan Mei, Liu Yangjiao

Client Weining Ltd., Nanning, China

GFA 113,764 m²

Seats 1,600 (opera house), 1,200 (concert hall), 550 (multipurpose hall)

Partner practice in China ECADI, Shanghai & Shanghai Modern

Structural design schlaich bergemann partner GmbH, Stuttgart/Shanghai

Fassade consultants SuP Facade Design, Darmstadt/Beijing

Landscape design WES, Hamburg

Lighting design ag-Licht, Bonn

Media technology / Acoustics Müller BBM, Munich

Stage technology / Stage lighting Kunkel Consulting, Bürstadt

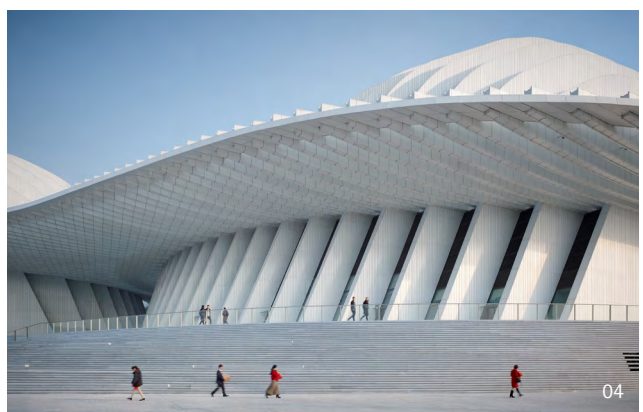

To download high resolution images use the following link: <https://www.gmp-architekten.com/news/press-release/>

Please note the advice for rights of use and copyright on the last page of this document.

01 Between concert hall and opera house © Christian Gahl
02 Aerial view © Christian Gahl

03 Southeast view © Christian Gahl
04 Flight of stairs leading to the opera house © Christian Gahl

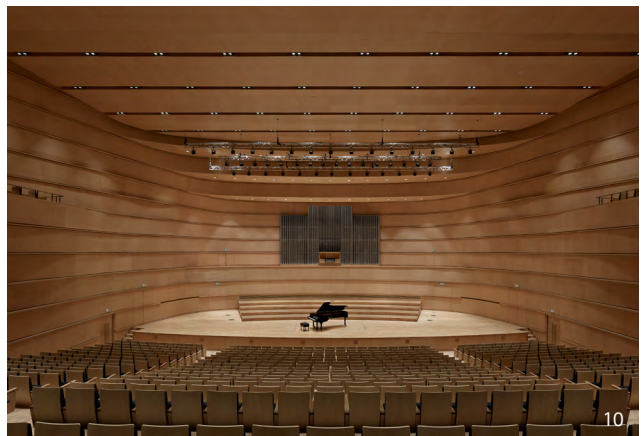
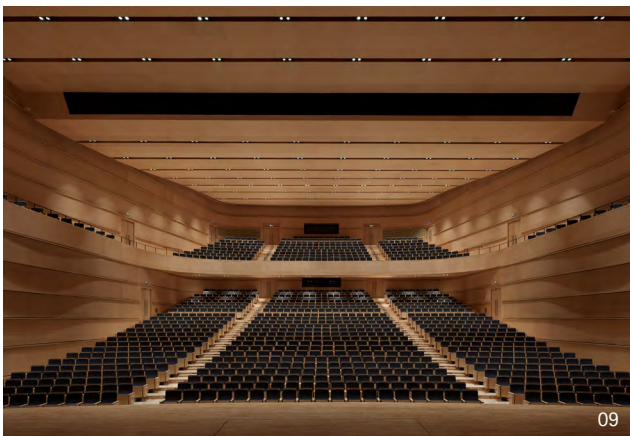
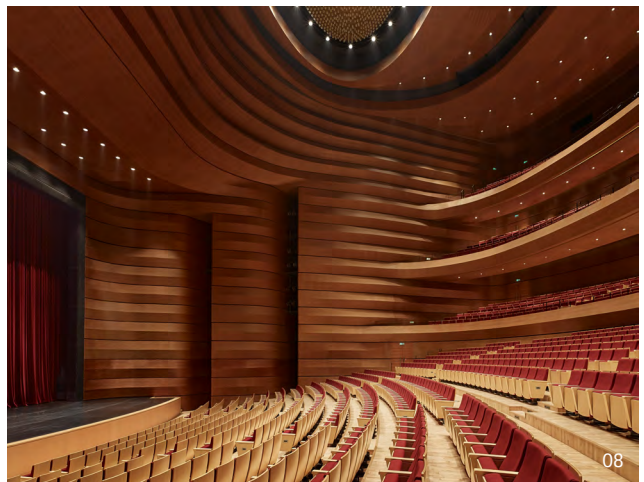
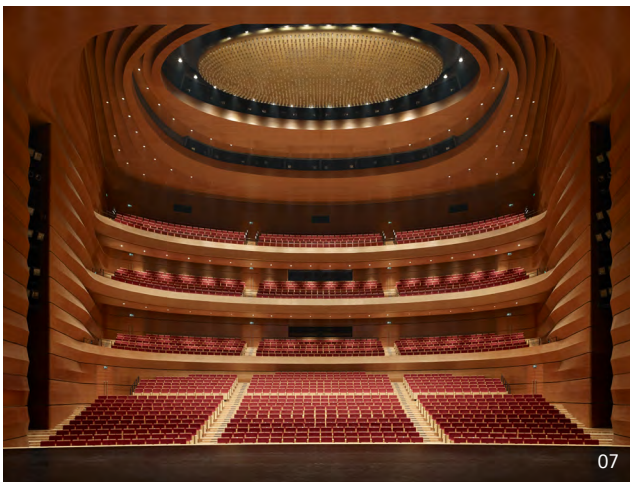

To download high resolution images use the following link: <https://www.gmp-architekten.com/news/press-release/>

Please note the advice for rights of use and copyright on the last page of this document.

05 Southwestern facade at dawn © Christian Gahl
06 Southwestern facade at night © Christian Gahl
07 Interior view of the opera house © Christian Gahl

08 Interior view of the opera house © Christian Gahl
09 Interior view of the concert hall © Christian Gahl
10 Stage of the concert hall © Christian Gahl

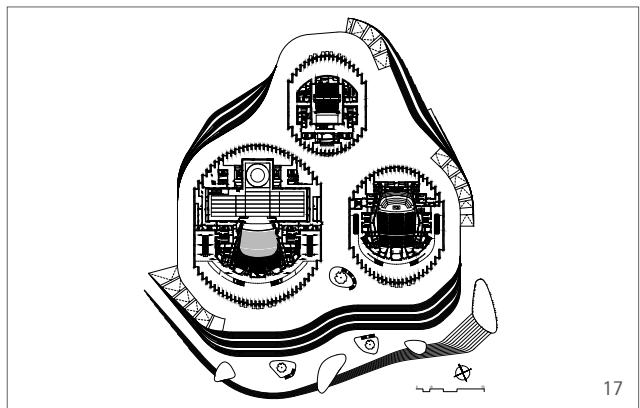
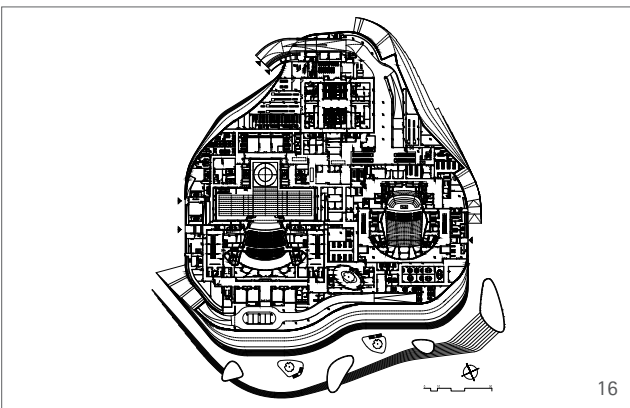
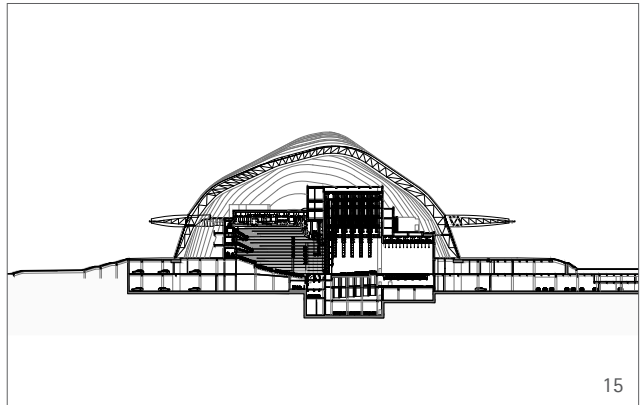
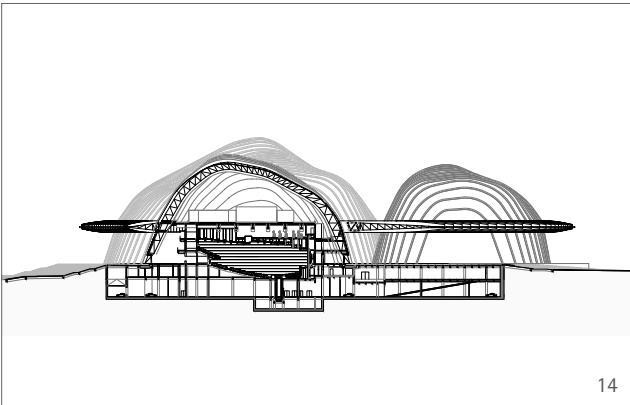
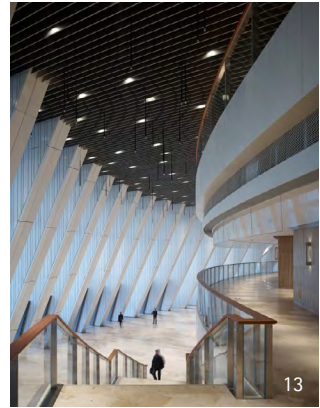
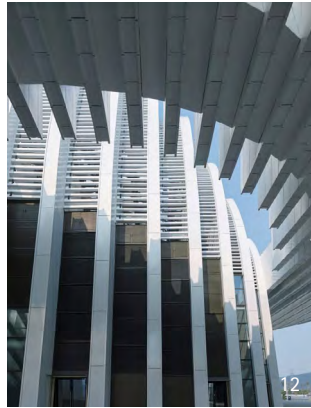

To download high resolution images use the following link: <https://www.gmp-architekten.com/news/press-release/>

Please note the advice for rights of use and copyright on the last page of this document.

11 View from northwest along Yong river © Christian Gahl
12 Facade detailing © Christian Gahl
13 View of the ring corridor © Christian Gahl

14 Section of the opera house © gmp Architects
15 Section of the concert hall © gmp Architects
16 + 17 Floorplan of 1st and 2nd level © gmp Architects

Please note

Free-of-charge publication is only permitted as an editorial contribution on the architecture of architects von Gerkan, Marg and Partners (gmp) in the context of this press release. A complete naming of the authors of the picture and plan material in clear assignment is obligatory.

Should you intend to use the material in any other way, you are obliged to clarify any issues of copyright and right of use directly and independently with the photographers. If you are a product manufacturer, supplier or contractor and are interested in using the image material, please contact us and the photographer.

We kindly ask to send a reference copy to the PR contact as stated.

gmp · von Gerkan, Marg and Partners Architects
PR & Communications
Claudia Tiesler
Elbchaussee 139
22763 Hamburg
Germany
T +49.40.88 151 123
ctiesler@gmp.de
www.gmp.com