



THE BUILDING IS CONSTRUCTED ACCORDING TO THE PARAMETERS SET AS WINNER OF A TENDER OFFER IN 2012 FOR THE BUS STATION AND MUNICIPAL LIBRARY IN RONDA (MALAGA). THE MUNICIPAL LIBRARY IT IS THE FIRST PHASE OF DEVELOPMENT.

ALL THESE CONDITIONS GIVE WAY TO ONE OF THE KEY ELEMENTS OF THE PROJECT: THE FORESHORTENED PERSPECTIVE. ALL THE VISUAL RECOGNITION FEATURES ARE CREATED BY TORN VISUALS FROM THE VIAL DE RONDA OR FROM THE POTENTIAL MAIN WALK LINKED TO THE RAIL WAY. IT IS DECIDED THAT STRUCTURE WILL FUNCTION AS A SINGLE UNIT FORMED BY RIBS THAT PROVIDE THE IMAGE TO THE BUILDING ESTABLISHING THE DIALOG OF ITS MEETINGS WITH THE CORNERS.

THE STRUCTURE ALLOWS FOR THIS VISUAL GAME WITH TWO DIFFERENT SCALES. IN THE DISTANCE, THE FORESHORTENED PERSPECTIVE BRINGS THE CONCEPT OF A SOLID AND BLIND GROUP, ALLOWING TO DISSEMINATE AT A SHORT DISTANCE, APPRECIATING THE TRANSPARENCY BETWEEN THE RIBS.

THIS CONCEPT IS ESTABLISHED IN THE ENTIRE PROJECT WITH THE REST OF THE CONSTRUCTION ITEMS. THE ELEMENT OF THE SOUTH FACADE, DRILLED BY THE GRAFFITI OF THE VICENTE ESPINEL POEMS, A LOCAL WRITER.

THE REDUCED BUDGET DETERMINES THE NEED FOR AN 85% OF PREFABRICATED SOLUTIONS REDUCING THE TIME OF CONSTRUCTION. AS WELL, A UNIQUE TYPOGRAPHIC SYSTEM IS USED FOR ALL THE SIGNALLING, USING THE SAME TEMPLATES AND HENCE REDUCING COSTS.

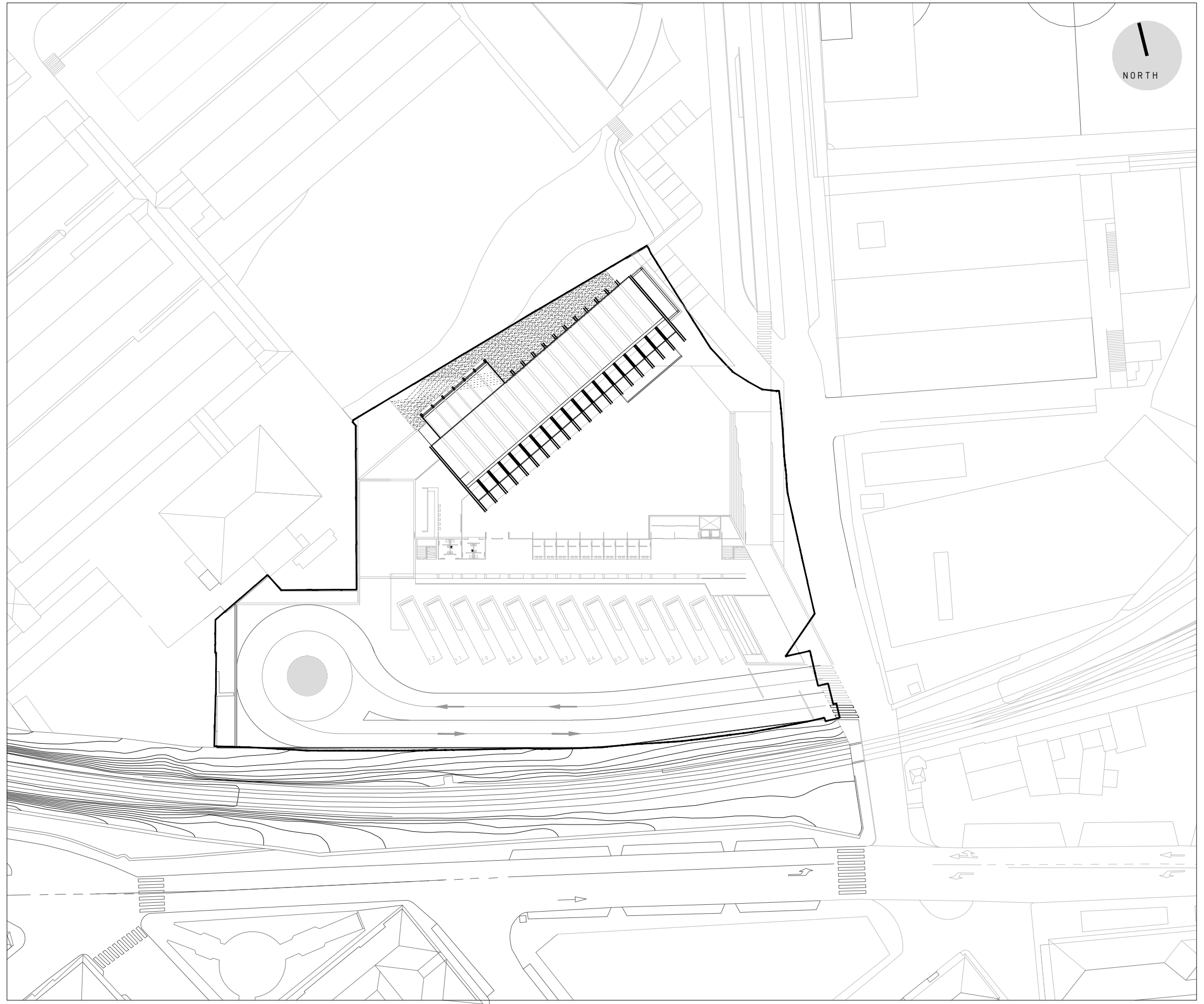
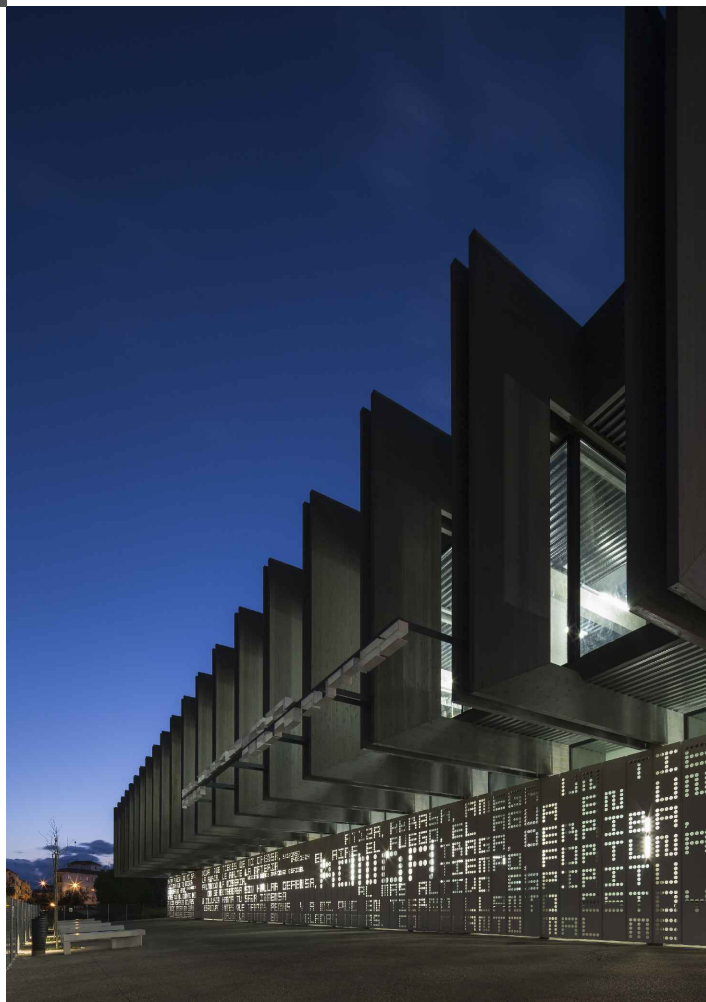

ADOLFO SUAREZ LIBRARY

RONDA (MALAGA)



MMiT ARQUITECTOS