

STAMPEDE BAR & GRILLE



MOJAVE, CALIFORNIA

BRITTANY BOGEMA • SPRING 2015 • LIGHTING FINAL



MAJOVE DESERT, SOUTHERN CALIFORNIA

STAMPEDE BAR & GRILLE WILL BE LOCATED ON
US-14 SOUTH OF MAJOVE AIRPORT IN MAJOVE, CALIFORNIA

THE STAMPEDE BAR & GRILLE WILL BE OPENING IN MAJOVE, CALIFORNIA. THIS BAR IS UNIQUE BECAUSE UNLIKE THE OTHERS ON THE WEST COAST, THIS BAR HAS A DESERT INFLUENCE THROUGHOUT THE SPACE. THE STAMPEDE BAR & GRILLE IS ON US-14 JUST SOUTH OF THE MAJOVE AIRPORT. THERE ARE VERY FEW STOPS ALONG SOUTH US-14, SO THE LOCATION WILL BENEFIT TRAVELERS.

WHEN YOU WALK THROUGH THE BARN ENTRANCE DOOR, YOU WILL SEE WOOD FLOORS AND WALLS, WAGON WHEEL BAR STOOLS AND CHAIRS, AND CACTI ACCENTS AROUND THE ROOM. ALONG THE WALLS YOU WILL FIND BULL SKULLS THAT WILL ALLOW AN LED LIGHT TO ILLUMINATE THE EXTERIOR OF THE ROOM. ABOVE THE BAR YOU WILL NOTICE THE RATTLE SNAKE LED PENDANTS. THESE PENDANTS ARE MADE OF PAINTED GLASS AND HOLD AN 8 WATT LED DIMMABLE LAMP. THE BULL SKULLS ARE MADE FROM METAL AND PAINTED BY A LOCAL ARTIST AND THEY ALSO HAVE AN 8 WATT LED DIMMABLE LAMP TO ILLUMINATE THE BAR AREA. THE STAMPEDE BAR & GRILLE IS PRIVATELY OWNED AND WILL BE OPENING IN JUNE 2015.

RATTLE SNAKE PENDANT



HUNG OVER THE BAR:
8 WATT FROSTED LED
DIMMABLE G25

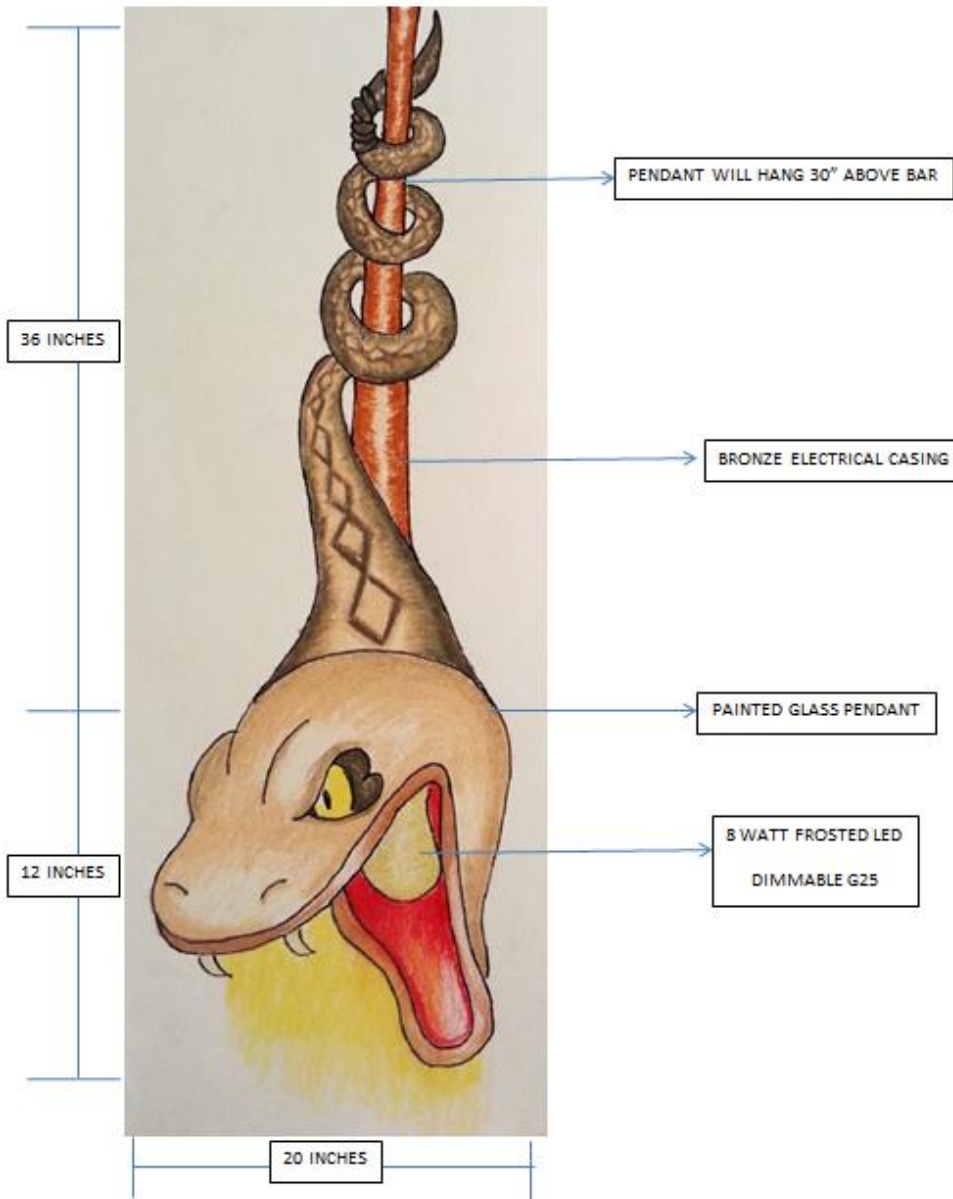

SKULL WALL SCONCE

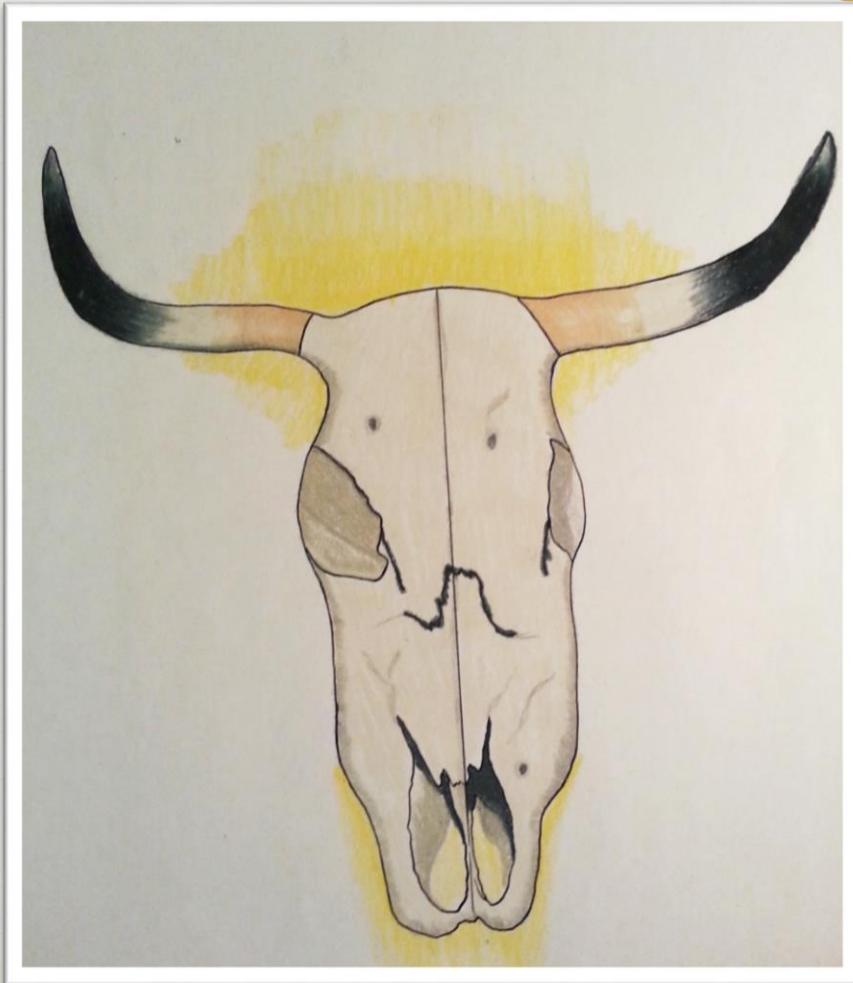

SKULL WALL SCONCE:
8 WATT FROSTED LED
DIMMABLE G25

LIGHTING PLAN

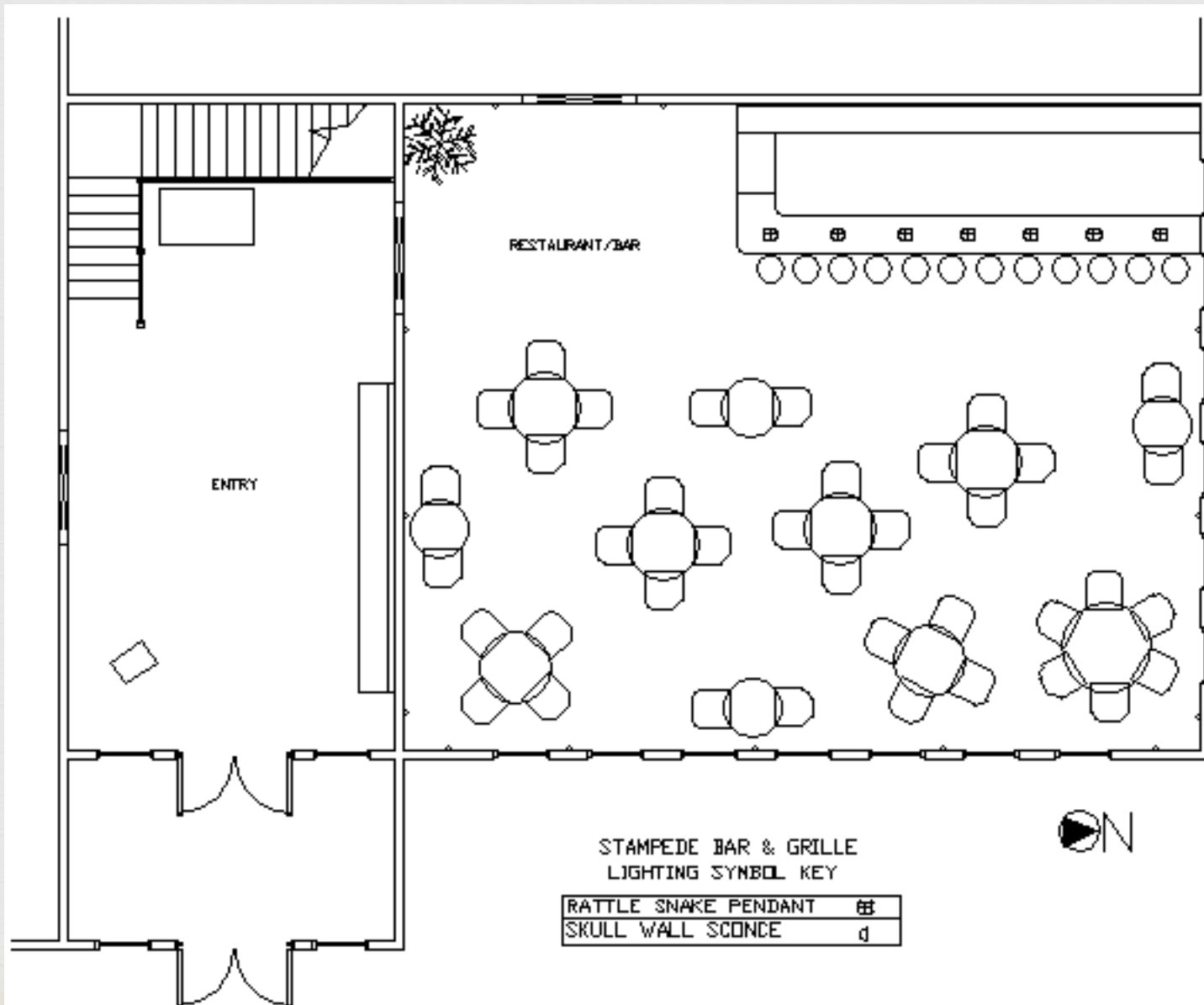

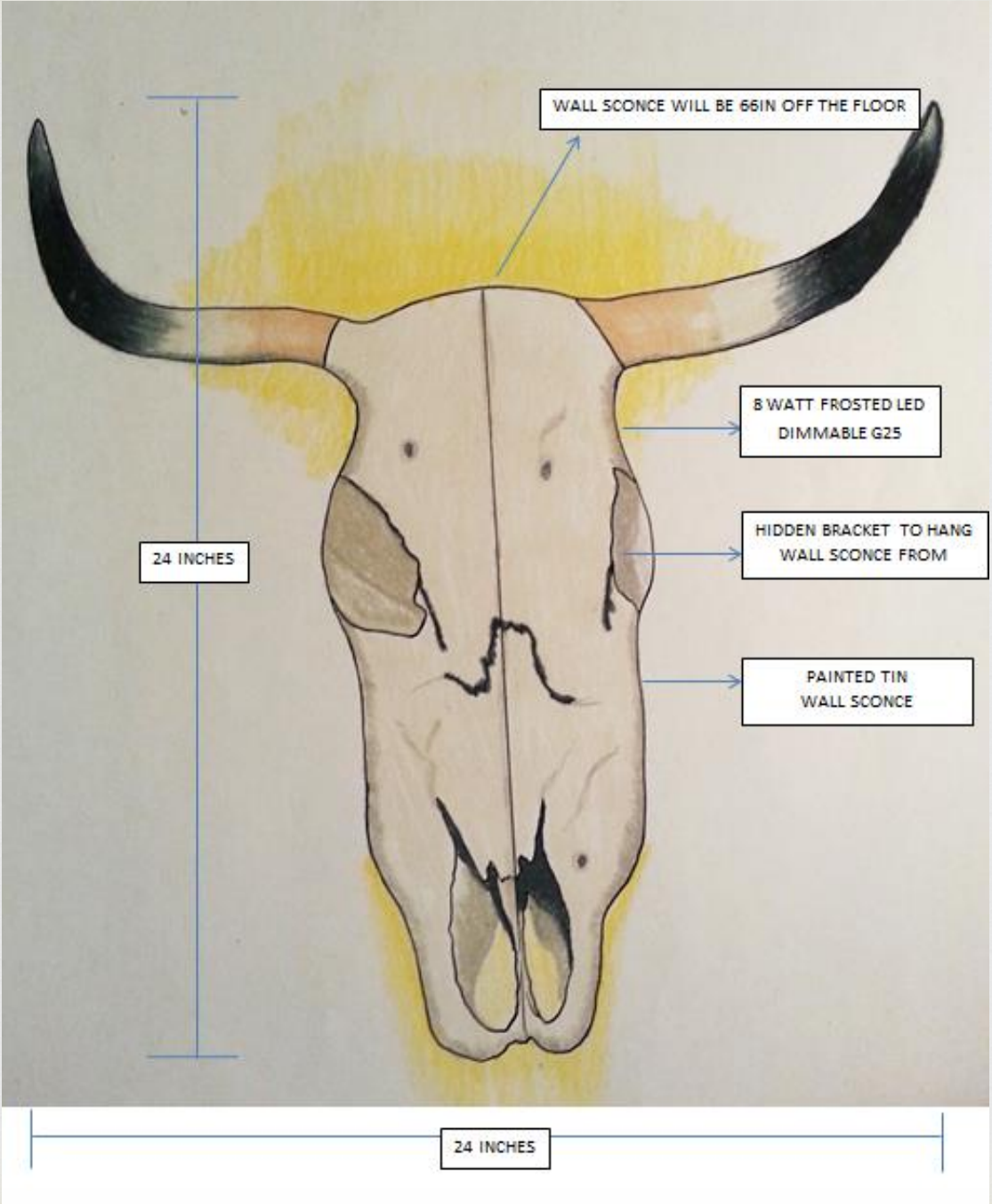

PERSPECTIVE

