

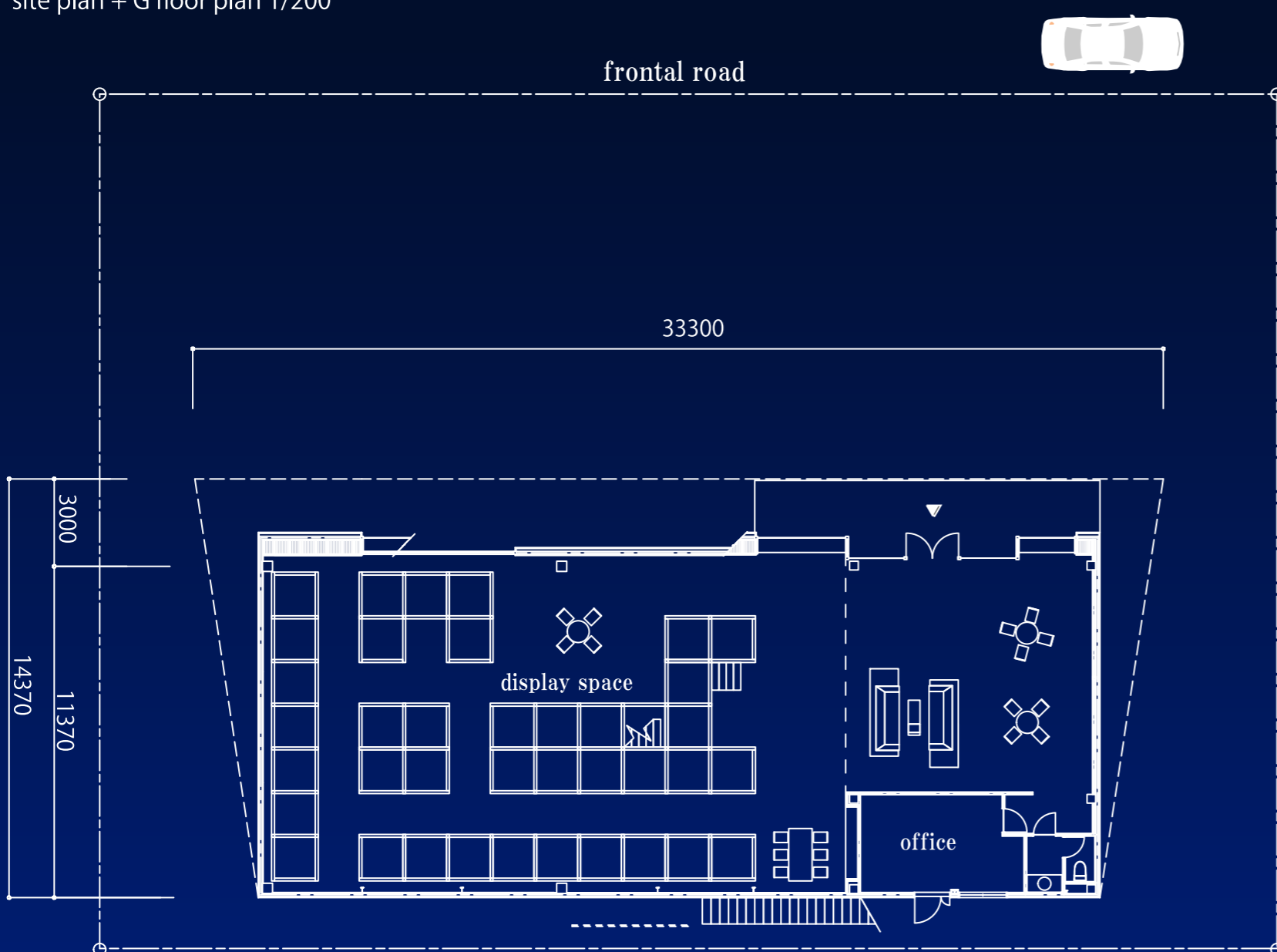

ORIGAMI ark

site plan + G floor plan 1/200



1st floor plan 1/200

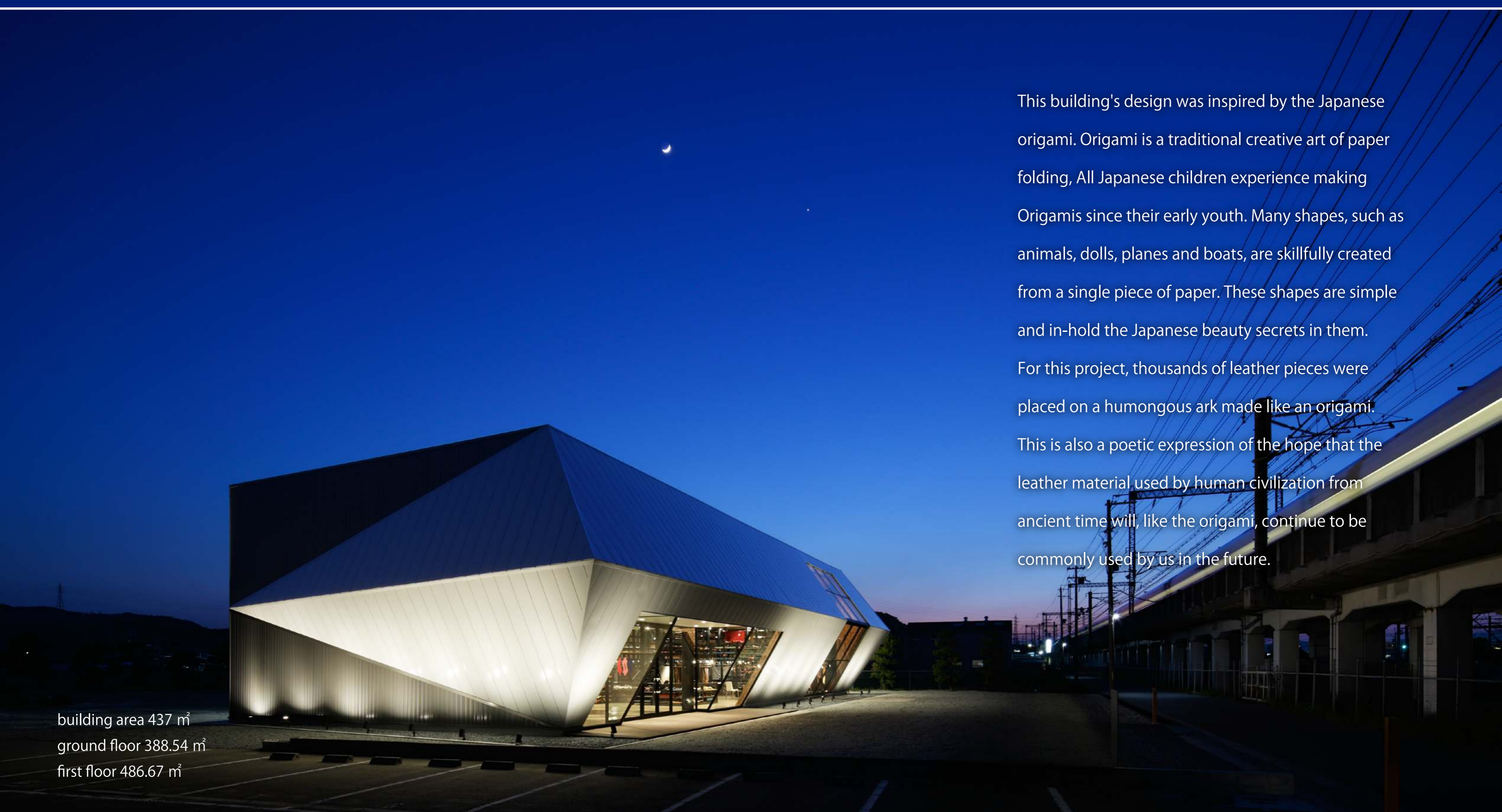
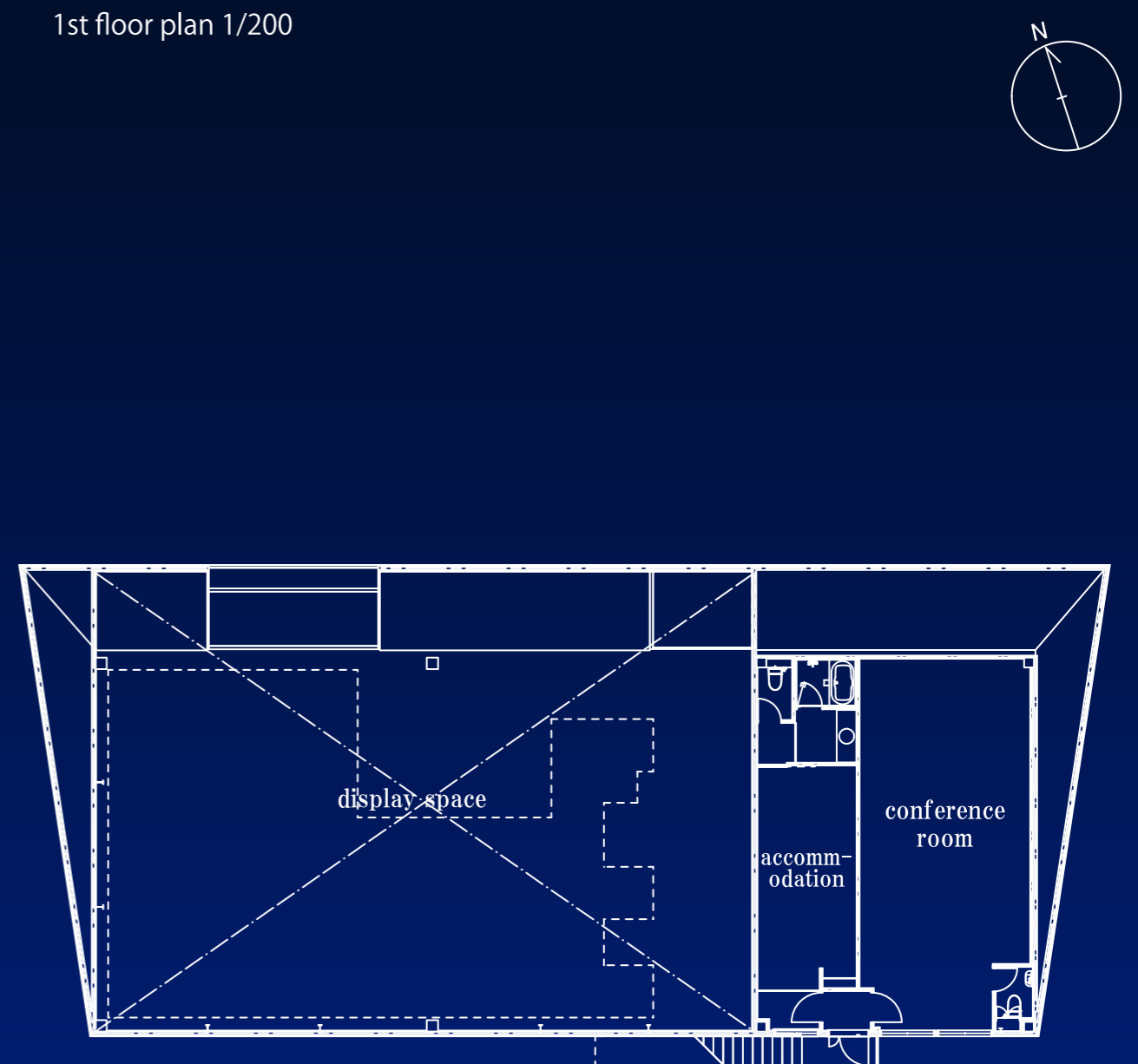

This building's design was inspired by the Japanese origami. Origami is a traditional creative art of paper folding. All Japanese children experience making Origamis since their early youth. Many shapes, such as animals, dolls, planes and boats, are skillfully created from a single piece of paper. These shapes are simple and in-hold the Japanese beauty secrets in them. For this project, thousands of leather pieces were placed on a humongous ark made like an origami. This is also a poetic expression of the hope that the leather material used by human civilization from ancient time will, like the origami, continue to be commonly used by us in the future.

building area 437 m²
 ground floor 388.54 m²
 first floor 486.67 m²